

- 11556( 10778, 12393)
- 11557( 10778, 12393)
- 9015 ( 10778 + 12393 )

- 11460 ( 12717, 12727 )
- 11455 ( 12727, 12717 )

- 11598 ( 12694 • 12693 )
- 11596 ( 12693 • 12694 )
- 8713 ( 11562 )

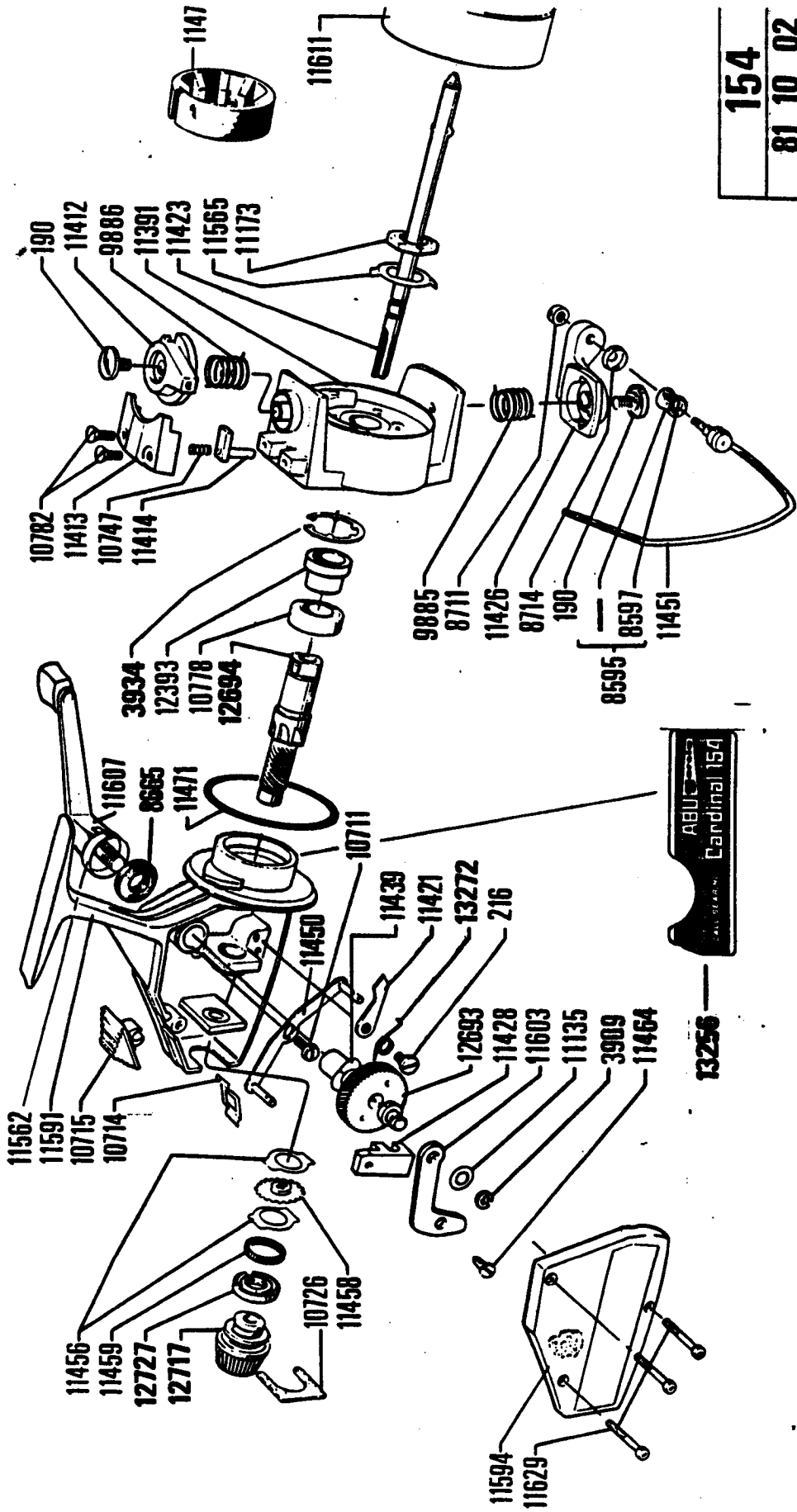

154  
81 10 02