



# AS61 / AS61A / AS62 / AS62A / AS64 / AS64A

## SPECIFICATIONS :

### Line Capacity:

- AS61 - 140 yds / 4 lb
- AS62 - 120 yds / 8 lb
- AS64 - 200 yds / 10 lb

### 5.8:1 Gear Ratio

### Retrieve Rate (IPT):

- AS61 - 25" per turn
- AS62 - 27" per turn
- AS64 - 30" per turn

### Weight:

- AS61 - 10.6 oz.
- AS62 - 10.8 oz.
- AS64 - 13 oz.

### Bearings: 5 BB; 1 RB

## FEATURES :

- Front Drag
- Tru-Balanced Rotor
- Balanced Handle
- Twist Reducer Line Roller
- Selective Continuous A/R
- Worm Gear Oscillation
- Alum. Spool ("A" models have holes in skirt)
- Color: Black

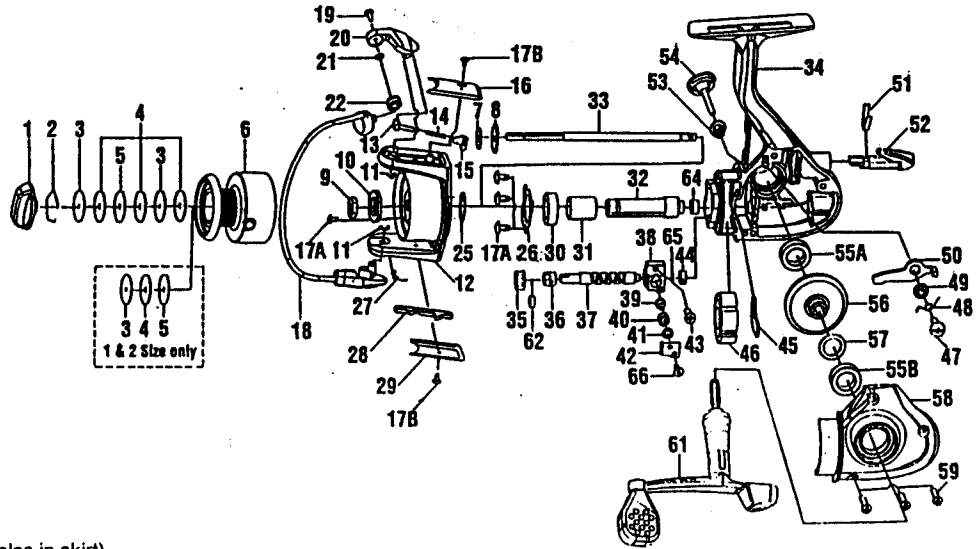

| Key No. | AS61/A   | AS62/A   | AS64/A  | Description         | Price | Key No.  | AS61/A   | AS62/A   | AS64/A  | Description           | Price |
|---------|----------|----------|---|---------------------|-------|----------|----------|----------|---|-----------------------|-------|
| 1       | FH332-04 | ←        | GH332-04  | Drag Knob           | 2.97  | 35       | FH200-01 | ←        | GH200-01  | Level Wind Gear       | 1.70  |
| 2       | AQ038-01 | ←        | ←   | Drag Retainer       | 0.32  | 36       | GH202-01 | ←        | ←   | Wm Shft Bushng (L)    | 0.31  |
| 3       | TU080-01 | ←        | ←   | Drag Washer "D"     | 1.16  | 37       | FH201-01 | ←        | TU201-01  | Worm Shaft            | 2.44  |
| 4       | GH033-01 | ←        | ←   | Drag Washer "B"     | 2.68  | 38△      | ZQ204-01 | ←        | GH204-01  | Pawl Holder           | 3.25  |
| 5       | TU081-01 | ←        | ←   | Drag Washer "A"     | 1.18  | 39       | TU207-01 | ←        | ←   | Pawl                  | 2.71  |
| 6       | ZQ321-05 | FH321-05 | GH321-05  | Spool Asy.          | 7.21  | 40       | UQ208-03 | ←        | ←   | Pawl Collar           | 0.32  |
| 6▽      | ZQ321-10 | FH321-10 | GH321-11  | Spool Asy. w/ holes | 7.21  | 41△      | RU209-01 | ←        | ←   | Pawl Washer           | 0.31  |
| 7       | TU030-01 | ←        | ←   | Click Gear Washer   | 0.96  | 42△      | FH205-01 | ←        | ←   | Pawl Holder Retainer  | 1.18  |
| 8       | TU037-01 | ←        | ←   | Click Gear Washer   | 1.22  | 43       | UQ100-03 | ←        | ←   | Main Shaft Screw      | 0.41  |
| 9       | RU006-01 | ←        | ←   | Rotor Nut           | 0.93  | 44       | GH203-01 | ←        | ←   | Wm Shft Bushng (Rt.)  | 0.32  |
| 10      | TL065-01 | ←        | ←   | Rotor "D" Washer    | 1.16  | 45       | TU206-01 | ←        | ←   | Worm Shaft Retainer   | 1.60  |
| 11      | GH034-01 | ←        | ←   | E-Clip              | 0.32  | ▲46      | GH074-01 | ←        | ←   | Clutch Bearing        | 11.03 |
| 12      | ZQ009-05 | FH009-05 | GH009-05  | Rotor               | 7.85  | 46       | RU074-01 | →→→      | Use GH074-01 (clutch bearing) & TU052-01 (bearing sleeve) |                       |       |
| 13      | QL031-01 | ←        | ←   | Bail Spring Shaft   | 0.27  | 47       | GH077-01 | ←        | ←   | A/R Pawl Screw        | 0.32  |
| 14      | KQ049-05 | ←        | ←   | Bail Spring         | 0.32  | 48       | TU061-01 | ←        | ←   | A/R Pawl Spring       | 0.32  |
| 15      | QL020-01 | ←        | ←   | Bail Spring Holder  | 0.32  | 49       | TU091-01 | ←        | ←   | A/R Pawl Post         | 1.16  |
| 16      | ZQ087-05 | FH087-05 | GH087-05  | Arm Lvr Spring Cvr  | 2.67  | 50       | RU063-01 | ←        | ←   | A/R Pawl              | 1.22  |
| 17      | UQ057-01 | ←        | ←   | Screw               | 0.32  | 51       | GH089-01 | ←        | ←   | A/R Lever Spring      | 1.22  |
| 18      | ZQ347-05 | FH347-05 | GH347-05  | Bail Assy.          | 3.92  | 52       | GH090-01 | ←        | ←   | A/R Lever             | 2.58  |
| 19      | AQ108-01 | ←        | ←   | Line Slider Screw   | 0.31  | 52▽      | ZQ090-01 | ←        | ←   | A/R Lever             | 2.58  |
| 20      | ZQ007-05 | ←        | GH007-05  | Arm Lever           | 2.39  | 53       | RU105-01 | ←        | ←   | Handle Cap Washer     | 0.50  |
| 21      | GU105-25 | ←        | ←   | Line Roller Washer  | 0.32  | 54       | ZQ073-01 | ←        | ←   | Handle Cap Screw      | 1.75  |
| 22      | TU004-02 | ←        | ←   | L/Roller w/Bearing  | 6.90  | 55A      | BL157-01 | ←        | N/A   | Ball Bearing (Body)   | 5.57  |
| 25      | GU105-12 | ←        | ←   | Rotor Washer        | 0.32  | 55B      | BL157-01 | ←        | ←   | B. Bearing (Body Cvr) | 5.57  |
| 26      | N/A      | N/A      | TU040-02  | Bearing Plate       | 1.10  | 56       | FH012-01 | ←        | GH012-01  | Drive Gear            | 1.11  |
| 27      | GH049-01 | ←        | ←   | Kick Lever Spring   | 0.32  | 57       | GU105-13 | ←        | ←   | Adjust Washer         | 0.66  |
| 28      | ZQ019-01 | ←        | TU019-01  | Kick Lever          | 1.11  | 58       | FH023-10 | FH023-09 | GH023-05  | Side Cover            | 5.41  |
| 29      | ZQ024-05 | FH024-05 | GH024-05  | Kick Lever Cover    | 2.76  | 58▽      | ZQ023-07 | ←        | UU023-04  | Side Cover            | 5.41  |
| 30      | BL157-01 | ←        | UK028-01  | Pinion Ball Bearing | 5.57  | 59       | KQ057-01 | ←        | ←   | Side Cover Screws     | 0.32  |
| ▲31     | TU052-01 | ←        | ←   | Bearing Sleeve      | 2.76  | 61       | FH318-04 | ←        | GH318-02  | Handle Asy.           | 11.77 |
| 31      | RU139-01 | →→→      | Use TU052-01 (bearing sleeve) & GH074-01 (clutch bearing) |                     | 61▽   | ZQ318-03 | ←        | UU318-03 | Handle Asy.   | 11.77                 |       |
| 32      | FH011-01 | ←        | GH011-01  | Pinion Gear         | 3.55  | 62       | GH212-01 | ←        | ←   | Worm Shaft Collar     | 1.16  |
| 33      | FH015-01 | ←        | TU015-01  | Main Shaft          | 2.60  | 64▽      | RU141-01 | ←        | ←   | Pinion Bushing        | 1.60  |
| 34      | FH301-10 | FH301-09 | GH301-05  | Body Assy.          | 13.74 | 65▽      | GU105-31 | ←        | ←   | Worm Shaft Washer     | 0.32  |
| 34▽     | ZQ001-07 | ←        | UU001-04  | Body Assy.          | 13.74 | 66▽      | GH123-01 | ←        | ←   | Plate Screw           | 0.93  |

▽ = Special parts for AS6xA models.

△ = Send Key No.'s 38, 41, 42, and 66 if any of these are ordered.

□ = Send Key No.'s 53, 54, and 61 if either part is ordered.

▲ = Both parts must be shipped together if either one is ordered.

|                    |      |                                       |           |                |     |
|--------------------|------|---------------------------------------|-----------|----------------|-----|
| MODEL INTRODUCED : | 1998 | EFFECTIVE DATE OF PARTS LIST/DIAGRAM: | Sept. '98 | DISCONTINUED : | N/A |
|--------------------|------|---------------------------------------|-----------|----------------|-----|

Prices subject to change without notice. Prices do not include postage and handling.

PLEASE ORDER BY PART NUMBER Zebco, P.O. Box 270, Tulsa, Ok. 74101; 918-831-6965 Phone or 800-FIXREEL (349-7335) FAX

