

SPINCASTING REEL **Goldcast 312RL**

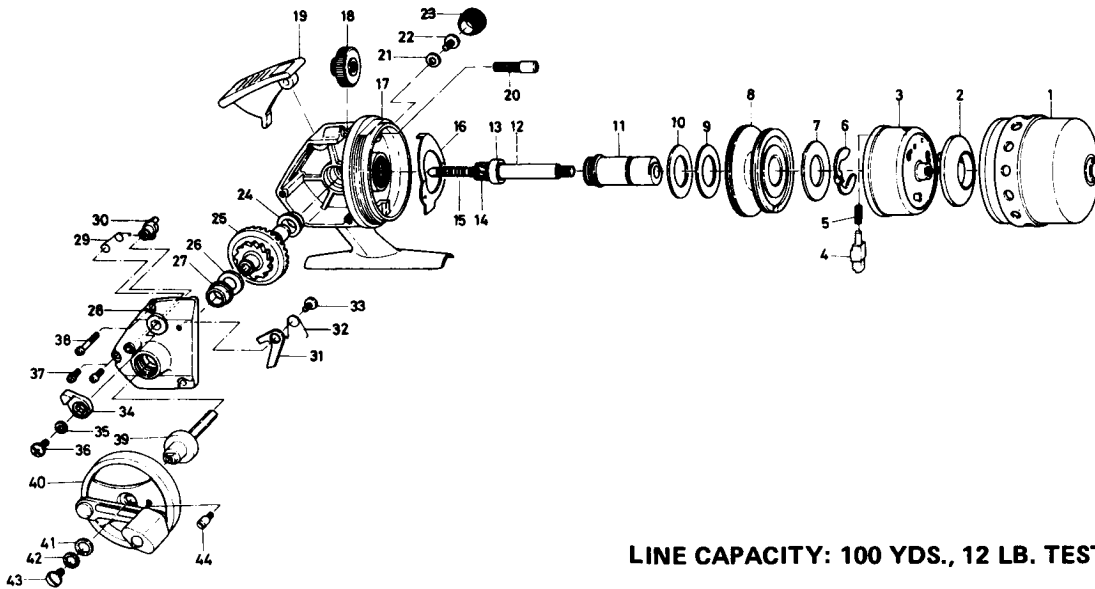

LINE CAPACITY: 100 YDS., 12 LB. TEST (90m 5.5kg)

Key No. 2 ~ 5			
6-736-6001	Rotor assembly		\$4.25
Key No. 12 ~ 15			
6-711-1901	Main shaft assembly		6.50

Key No.	Parts No.	Parts Name	Price Per Piece
1	6-755-1402	Front cover	\$4.40
2	6-330-4301	Line stopper	N/A
3	6-736-6101	Rotor	N/A
4	6-180-2612	Pick up pin	.50
5	6-142-4501	Pick up pin spring	.10
6	6-320-9101	Spool retainer	.40
7	6-370-0412	Spool washer	.10
8	6-732-2942	Spool	2.75
9	6-375-6501	Spool washer A	.20
10	6-375-6401	Spool washer B	.20
11	6-381-7731	Shaft metal	1.35
12	6-393-4201	Main shaft	N/A
13	6-633-8811	Ball bearing	5.30
14	6-402-6701	Pinion gear	.75
15	6-142-7711	Main shaft spring	.10
16	6-151-6731	Drag adjusting plate	.40
17	6-700-9101	Body	5.25
18	6-636-5601	Drag adjusting dial	.70
19	6-781-6504	Push button	1.00
20	6-363-5911	Drag adjusting screw	.20
21	6-372-4601	Handle washer A	.10
22	6-362-1001	Handle screw A	.25

Key No.	Parts No.	Parts Name	Price Per Piece
23	6-363-6001	Handle screw cap	\$.55
24	6-636-4101	Drive gear shaft holder	.40
25	6-413-5501	Drive gear	.90
26	6-370-5150	Drive gear washer	.10
27	6-636-4101	Drive gear shaft holder	.40
28	6-706-4301	Body cover	2.00
29	6-144-5001	Anti-reverse cam spring	.15
30	6-461-4501	Anti-reverse cam	.25
31	6-111-7001	Anti-reverse claw	.15
32	6-144-5111	Anti-reverse claw spring	.15
33	6-350-1931	Anti-reverse claw screw	.10
34	6-541-4511	Anti-reverse lever	.40
35	6-160-3111	Anti-reverse lever washer	.10
36	6-350-1931	Anti-reverse lever screw	.10
37	6-351-1101	Body cover screw (short)	.10
38	6-353-4911	Body cover screw (long)	.10
39	6-071-0502	Drive gear shaft	1.85
40	6-746-6001	Handle	5.30
41	6-375-2501	Handle washer B	.15
42	6-160-8001	Handle washer C	.10
43	6-352-1101	Handle screw B	.25
44	6-363-6201	Handle arm stopper screw	.20