

SPINNING REEL 4300A

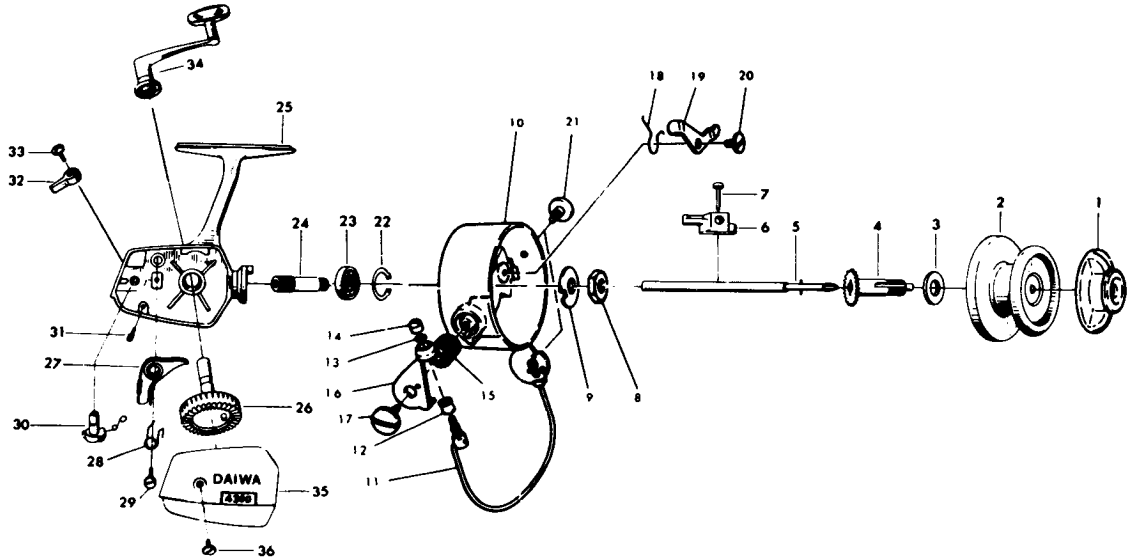

LINE CAPACITY: 250 YDS., 10 LB. TEST (230m. 4.5kg)

Key No.	Parts No.	Parts Name	Price Per Piece	Key No.	Parts No.	Parts Name	Price Per Piece
1	6-007-8414	Drag knob	\$1.90	19	6-570-5321	Bail kick lever	\$.35
2	6-008-6831	Spool assembly	N/A	20	6-361-1511	Bail kick lever screw	.25
3	6-373-1501	Spool washer	8.30	21	6-351-6401	Bail holder screw	.10
4	6-007-8561	Spool metal	1.20	22	6-320-2901	Ball bearing ret. ring	.25
5	6-002-8072	Main shaft	1.50	23	6-631-6901	Ball bearing	2.80
6	6-480-5021	Oscillating slider	.40	24	6-401-4011	Pinion	2.05
7	6-120-8711	Oscillating slider pin	.20	25	6-191-6621	Body	7.10
8	6-340-6601	Rotor nut	.25	26	6-411-7311	Drive gear	2.05
9	6-371-3111	Rotor retaining washer	.20	27	6-110-7511	Anti-reverse claw	.25
10	6-201-0841	Rotor	5.10	28	6-142-5501	Anti-reverse claw spring	.20
11	6-007-6201	Bail	2.25	29	6-352-9501	Anti-reverse claw screw	.10
12	6-250-1901	Line roller	.30	30	6-002-7421	Anti-reverse cam	.40
13	6-160-0121	Bail washer	.10	31	6-351-6101	Anti-reverse cam screw	.10
14	6-341-0801	Bail nut	.20	32	6-540-2221	Anti-reverse lever	.30
15	6-140-9221	Bail spring	.15	33	6-350-1931	Anti-reverse lever screw	.10
16	6-230-8301	Arm lever	.50	34	6-008-6711	Handle	4.25
17	6-361-6611	Arm lever screw	.65	35	6-705-7301	Body cover	2.50
18	6-140-6231	Bail kick lever spring	.10	36	6-361-6021	Body cover screw	.20