

SPINNING REEL GS-60

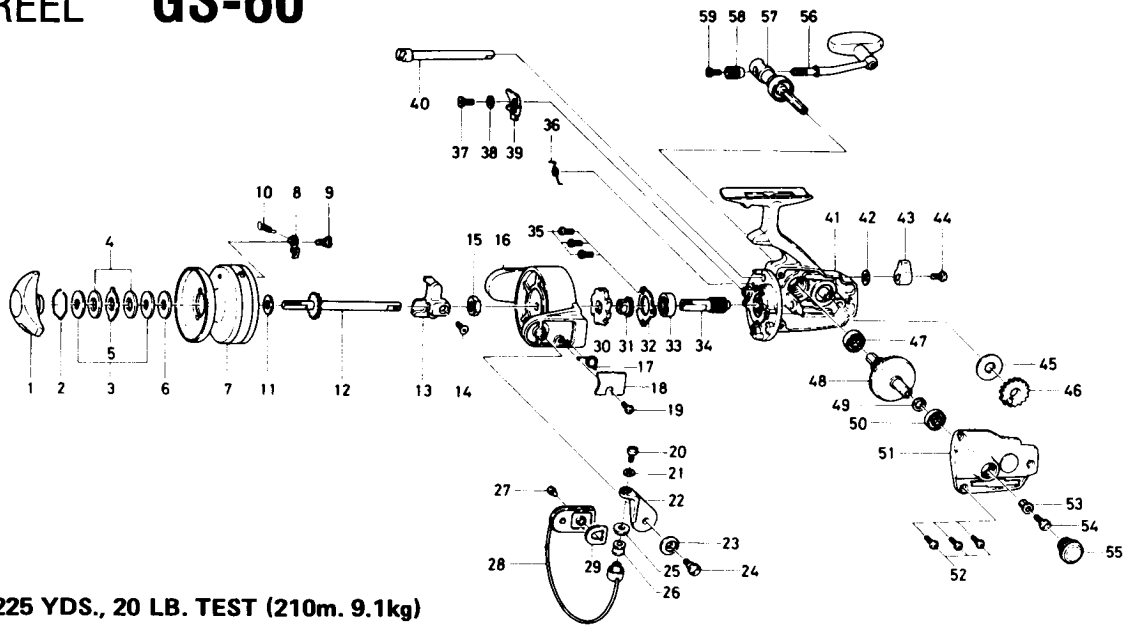

LINE CAPACITY: 225 YDS., 20 LB. TEST (210m. 9.1kg)

| | | | |
|--------------------------|-----------------|--|---------|
| Key No. 2 ~ 10 | | | |
| 6-733-1401 | Spool assembly | | \$17.35 |
| Key No. 56 ~ 59 | | | |
| 6-747-2001 | Handle assembly | | 6.00 |
| Special part for GS-60SC | | | |
| 6-280-7111 | Ratchet | | .70 |

| Key No. | Parts No. | Parts Name | Price Per Piece |
|---------|------------|--------------------------|-----------------|
| 1 | 6-000-8241 | Drag knob | \$2.15 |
| 2 | 6-170-4511 | Drag washer retainer | .10 |
| 3 | 6-372-7812 | Drag D washer | .15 |
| 4 | 6-372-9011 | Disc washer | .40 |
| 5 | 6-375-5401 | Drag A washer | .15 |
| 6 | 6-372-7701 | Drag washer A | .15 |
| 7 | 6-733-1501 | Spool | N/A |
| 8 | 6-030-6801 | Spool click claw | .25 |
| 9 | 6-363-8401 | Spool click claw screw | .15 |
| 10 | 6-144-1211 | Spool click claw spring | .15 |
| 11 | 6-371-2732 | Spool washer | .10 |
| 12 | 6-711-1311 | Main shaft | 2.55 |
| 13 | 6-481-1011 | Oscillating slider | .60 |
| 14 | 6-351-8901 | Oscillating slider screw | .10 |
| 15 | 6-340-8301 | Rotor nut | .20 |
| 16 | 6-201-7603 | Rotor | 4.50 |
| 17 | 6-144-2201 | Bail spring | .10 |
| 18 | 6-633-0701 | Bail spring cover | .15 |
| 19 | 6-351-1801 | Bail spring cover screw | .10 |
| 20 | 6-363-3111 | Bail screw | .35 |
| 21 | 6-375-1101 | Bail washer | .10 |
| 22 | 6-231-1901 | Arm lever | 1.50 |
| 23 | 6-130-3201 | Bail holder cap | .10 |
| 24 | 6-363-1901 | Arm lever screw | .30 |
| 25 | 6-501-2001 | Roller collar | .25 |
| 26 | 6-250-4311 | Line roller | .30 |
| 27 | 6-351-6401 | Bail holder screw | .10 |
| 28 | 6-725-1216 | Bail | 2.30 |
| 29 | 6-210-3501 | Balancer | .35 |
| 30 | 6-280-5401 | Ratchet | .70 |

| Key No. | Parts No. | Parts Name | Price Per Piece |
|---------|------------|--------------------------------|-----------------|
| 31 | 6-270-7111 | Click gear | \$.40 |
| 32 | 6-050-5101 | Ball bearing ret. washer | .25 |
| 33 | 6-635-5001 | Ball bearing | 4.25 |
| 34 | 6-402-3101 | Pinion gear | 1.90 |
| 35 | 6-351-6601 | Ball bearing ret. washer screw | .10 |
| 36 | 6-144-0301 | Anti-reverse cam spring | .15 |
| 37 | 6-363-3601 | Anti-reverse claw screw | .25 |
| 38 | 6-375-5200 | Anti-reverse claw washer | .15 |
| 39 | 6-770-0931 | Anti-reverse claw | 1.00 |
| 40 | 6-461-5102 | Anti-reverse cam | 1.20 |
| 41 | 6-701-1101 | Body | 9.10 |
| 42 | 6-373-2700 | Anti-reverse lever washer | .10 |
| 43 | 6-541-6101 | Anti-reverse lever | 1.30 |
| 44 | 6-352-2501 | Anti-reverse lever screw | .10 |
| 45 | 6-374-5400 | Oscillating gear washer | .10 |
| 46 | 6-412-3612 | Oscillating gear | .40 |
| 47 | 6-636-6011 | Ball bearing | 3.65 |
| 48 | 6-412-3502 | Drive gear | 2.05 |
| 49 | 6-371-2820 | Drive gear washer | .10 |
| 50 | 6-636-6011 | Ball bearing | 3.65 |
| 51 | 6-706-7801 | Body cover | 3.85 |
| 52 | 6-351-6401 | Body cover screw | .10 |
| 53 | 6-501-8401 | Handle screw holder | .50 |
| 54 | 6-363-8601 | Handle screw | .20 |
| 55 | 6-363-4702 | Handle screw cap | .50 |
| 56 | 6-747-2401 | Handle arm | 4.40 |
| 57 | 6-747-2501 | Handle stand | 1.75 |
| 58 | 6-342-3101 | Handle arm ret. nut | .70 |
| 59 | 6-353-9101 | Handle arm ret. nut screw | .15 |