

SPINNING REEL — PS705BL

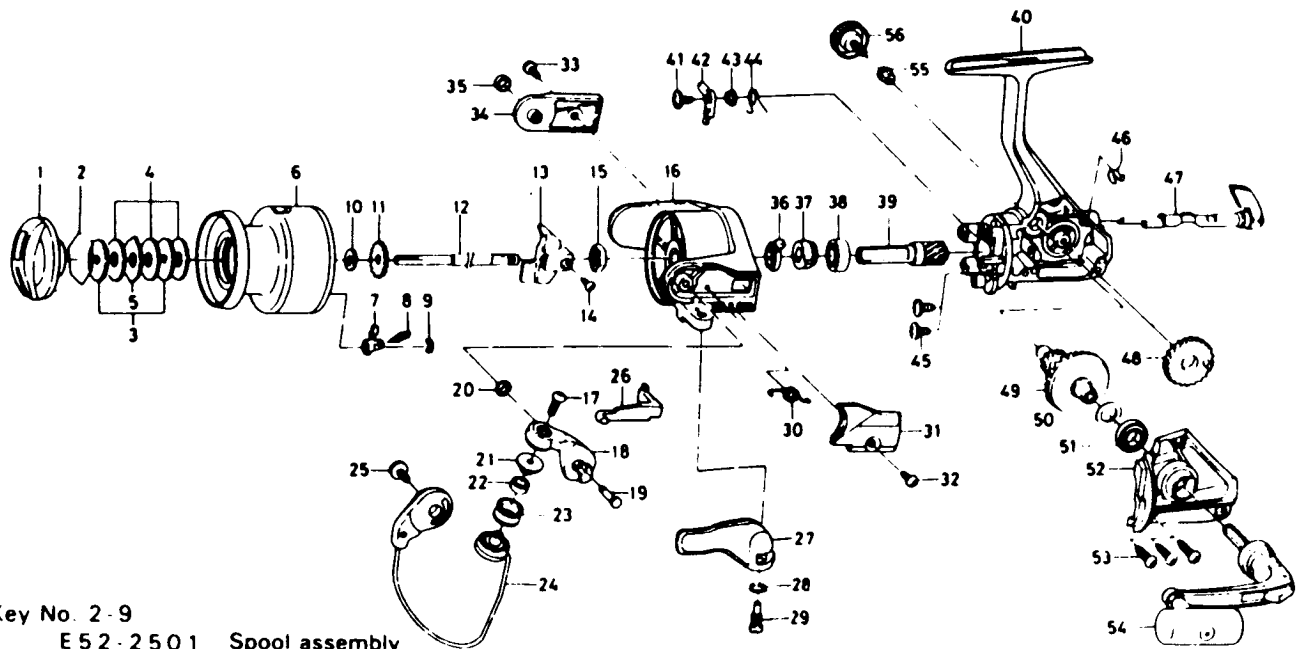

Key No.	Parts No.	Parts Name	Key No.	Parts No.	Parts Name
1	F 19-9101	Drag knob	29	E 37-0001	Trigger screw
2	171-7701	Drag washer retainer	30	E 49-6801	Bail spring
3	E 46-7201	Key washer	31	E 49-6301	Bail spring cover
4	E 13-6001	Drag washer	32	E 36-4201	Bail spring cover screw
5	373-3603	Eared washer	33	L 01-1701	Bail trip cover screw
6	E 52-2601	Spool assembly	34	F 17-2901	Bail trip cover
7	B 07-5304	Click pawl	35	F 17-3001	Bail trip collar
8	E 40-3101	Click spring	36	F 12-2101	Anti-reverse pawl spring A
9	320-5901	Click retainer	37	E 49-8501	Anti-reverse ratchet
10	L 02-5001	Spool washer	38	634-1301	Ball bearing B
11	270-6501	Click gear	39	F 12-1601	Pinion gear
12	E 49-8401	Main shaft	40	F 17-2202	Body assembly
13	F 12-2301	Oscillating slider	41	F 12-5701	Anti-reverse pawl screw
14	351-0311	Oscillating block screw	42	F 12-1901	Anti-reverse pawl
15	341-9201	Rotor nut	43	F 12-3501	Anti-reverse pawl collar
16	E 50-0905	Rotor	44	F 12-3401	Anti-reverse pawl spring B
17	B 67-9305	Line roller screw	45	E 03-7801	Bearing retainer screw
18	F 17-3101	Bail arm	46	F 12-2001	Anti-reverse cam spring
19	E 49-3501	Bail arm screw	47	F 08-5117	Anti-reverse lever
20	320-5901	Bail arm screw retainer	48	F 12-2201	Oscillating gear
21	F 06-6301	Line roller collar	49	F 12-1501	Drive gear
22	F 05-5601	Ball bearing A	50	375-8500	Drive gear washer
23	F 05-8901	Line roller	51	634-1301	Ball bearing C
24	F 17-3201	Bail assembly	52	F 16-2106	Side cover
25	353-8208	Bail trip cam screw	53	E 15-8601	Side cover screw
26	E 49-5401	Bail trip lever	54	E 52-2701	Handle assembly
27	E 49-3403	Trigger lever	55	501-8501	Handle collar
28	E 36-9901	Trigger spring	56	B 92-5005	Handle lock screw