

# SPINNING REEL REGAL-S2550B/2553B

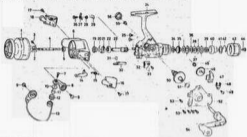

Key No.	Parts No.	Parts Name
1	6-F35-8701	Spool assembly
2	6-F19-6722	Spool metal
3	6-351-1001	Spool metal screw
4	6-F40-9601	Main shaft
5	6-341-6001	Rotor nut
6	6-F32-0404	Rotor
7	6-367-8204	Line roller screw
8	6-F39-4901	Bail arm
9	6-366-2102	Bail arm screw
10	6-F06-6301	Line roller collar
11	6-330-1302	Line roller bushing
12	6-330-6002	Line roller
13	6-F31-6402	Bail assembly
14	6-645-1601	Bail trip lever
15	6-F12-8901	Bail spring
16	6-F31-0201	Bail spring cover
17	6-326-4202	Bail spring cover screw
18	6-F31-0401	Bail trip cover
19	6-F31-1101	Anti-reverse ratchet
20	6-F19-6301	Anti-reverse pawl spring A
21	6-F19-6201	Spring holder
22	6-L03-6601	Ball bearing
23	6-655-8801	Pinion gear
24	6-F19-7406	Body assembly
25	6-620-7301	Bearing retainer screw
26	6-L06-1801	Anti-reverse pawl screw
27	6-F19-5301	Anti-reverse pawl
28	6-L01-4302	Anti-reverse pawl collar
29	6-L06-1101	Anti-reverse pawl spring B
30	6-F19-5101	Anti-reverse cam
31	6-F19-5201	Anti-reverse cam spring
32	6-F19-4902	Anti-reverse lever
33	6-364-8901	Anti-reverse lever screw
34	6-346-8902	Drag washer A
35	6-593-3404	Click gear
36	6-L10-9601	Drag washer B
37	6-L10-9701	Eared washer
38	6-L10-9801	Key washer
39	6-F09-2701	Drag coil spring
40	6-F19-5901	Drag collar
41	6-L11-0001	Drag collar washer
42	6-L08-9601	Drag washer spring
43	6-F32-6201	Drag knob
44	6-620-7602	Drag knob screw
45	6-F29-8401	Oscillating gear collar
46	6-645-1302	Oscillating gear
47	6-F19-5401	Oscillating slider
48	6-F19-5601	Oscillating slider retainer
49	6-350-8112	Oscillating slider axle
50	6-F17-0001	Drive gear
51	6-373-7800	Drive gear washer
52	6-F19-7004	Side cover
53	6-F19-8902	Side cover screw
54	6-F31-8902	Handle assembly
55	6-F40-4811	Handle collar
56	6-392-5001	Handle lock screw

#### S2550B Special parts

1	6-F35-8301	Spool assembly (Deep spool)
2	6-F32-8901	Spool assembly (Shallow spool)
24	6-F19-7407	Body assembly
52	6-F19-7505	Side cover