

## SS3000

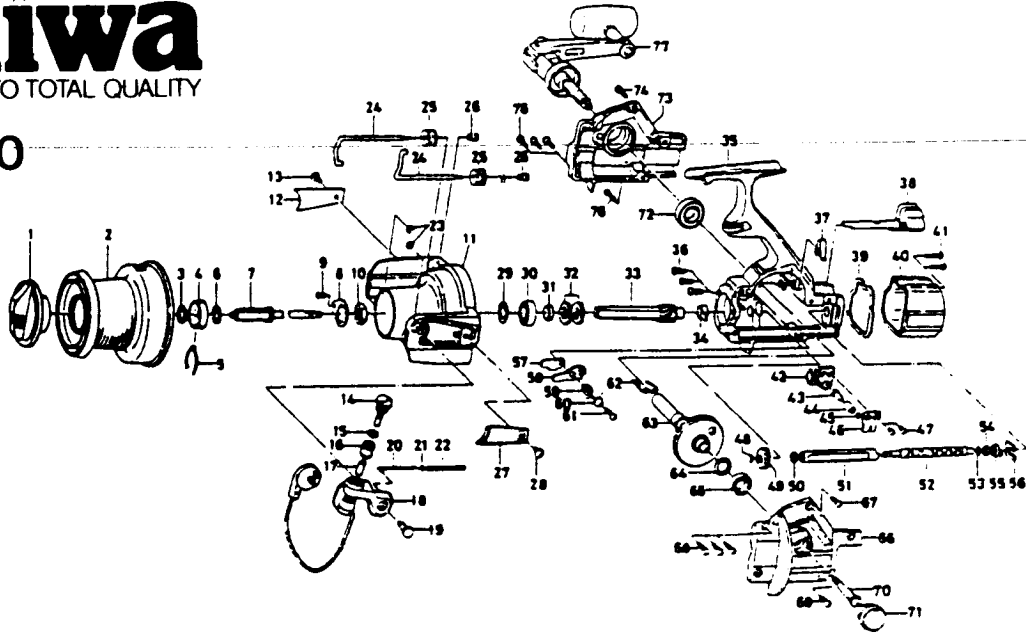

Key No.	Parts No.	Parts Name
1.	E12-6801	Drag knob
2.	E33-5001	Spool assembly
3.	E14-6503	Spool washer
4.	E12-2301	Click leaf spring holder
5.	B74-7701	Spool click leaf spring
6.	371-2800	Main shaft washer
7.	E33-3901	Main shaft assembly
8.	E33-3801	Rotor nut holding plate
9.	351-1003	Rotor nut holding plate screw
10.	B43-7603	Rotor nut
11.	E35-4301	Rotor assembly
12.	E33-3501	Bail trip cover
13.	351-6104	Bail trip cover screw
14.	B21-1305	Line roller screw
15.	375-4301	Lock washer
16.	E33-3601	Line roller
17.	B44-3401	Line roller bushing
18.	E33-3101	Bail
19.	E33-3401	Bail arm screw
20.	E32-6701	Bail spring shaft
21.	E31-3901	Bail spring washer
22.	E26-5601	Bail spring
23.	320-5901	Bail arm screw retainer
24.	E35-5601	Line guard roller shaft
25.	E32-6801	Line guard roller
26.	E26-6901	Roller shaft nut
27.	E33-3501	Bail spring cover
28.	351-6104	Bail spring cover screw
29.	B27-0704	Bearing washer
30.	637-6101	Ball bearing A
31.	E26-2801	Spacing sleeve
32.	E26-2701	Anti-reverse ratchet
33.	E33-2201	Pinion gear
34.	E33-2101	Pinion holder
35.	E33-1404	Body
36.	E03-7801	Bearing retainer screw
37.	E32-7801	Anti-reverse cam spring
38.	E26-2302	Anti-reverse lever
39.	E26-4801	Water shield
40.	E33-4201	Rear cover
41.	E24-8102	Rear cover screw

Key No.	Parts No.	Parts Name
42.	E26-3102	Oscillating slider
43.	E26-4101	Oscillating pawl
44.	E26-4201	Oscillating pawl bush
45.	375-0800	Oscillating pawl washer
46.	E26-4301	Oscillating slider cover
47.	352-1502	Oscillating slider cover screw
48.	320-5901	Worm shaft gear retainer
49.	E26-3401	Worm shaft gear
50.	E33-2501	Ball bearing B
51.	E33-2301	Worm shield cover
52.	E33-2401	Worm shaft
53.	B41-1700	Worm shaft washer
54.	E33-2501	Ball bearing B
55.	E33-2001	Worm shaft collar
56.	E26-3601	Worm shaft retainer
57.	E26-1901	Anti-reverse pawl plate
58.	E26-2001	Anti-reverse pawl
59.	E26-2101	Anti-reverse pawl collar
60.	E26-2201	Anti-reverse pawl spring A
61.	B83-5002	Anti-reverse pawl screw
62.	E26-4501	Anti-reverse pawl spring B
63.	F00-4201	Drive gear
64.	B27-0700	Drive gear washer
65.	637-6101	Ball bearing A
66.	E33-2801	Left side cover
67.	B00-9702	Side cover screw A
68.	B00-9701	Side cover screw B
69.	E15-8601	Side cover screw C
70.	B33-2501	Handle screw
71.	E33-4801	Handle screw cap
72.	637-6101	Ball bearing A
73.	E33-2601	Right side cover
74.	B00-9702	Side cover screw A
75.	B00-9701	Side cover screw B
76.	E15-8601	Side cover screw C
77.	E33-4501	Handle assembly