

# MULTIPLYING REEL SEALINE — SG27LC / 47LC

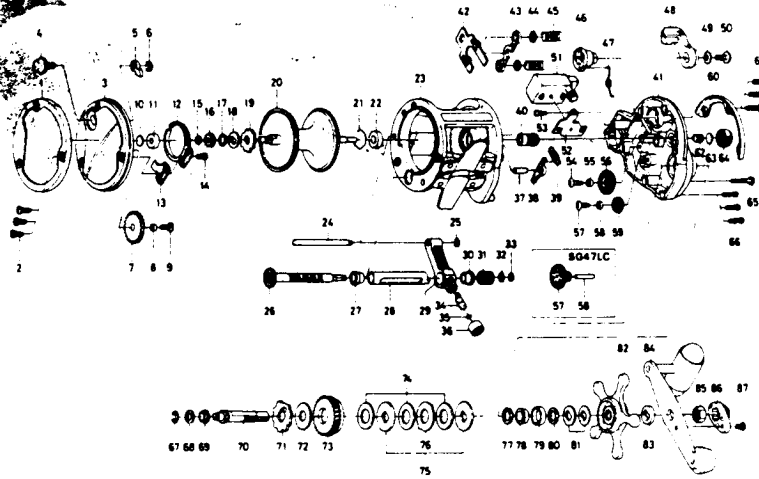

Key No.	Part No.	Part Name	Price	Key No.	Part No.	Part Name	Price	
1	F09-3901	Left side outer ring	8.00	49	160-8001	Clutch lever lock washer	.50	
2	F09-3601	Left side plate screw	.50	50	E00-7602	Clutch lever screw	.55	
3	F09-3701	Left side plate	12.00	51	F09-2101	Counter assembly	8.40	
4	B21-6602	Click button	3.70	52	E24-1801	Counter plate	1.05	
5	030-6612	Click pawl	1.25	53	E15-7502	Counter screw	.45	
6	320-1402	Click pawl retainer	.55	54	E10-7401	Counter gear screw	.45	
7	B21-5801	Idle gear	1.10	55	B65-6201	Counter gear collar	.55	
8	B65-6201	Idle gear collar	.55	56	E24-1901	Counter gear A	1.80	
9	E10-7401	Idle gear screw	.45	57	E10-7401	Counter gear screw	.45	
10	375-7405	Bushing washer	.60	58	B65-6201	Counter gear collar	.55	
11	637-5601	Bushing A	2.00	59	F09-2201	Counter gear B	.80	
12	160-7922	Click spring	2.75	60	F09-3501	Right side outer ring	6.00	
13	B21-5501	Click spring retainer	.95	61	F09-3601	Right side plate screw A	.50	
14	B83-4402	Click spring screw	.50	62	B93-9601	Spool tension spring	.45	
15	320-8002	Spool gear retaining ring	.45	63	357-7405	Spacer A	.60	
16	403-2901	Spool gear	2.30	64	B93-9702	Cast control cap	3.30	
17	E15-4801	Click lever washer	.95	65	B00-9702	Right side plate screw B	.65	
18	E36-1401	Click spring washer	.95	66	E11-9601	Right side plate screw C	.70	
19	B21-6701	Click gear	1.30	67	320-7602	Drive shaft retainer	.70	
15-20	F09-4201	Spool	19.00	68	375-5805	Drive shaft washer A	.45	
21	B27-0501	Bearing retainer	.35	69	E25-2501	Drive shaft bush	1.45	
22	F07-8301	Bushing B	1.90	70	E25-2601	Drive shaft	9.50	
23	F09-2301	Frame assembly	19.50	71	E25-2801	Anti-reverse ratchet	2.75	
24	F09-3001	Stabilizer bar	1.65	72	374-6604	Drive shaft washer B	.45	
25	320-5901	Stabilizer bar retainer	.50	73	F09-3401	Drive gear	16.40	
26	F09-2601	Worm shaft assembly	11.50	74	E32-6501	Drag washer	2.30	
27	E14-4801	Worm bearing	1.65	75	E20-0201	Key washer	1.10	
28	F09-2801	Level wind guard	5.85	76	376-3101	Eared washer	1.15	
29	E36-2401	Line guide assembly	9.90	77	373-7806	Spacer B	.60	
30	E14-4801	Worm bearing	1.65	78	E32-6301	Spacing sleeve	.65	
31	F09-2901	Counter gear	.95	79	E32-6401	Bushing C	1.15	
32	B41-1702	Worm shaft holder washer	.50	80	373-7806	Spacer C	.60	
33	320-5901	Worm shaft retainer	.50	81	E25-3501	Drag spring washer	.80	
34	122-0601	Line guide pawl	3.75	82	E25-3601	Star drag	6.15	
35	375-4101	Line guide washer	.30	83	E25-3901	Spacing sleeve	.95	
36	E35-4101	Pawl cap	1.45	84	F09-4101	Handle assembly	12.00	
37	E25-2301	Anti-reverse pawl pin	.70	85	B86-2101	Handle nut	1.25	
38	B62-6801	Anti-reverse pawl	1.10	86	E44-0001	Handle nut plate	.70	
39	E23-4201	Anti-reverse pawl spring	.95	87	351-1803	Handle nut plate screw	.45	
40	F13-5401	Pinion gear	12.75					
41	F09-1701	Right side plate	11.40	<b>SG47LC Special Parts:</b>				
42	F09-3101	Yoke plate	1.90	3	F09-3702	Left side plate	12.60	
43	E25-9101	Yoke	1.40	15-20	F09-5901	Spool	23.00	
44	E03-7704	Yoke washer	.50	23	F09-5201	Frame assembly	27.95	
45	E33-5301	Yoke spring	.50	24	F09-5801	Stabilizer bar	1.65	
46	F09-2001	Clutch cam	2.25	26	F09-5501	Worm shaft assembly	12.35	
47	E32-2301	Clutch spring	.95	28	F09-5701	Lever wind guard	6.15	
48	E42-6802	Clutch lever	2.25	40	F09-3201	Pinion gear	13.45	
				41	F09-1702	Right side plate	12.05	