

BAITCASTING REEL — BW2, EL2, EL2C, PS2-2B, PS2-5B

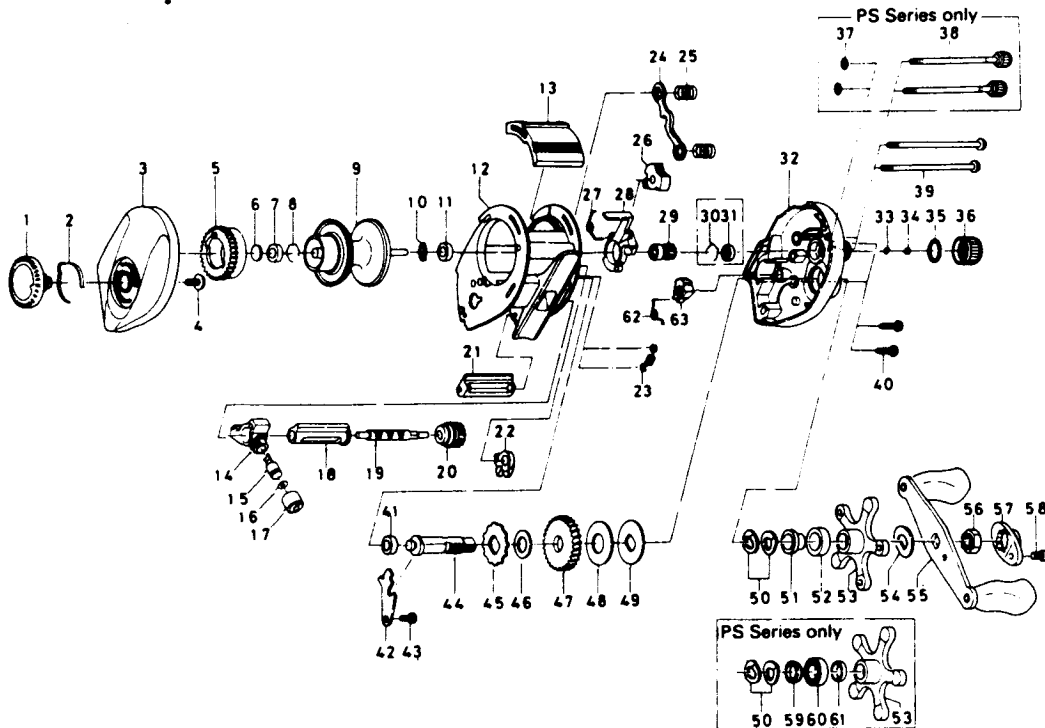

Key No.	Part No.	Part Name	Price
EL2 Special Parts:			
1	F06-0101	Brake adjusting knob	2.60
3	F05-4506	Left side plate	8.80
11	B35-8601	Ball bearing	8.75
12	F05-3702	Frame assembly	8.50
21	F05-3902	Line guard	1.45
32	F05-4219	Right side plate	9.00
53	E23-8702	Star drag	2.50
55	E30-5203	Handle assembly	5.95
EL2C Special Parts:			
1	F06-0101	Brake adjusting knob	2.60
3	F05-4507	Left side plate	8.80
11	B35-8601	Ball bearing	8.75
12	F05-3702	Frame assembly	8.50
20	F06-1301	Worm shaft gear	1.55
21	F05-3902	Line guard	1.45
29	E42-7701	Pinion gear	6.95
32	F05-4220	Right side plate	8.10
47	E42-7601	Drive gear	7.20
48	B30-9102	Drag washer	2.50
49	F06-6701	Key washer	1.15
53	E23-8702	Star drag	2.50
55	E30-5203	Handle assembly	5.95
PS2-2B Special Parts:			
1	F06-0401	Brake adjusting knob	4.25
3	F05-4503	Left side plate	9.85
9	F06-0601	Spool assembly	14.50
11	B35-8601	Ball bearing A	8.75
12	F05-3702	Frame assembly	8.50
13	F06-0201	Clutch lever	2.60

Key No.	Part No.	Part Name	Price
21	F05-3902	Line guard	1.45
32	F05-4218	Right side plate	9.30
37	B85-3101	"O" ring B	.60
38	B91-1712	Right side plate screw B	3.40
53	F06-0301	Star drag	5.65
55	E30-5203	Handle assembly	5.95
58	351-1803	Handle nut plate screw	.45
59	E20-8501	Spacing sleeve A	1.15
60	E15-4001	Ball bearing B	6.85
61	B97-4901	Spacing sleeve B	.95
PS2-5B Special Parts:			
1	F06-0901	Brake adjusting knob	4.25
3	F05-4504	Left side plate	11.35
7	B35-8601	Ball bearing A	8.75
9	F06-0601	Spool assembly	14.50
11	B35-8601	Ball bearing A	8.75
12	F05-3702	Frame assembly	8.50
13	F06-0201	Clutch lever	2.60
21	F05-3902	Line guard	1.45
30	E21-9701	Bearing retainer	.50
31	E24-8501	Ball bearing B	8.65
32	F05-4209	Right side plate	11.10
37	B85-3101	"O" ring B	.60
38	B91-1712	Right side plate screw B	3.40
41	B35-8601	Ball bearing A	8.75
53	F06-0303	Star drag	5.65
58	351-1803	Handle nut plate screw	.45
59	E20-8501	Spacing sleeve A	1.15
60	E15-4001	Ball bearing C	6.85
61	B97-4901	Spacing sleeve B	.95