

620 TERMINAL WAY • P. O. BOX 938 • COSTA MESA, CALIFORNIA 92627 • (714) 642-1163

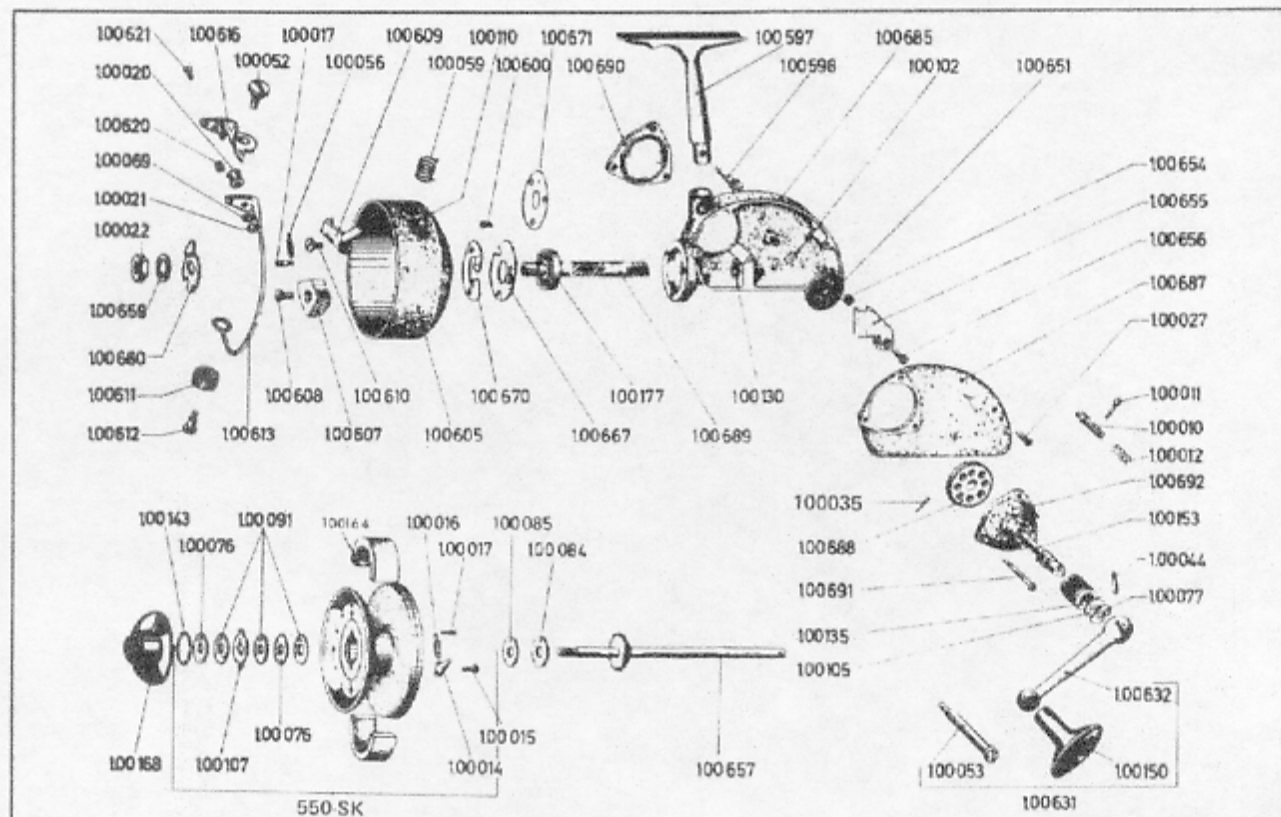

IMPORTANT: AN "N" SERIES QUICK SPOOL WILL NOT FIT THIS REEL.

PART NO.	DESCRIPTION	LIST PRICE	PART NO.	DESCRIPTION	LIST PRICE
100-010	Anti-reverse pin		100-177	Ball bearing	
100-011	Ball lever		100-597	Reel stand	
100-012	Spring		100-598	Cone screw	
100-014	Click tongue		100-600	Screw for switch ring	
100-015	Pin		100-605	Rotating Head W/607 & 608	
100-016	Spring		100-607	Counter-weight	
100-017	Pin		100-608	Screw for counter-weight	
100-020	Line guide		100-609	Trip lever	
100-021	Hexagon nut		100-610	Lug screw	
100-022	Hexagon nut		100-611	Cap for pick up arm	
100-027	Screw for case cover		100-612	Bearing screw	
100-038	Pin for drive gear		100-613	Bail	
100-044	Pin for crank arm		100-616	Angle lever	
100-052	Bearing screw		100-620	Spacing bushing	
100-053	Grip screw		100-621	Screw for angle lever	
100-056	Spring		100-631	Crank arm, complete	
100-059	Ball spring		100-632	Crank arm	
100-069	Lock washer		100-651	Worm wheel with pin	
100-077	Washer		100-654	Roller	
100-076	Tongue washer		100-655	Slide	
100-084	Washer (metal)		100-656	Screw for slide	
100-085	Washer (resitex)		100-657	Axle, complete	
100-091	Washer (resitex)		100-659	Spring washer	
100-102	Washer		100-660	Drive plate	
100-105	Washer slotted		100-667	Switch ring	
100-107	Driving plate		100-670	Braking ring	
100-110	Rubber buffer with spring		100-671	Gasket	
100-130	Bushing		100-685	Housing with bushing	
100-135	Crank nut		100-687	Housing cover	
100-143	Snap ring		100-688	Drive gear	
100-150	Handle grip		100-689	Drive shaft	
100-153	Drive axle		100-690	Plate cover	
100-164	Cork ring (2 halves)		100-691	Screw for bearing cover	
100-168	Drag nut		100-692	Bearing cover with bushing and oiler	
			550 SK	Spool, complete	
			***	To convert to manual bail use P/N B460	