

V.T. SW 30-01-94

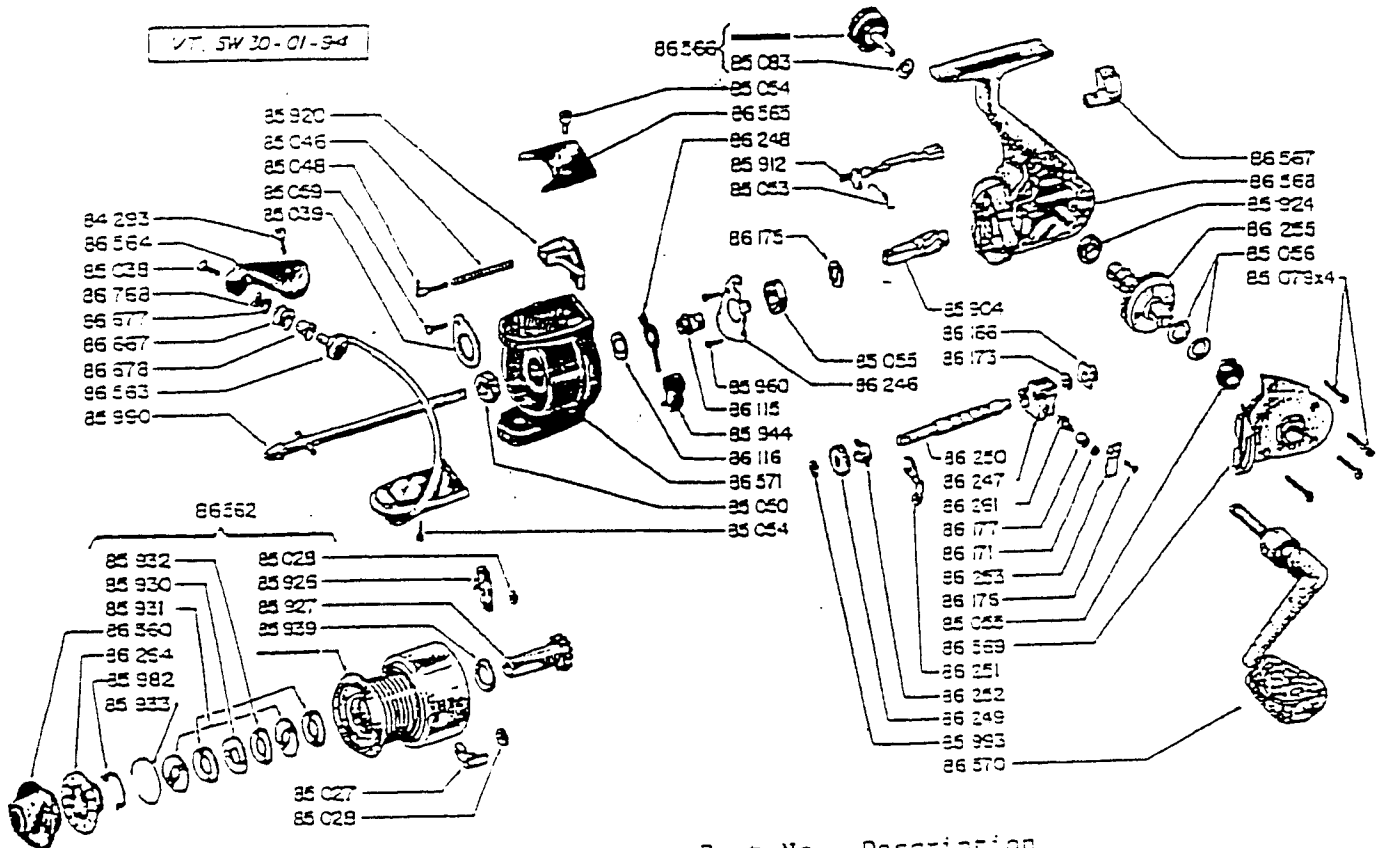

| Part No. | Description |
|----------|---------------------------|
| 8429300 | BAIL ARM SCREW |
| 8502700 | LINE CLIP |
| 8502800 | RETAINING CLIP |
| 8503800 | LINE GUIDE SCREW |
| 8503900 | HEX NUT LOCKING RING |
| 8504600 | BAIL SPRING |
| 8504800 | BAIL SPRING PIN |
| 8505000 | HEX NUT |
| 8505300 | ANTI-REVERSE SHAFT SPRING |
| 8505400 | RETAINER SCREW |
| 8505500 | BALL BEARING |
| 8505600 | SHIM - DRIVE GEAR |
| 8505900 | MOUNTING SCREW |
| 8507900 | SIDE PLATE SCREW |
| 8508300 | CAP SCREW WASHER |
| 8590400 | PINION GEAR |
| 8591200 | ANTI-REVERSE SHAFT |
| 8592000 | TRIP LEVER |
| 8592400 | BEARING |
| 8592600 | SPOOL CLICK |
| 8592700 | SPOOL SPINDLE |
| 8593000 | EARED DRAG WASHER |
| 8593100 | KEYED DRAG WASHER |
| 8593200 | DRAG WASHER |
| 8593300 | DRAG RETAINER |
| 8593900 | BASE DRAG WASHER |
| 8594400 | ANTI-REVERSE DOG |
| 8596000 | RETAINING SCREW |
| 8598200 | DRAG INDEX RETAINER |
| 8599000 | AXLE |
| 8599300 | RETAINING CLIP |
| 8611500 | AR FRICTION BUSHING |
| 8611600 | AR FRICTION WASHER |

| Part No. | Description |
|----------|-------------------------|
| 8616600 | WORM SHAFT BUSHING |
| 8617100 | PAWL WASHER |
| 8617300 | WORM SHAFT WASHER |
| 8617500 | BEARING WASHER |
| 8617600 | OSCILLATION SLIDE SCREW |
| 8617700 | PAWL BUSHING |
| 8624600 | BEARING RETAINER |
| 8624700 | OSCILLATION SLIDE |
| 8624800 | ANTI-REVERSE FRICTION |
| 8624900 | WORM SHAFT PINION |
| 8625000 | WORM SHAFT |
| 8625100 | OSC SLIDE RETAINER |
| 8625200 | WORM SHAFT BUSHING |
| 8625300 | PAWL RETAINER |
| 8625500 | DRIVE GEAR |
| 8626100 | OSCILLATION PAWL |
| 8626400 | DRAG INDEX |
| 8636000 | DRAG KNOB |
| 8636200 | SPOOL |
| 8636300 | BAIL WIRE W/COVER PLATE |
| 8636400 | BAIL ARM |
| 8636500 | COVER PLATE |
| 8636600 | HANDLE CAP SCREW |
| 8636700 | ANTI-REVERSE BUTTON |
| 8636800 | HOUSING |
| 8636900 | SIDE PLATE |
| 8637000 | HANDLE |
| 8637100 | ROTATING HEAD |
| 8666700 | LINE GUIDE |
| 8667700 | LINE GUIDE WASHER |
| 8667800 | LINE GUIDE BUSHING |
| 8676800 | LINE GUIDE RACE |

34

2