

SCL300

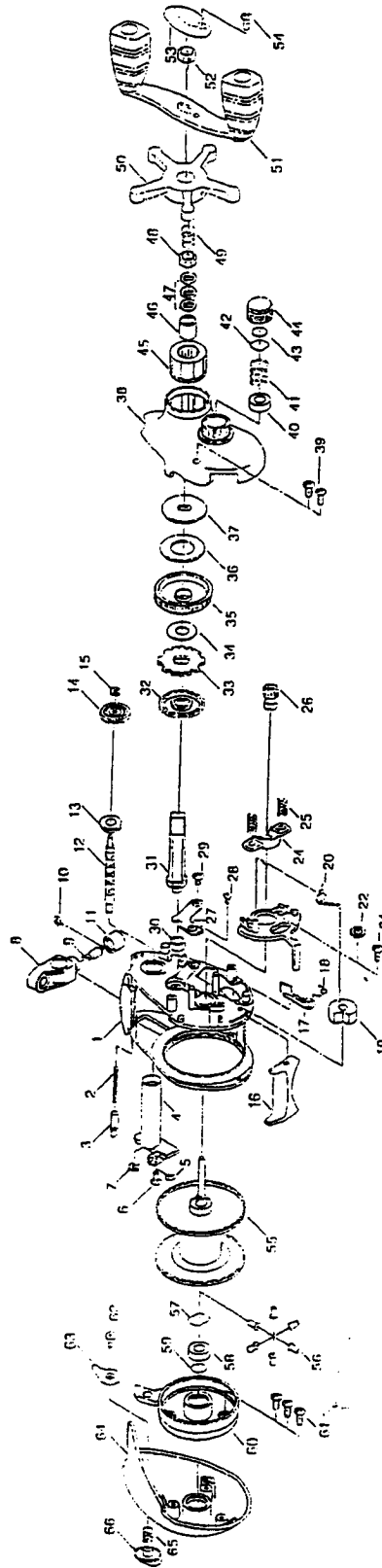

DESCRIPTION	SCL 300
1 FRAME ASSEMBLY	1071417
2 LOCKER SPRING	8889430
3 LOCKER	8889431
4 CARRIER GUIDE	8889432
5 CARRIER GUIDE S/C WASHER	8889433
6 CARRIER GUIDE SCREW	8889434
7 E-CLIP	8889435
8 CARRIER	1071418
9 PAWL	8889437
10 PAWL CAP WASHER	8889438
11 PAWL CAP	8889587
12 WORM SHAFT	8889440
13 WORM SHAFT RUSHING	8889441
14 O/S PINION	8889442
15 E-CLIP	8889443
16 THUMR PAN	8889444
17 KICKER	8889445
18 KICKER SPRING	8889446
19 FLIPPIN LEVER	8889447
20 FLIPPIN LEVER S/C	8889448
21 LATCH SCREW	8889449

22 LATCH SCREW WASHER	8889451
23 LATCH	8889452
24 PINION YOKE	8889453
25 YOKE SPRING	8889454
26 PINION GEAR	8889455
27 BEARING PLATE	8889456
28 BEARING PLATE SCREW	8889457
29 BEARING PLATE SCREW	8889458
30 BUSHING	8889588
31 CRANK SHAFT	8889462
32 O/S GEAR	8889463
33 LATCH GEAR	8889464
34 SPACER WASHER	8889465
35 DRIVE GEAR	8889466
36 DRAG "B" WASHER	8889467
37 DRAG "D" WASHER	8889468
38 RIGHT SIDE COVER	1071500
39 RIGHT SIDE COVER SCREW	8889471
40 BUSHING	8889591
41 TENSION SPRING	8889474
42 TENSION SHIM	8889475
43 TENSION RUBBER	8889476

44 TENSION KNOB	8889478
45 CLUTCH BEARING	8889479
46 SLEEVE	8889481
47 WAVE WASHER	8889482
48 DRAG NUT	8889483
49 DTAG NUT SPRING	8889484
50 STAR DRAG	1071507
51 HANDLE ASSEMBLY	8889486
52 HANDLE NUT	1071509
53 HANDLE NUT CAP	8889488
54 CAP SCREW	1071510
55 SPOOL ASSEMBLY	8889512
56 BRAKE SHOE	8889513
57 RETAINER	8889514
58 BALL BEARING	8889515
59 SPOOL COVER WASHER	8889516
60 SPOOL COVER	8889501
61 SPOOL COVER SCREW	8889505
62 KEY SCREW	8889506
63 KEY	1071511
64 LEFT SIDE COVER	8889508
65 BUTTON SPRING	1071513
66 BUTTON	

The part numbers shown on this drawing and parts list are available to order. To order a part, either contact the Pure Fishing Reel Service Department at 1-877-508-3474, or the Pure Fishing Warranty Service Center nearest you. To locate the nearest service center, please see the accompanying service center listing, or visit us at [www.purefishing.com](http://www.purefishing.com)