

# Penn Ultrasport 714

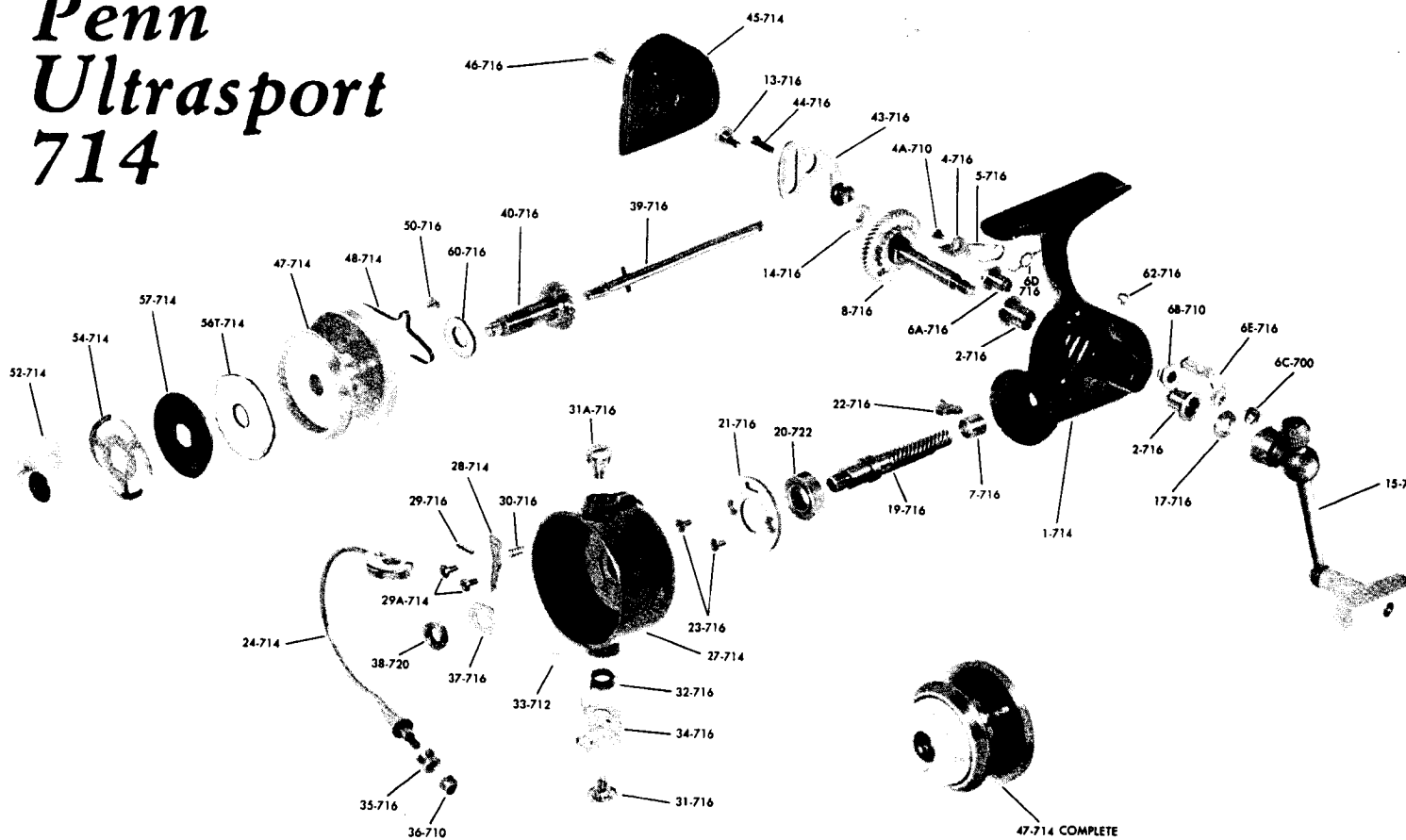

When ordering parts be sure to show reel model number after part number, Example—Handle Complete Part No. 15-714.

## PARTS LIST FOR #714 ASSEMBLY

PART No.	DESCRIPTION	PRICE	PART No.	DESCRIPTION	PRICE
1-714	Housing with Bushings	\$4.50	30-716	Arm Release Spring	.10
2-716	Handle Shaft Bushing	.25	29A-714	Retaining Screw	.10
4A-710	Screw	.10	31-716	Bail Screw	.35
4-716	Dog	.25	31A-716	Bail Screw (cam end)	.35
5-716	Dog Spring	.10	32-716	Bail Spring	.30
6A-716	Eccentric	.40	33-712	Plastic Bumper	.10
6B-710	Eccentric Liner	.10	34-716	Bail Arm	.65
6C-700	Eccentric Screw	.10	35-716	Line Roller	1.00
6D-716	Eccentric Spring	.10	36-710	Bail Lock Nut	.30
6E-716	Eccentric Lever	.30	37-716	Rotor Cup Washer	.15
7-716	Pinion Bushing	.20	38-720	Rotor Cup Nut	.20
8-716	Main Gear, Ratchet & Shaft	3.00	39-716	Spool Shaft Complete	1.10
13-716	Crosswind Screw	.20	40-716	Spool Sleeve Complete	1.00
14-716	Crosswind Roller	.15	43-716	Crosswind Block	.50
15-714	Handle Complete	2.50	44-716	Crosswind Shaft Screw	.10
17-716	Handle Washer	.20	45-714	Housing Plate	.65
19-716	Pinion Gear	2.75	46-716	Housing Plate Screw	.20
20-722	Pinion Bearing	3.25	47-714	Spool Complete w/ Drag & Click	5.50
21-716	Bearing Retainer	.50	48-714	Click Spring	.15
22-716	Bail Release Ramp	.35	50-716	Click Screw	.15
23-716	Bearing Retainer Screw	.10	52-714	Drag Knob	.65
24-714	Bail Wire	2.25	54-714	Drag Spring	.40
27-714	Rotor Cup	3.25	56T-714	Drag Washer-Teflon	.20
28-714	Bail Release Arm	.40	57-714	Metal Keyed Washer	.25
29-716	Pin Release Arm	.10	60-716	Rear Drag Washer	.15
			62-716	Screw Oiler	.10