

# PARTS AND PRICE LIST FOR INTERNATIONAL 12H

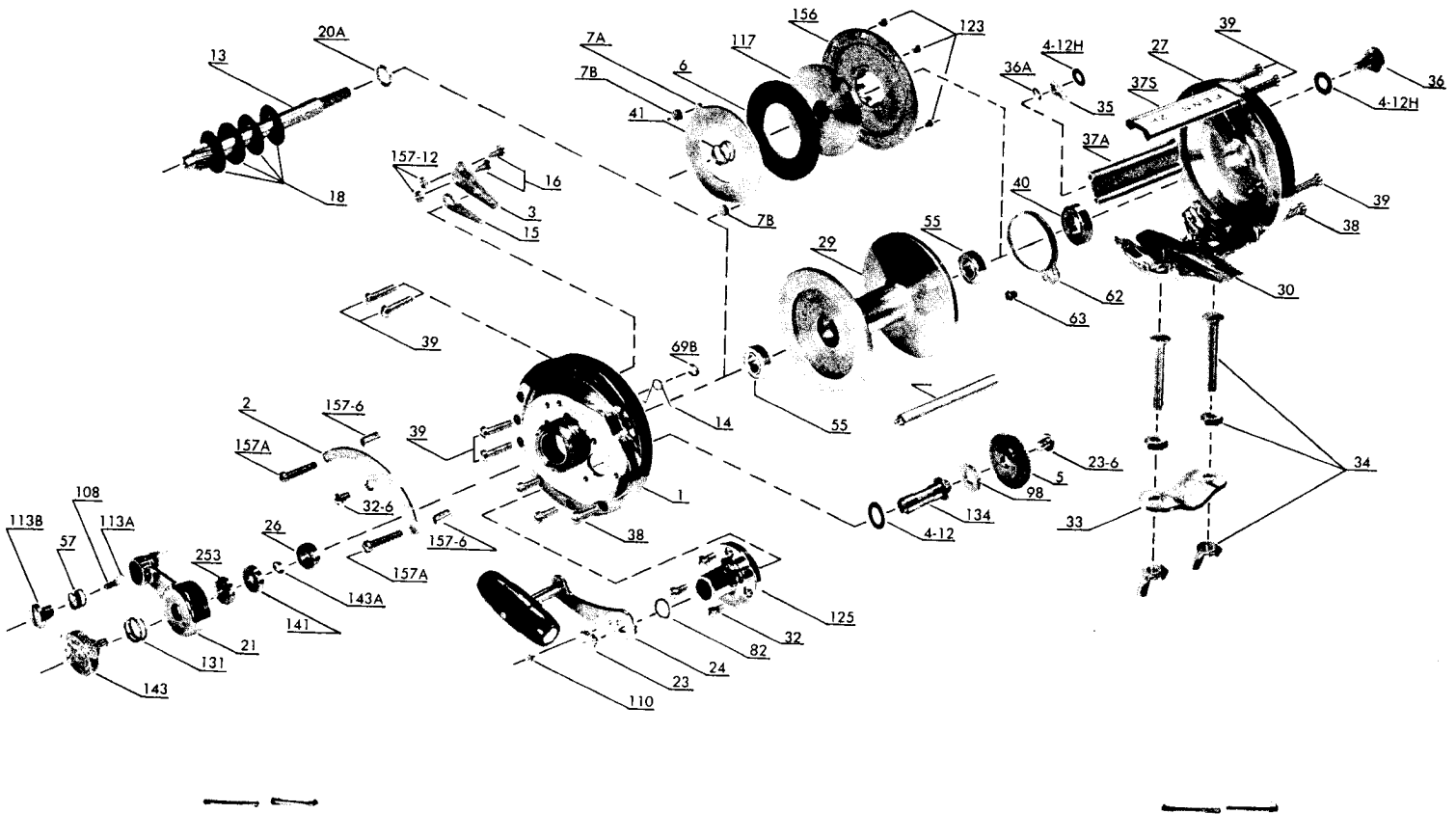

KEY NO.	DESCRIPTION	PART NO.	PRICE	KEY NO.	DESCRIPTION	PART NO.	PRICE
1	RIGHT SIDE PLATE ASSEMBLY	1-12	22.50	37A	SPACER BAR	37A-12	1.95
2	QUADRANT RING	2-6	2.95	37S	STAMPED SPACER BAR	37S-12H	2.50
3	RATCHET DOG BRIDGE	3-6	2.00	38	STAND SCREW	38-8	.20
4-12H	CLICK BUTTON WASHER	4-12H	.25	39	SPACER SCREW	39-6	.20
4-12	GEAR STUD WASHER	4-12	.25	40	LEFT SIDE PLATE BEARING	55-12H	5.50
5	MAIN GEAR	5-12H	4.00	41	BEARING SPRING	57-109	.30
6	DRAG WASHER	6-6	2.35	55	SPOOL BEARING	20-722	4.00
7A	METAL EAR DRAG WASHER	7A-6	1.50	57	DRAG LEVER SPRING	57-109	.30
7B	PRESSURE PLUG	7B-12H	.25	62	CLICK SPRING	62-309	.75
13	PINION GEAR	13-12H	12.00	63	CLICK SPRING SCREW	63-209	.30
14	DOG SPRING	14-6	.20	69B	RETAINING RING	69B-50	.30
15	DOG RATCHET	15-6	.30	82	HANDLE SHIM	82-6	.30
16	BRIDGE MOUNTING SCREW	16-6	.20	98	MAIN GEAR RATCHET	98-6	.65
18	CLUTCH SPRING	18-12H	.25	108	DRAG LEVER BUTTON SPRING	108-140	.30
20A	THRUST WASHER	20A-720	.25	110	HANDLE LOCK SCREW	110-60	.15
21	DRAG LEVER	21-6	11.00	113A	DRAG LEVER BUTTON	113A-6	.30
23-6	GEAR MOUNTING SCREW	23-6	.50	113B	DRAG LEVER SCREW	113B-6	.50
23	HANDLE SCREW	23-60	.75	117	DRIVE PLATE	117-12H	5.50
24	HANDLE COMPLETE	24-12H	5.75	123	DRAG COVER SCREW	123-6	.20
26	RIGHT SIDE BEARING	55-6	5.00	125	GEAR STUD HOUSING	125-6	5.75
27	LEFT SIDE PLATE ASSEMBLY	27-12H	20.00	131	PRE SET SPRING	131-6	.30
29	SPOOL	29L-12H	27.50	134	MAIN GEAR STUD	134-12H	2.50
30	REEL STAND	30-99	2.45	141	LEVER FOLLOWER	141-6	.95
32	GEAR STUD HOUSING SCREW	32-14	.20	143	PRE SET KNOB	143-6	3.20
32-6	QUADRANT SCREW	110-50	.20	143A	RETAINING RING	143A-6	.20
33	ROD CLAMP	33-200	1.10	156	DRAG WASHER COVER	156-12H	3.00
34	CLAMP SCREW W/NUTS	34-200	.60	157-6	QUADRANT SPACER BUSHING	157-6	.25
35	CLICK TONGUE	35-155	.35	157-12	RATCHET DOG BRIDGE BUSHING	157-12	.25
36	CLICK BUTTON	36-12H	.65	157A	QUADRANT SCREW	157A-12	.25
36A	RETAINING RING	36A-6	.20	253	THRUST BEARING	253-12	4.60
37	FRAME POST	37-12	.85				