

PARTS AND PRICE LIST FOR INTERNATIONAL 130 and 130H

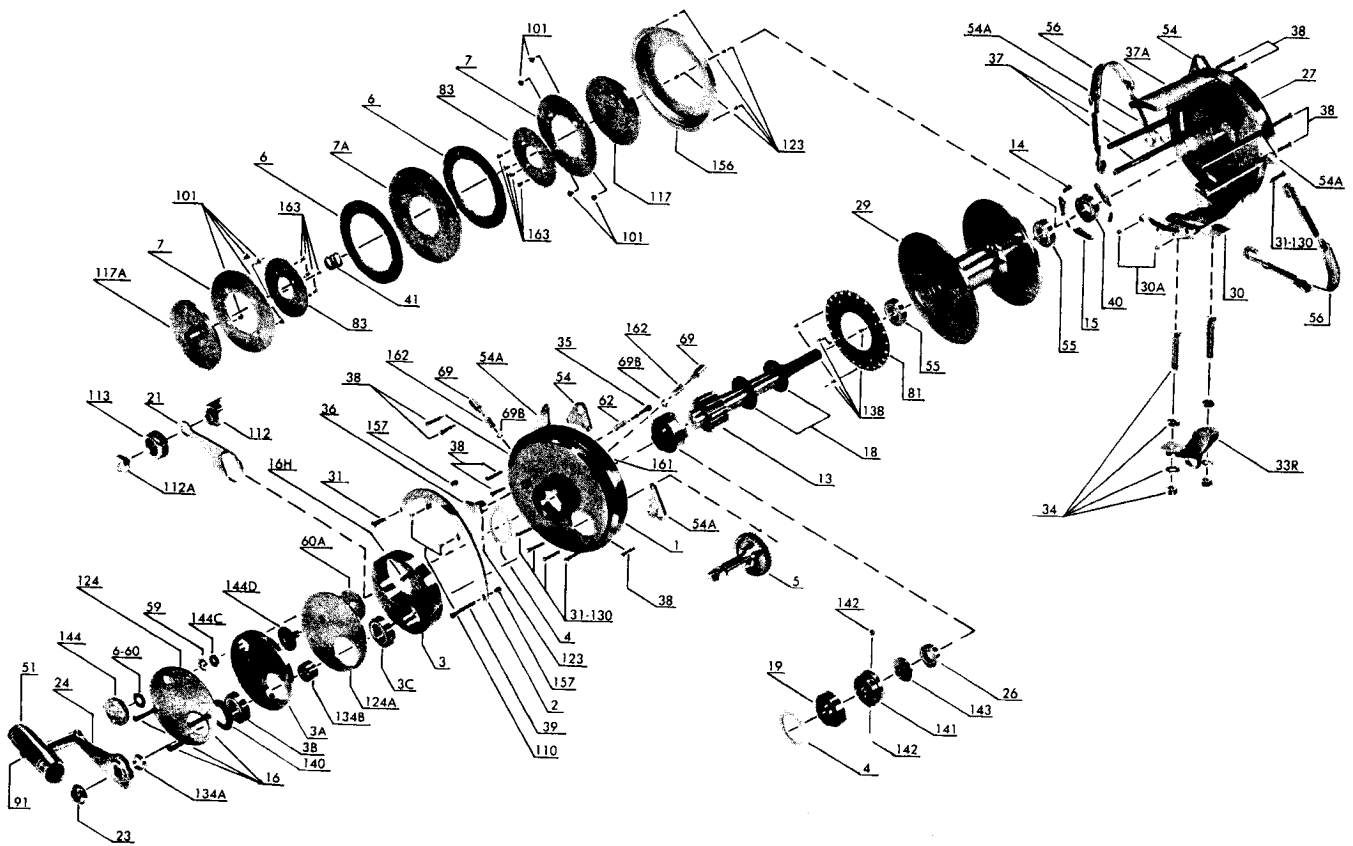

KEY NO.	DESCRIPTION	PART NO.	PRICE	KEY NO.	DESCRIPTION	PART NO.	PRICE
1	RIGHT SIDE PLATE ASSEMBLY	1-130	70.00	41	LEFT SIDE BEARING SPRING	41-130	.45
2	QUADRANT RING	2-130	6.50	51	HANDLE KNOB ASSEMBLY	51-130	4.30
3	BRIDGE (inner)	3-130	6.50	54	HARNES LUG	54-130	1.05
3A	BRIDGE (outer)	3A-130	4.30	54A	ROD BRACE LUG	54A-130	1.05
3B	BRIDGE BEARING (outer)	55-130	8.00	55	SPOOL BEARING	55-130	8.00
3C	BRIDGE BEARING (inner)	55-130	8.00	56	ROD BRACE ASSEMBLY	56-117	5.00
4	CAM THRUST WASHER	4-130	.55	59	SLOTTED WASHER	59-130	.30
5	MAIN GEAR	5-130	15.25	60	BACKING WASHER	60A-130	.55
6	DRAG WASHER	5-130H	15.25	62	CLICK SPRING	62-50	.30
6-60	LEATHER SPACER WASHER	6-130	4.00	69	LOCATING PIN	69-130	.65
7	METAL DRAG WASHER	6-60	.15	69B	RETAINING PIN	69B-130	.30
7A	FLOATING DRAG WASHER	7-130	3.50	81	RATCHET	81-130	4.30
13	PINION GEAR	7A-130	7.50	83	COLLAR PLATE	83-130	2.25
14	DOG SPRING	13-130	25.00	91	HANDLE SHAFT	91-130	2.50
15	DOG	13-130H	25.00	95	CLICK TONGUE BUSHING (not shown)	95-130	1.00
16	BRIDGE MOUNTING SCREW (outer)	49-710	.20	95A	CLICK BUSHING SPRING (not shown)	18-20	.25
16H	BRIDGE MOUNTING SCREW (inner)	15-130	.40	95B	CLICK BUSHING NUT (not shown)	38-710	.25
18	DISC CLUTCH SPRING	16-130	.25	101	DRIVE PLATE SCREW	101-130	.25
19	ECCENTRIC CAM	16H-130	.25	110	CENTER QUADRANT SCREW	110-50	.20
21	ECCENTRIC CAM LEVER	18-130	.40	112	ECCENTRIC LEVER KNOB	112-130	3.75
23	HANDLE NUT	18-130	.40	112A	ECCENTRIC KNOB SCREW	112A-130	.60
24	HANDLE COMPLETE	19-130	6.00	113	ECCENTRIC LEVER CAP	113-130	1.75
26	RIGHT SIDE BEARING	21-130	4.25	117	DRIVE PLATE	117-130	10.35
27	LEFT SIDE PLATE ASSEMBLY	23-130	1.05	117A	DRIVE PLATE (outer)	117A-130	8.75
29	SPOOL	24-130	13.50	123	DRAG COVER SCREW	123-50	.15
30	STAND	27-130	60.00	124	BRIDGE COVER (outer)	124-130	4.00
30A	DOWEL TUBE	29L-130	100.00	124A	BRIDGE COVER (inner)	124A-130	3.75
31-130	STAND SCREW	30-130	30.00	134A	HANDLE SPACING COLLAR	134A-130	.75
31	QUADRANT SCREW	30A-130	.35	134B	BEARING SPACING BUSHING	134B-130	.55
33R	RINGED ROD CLAMP	31-130	.25	138	RATCHET SCREW	101-30	.20
34	ROD CLAMP SCREW W/NUTS	16H-130	.25	140	FELT WASHER	140-115	.25
35	CLICK TONGUE	33R-130	9.25	141	CAM FOLLOWER	141-130	4.30
36	CLICK BUTTON	34-116	1.50	142	CAM FOLLOWER PIN	142-130	.25
37	FRAME POST	35-130	1.05	143	ADJUSTING SCREW	143-130	3.80
37A	SPACER BAR	36-50	1.05	144	PRE SET KNOB	144-130	3.80
		37-130	1.10	144C	PRE SET PINION	144C-130	.80
		37A-130	8.50	144D	PRE SET GEAR ASSEMBLY	144D-130	2.00
		37A-130H	8.50	156	DRAG COVER	156-130	3.50
38	POST SCREW	38-130	.25	157	QUADRANT SPACER BUSHING	157-130	.25
39	SPECIAL POST SCREW	39-130	.40	161	STOP PIN BUSHING	161-130	.65
40	LEFT SIDE BEARING	39-130	.40	162	STOP PIN SPRING	162-130	.20
		55-130	8.00	163	COLLAR PLATE SCREW	101-30	.20