

PARTS AND PRICE LIST FOR INTERNATIONAL 20 and 30

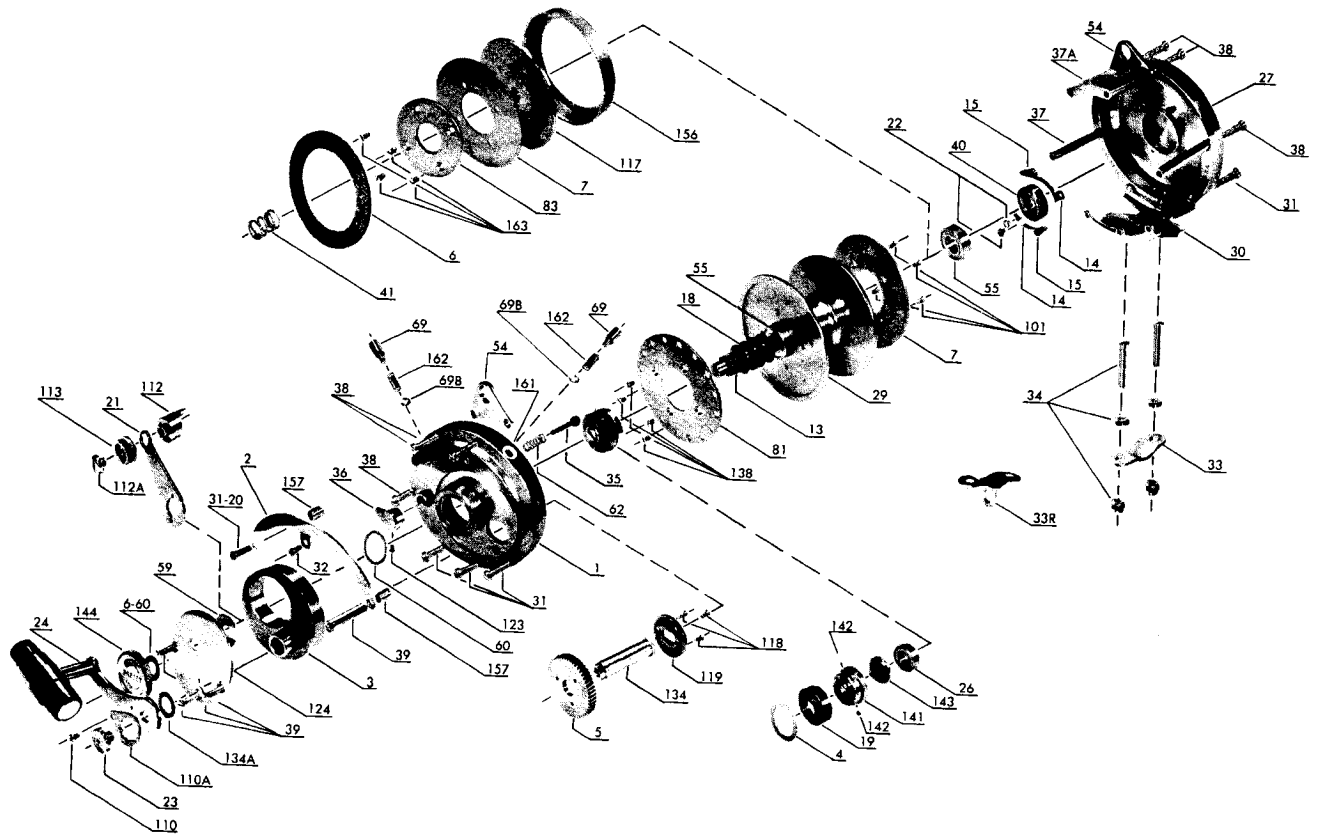

KEY NO.	DESCRIPTION	PART NO.	PRICE	KEY NO.	DESCRIPTION	PART NO.	PRICE
1	RIGHT SIDE PLATE ASSEMBLY	1-20	32.50	38	POST SCREW	38-50	.20
2	QUADRANT RING	2-30	2.55	39	BRIDGE SCREW	39-12	.20
3	BRIDGE ASSEMBLY	3-30	5.70	39-50	SPECIAL POST SCREW	39-50	.45
4	CAM THRUST WASHER	4-30	.40	40	LEFT SIDE BEARING	55-80	7.50
5	MAIN GEAR	5-50	4.30	41	LEFT SIDE BEARING SPRING	41-50	.30
6	DRAG WASHER	6-30	2.75	54	HARNES LUG	54-50	.50
6-60	LEATHER SPACER WASHER	6-60	.15	55	SPOOL BEARING	20-704	5.50
7	METAL DRAG WASHER	7-30	2.60	59	SLOTTED WASHER	59-50	.30
13	PINION GEAR	13-20	10.00	60	BACKING WASHER	60-50	.30
14	FLAT DOG SPRING	14-50	.25	62	CLICK SPRING	62-50	.30
15	DOG	15-50	.30	69	LOCATING PIN	69-50	.65
18	DISC CLUTCH SPRING	18-20	.25	69B	RETAINING PIN	69B-50	.30
19	ECCENTRIC CAM	19-30	3.00	81	RATCHET	81-50	2.35
21	ECCENTRIC CAM LEVER	21-30	2.60	83	COLLAR PLATE	83-50	2.00
22	DOG SPRING SCREW	22-109	.25	95	CLICK TONGUE BUSHING (not shown)	95-50	1.00
23	HANDLE SCREW	23-114	1.20	95B	CLICK BUSHING NUT (not shown)	38-710	.25
24	HANDLE COMPLETE	24-30	5.75	101	DRIVE PLATE SCREW	101-30	.20
26	RIGHT SIDE BEARING	55-30	5.50	110	HANDLE LOCK SCREW	110-50	.20
27	LEFT SIDE PLATE ASSEMBLY	27-20	25.00	110A	HANDLE LOCKING PLATE	110A-50	.55
29	SPOOL	29L-20	32.00	112	ECCENTRIC LEVER KNOB	112-50	1.05
30	STAND	29L-30	35.00	112A	ECCENTRIC KNOB SCREW	112A-50	.35
31	STAND SCREW	30-20	4.45	113	ECCENTRIC LEVER CAP	113-50	.35
31-20	QUADRANT SCREW	30-30	4.60	117	DRIVE PLATE	117-30	8.75
32	CENTER QUADRANT SCREW	31-20	.20	118	MAIN GEAR PLATE SCREW	38-7	.20
33	ROD CLAMP MODEL 20	30-20	4.45	119	MAIN GEAR PLATE	119-50	.50
33R	RINGED ROD CLAMP MODEL 20	31-20	.20	123	CLICK BUTTON SCREW	123-50	.15
34	ROD CLAMP SCREW W/NUTS	31-20	.20	124	BRIDGE COVER	124-30	2.35
35	CLICK TONGUE	32-14	.20	134	GEAR STUD	134-50	2.65
36	CLICK BUTTON	33-49	1.00	134A	GEAR STUD WASHER	134A-50	.35
37	FRAME POST	33-200	1.10	138	RATCHET SCREW	101-30	.20
37-A	SPACER BAR	33R-200	2.50	141	CAM FOLLOWER	141-30	2.60
		34-20	.70	142	CAM FOLLOWER PIN	142-50	.20
		34-30	.70	143	ADJUSTING SCREW	143-30	1.05
		35-50	.45	144	PRE SET KNOB	144-50	3.20
		36-50	1.05	149	ROD CLAMP HEX NUT	149-200	.20
		37-20	.70	152A	ROD CLAMP ACORN NUT	152A-50	.30
		37-30	.80	157	DRAG COVER	156-30	2.00
		37A-20	5.00	161	QUADRANT SPACER BUSHING	157-50	.20
		37A-30	5.50	162	LOCATING PIN BUSHING	161-50	.50
				163	LOCATING PIN SPRING	162-50	.20
					COLLAR PLATE SCREW	101-30	.20