

PARTS AND PRICE LIST FOR INTERNATIONAL 80 and 80W

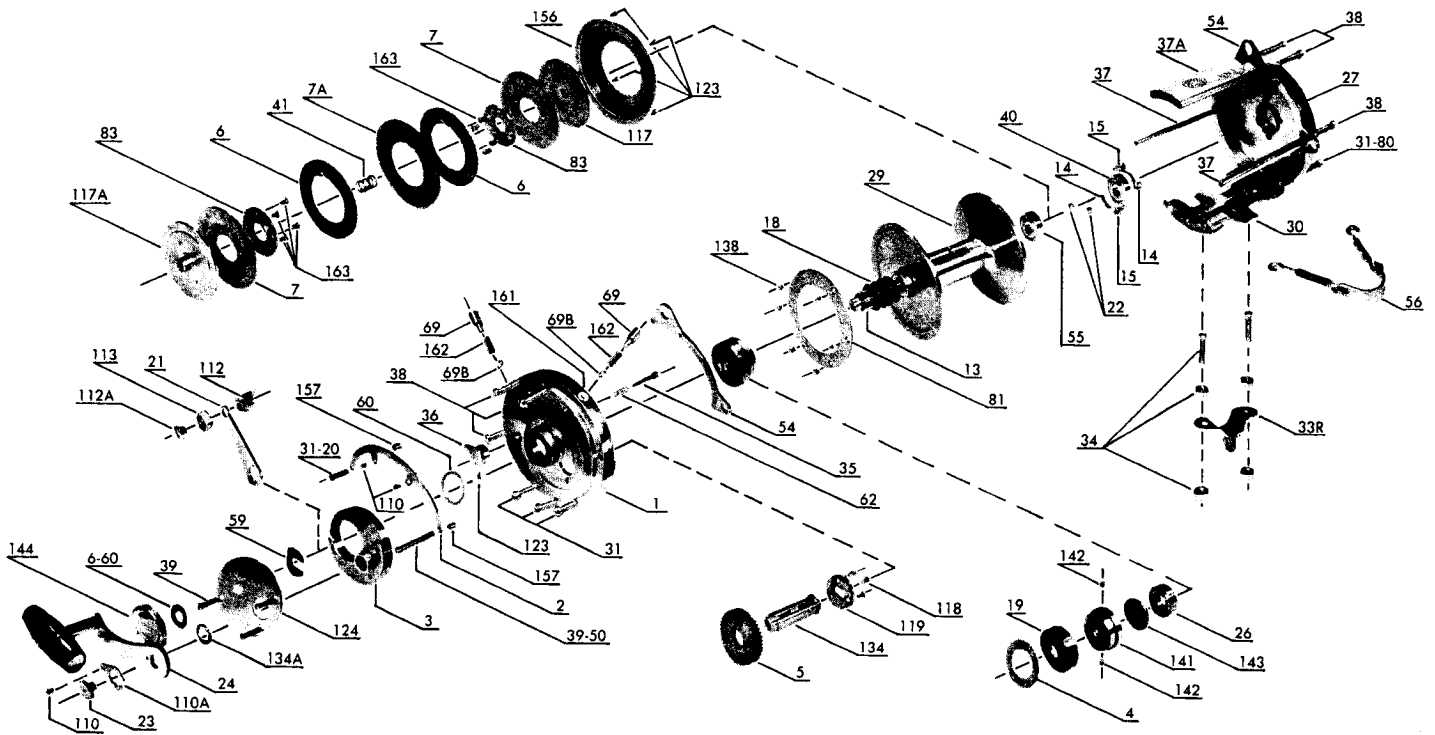

KEY NO.	DESCRIPTION	PART NO.	PRICE	KEY NO.	DESCRIPTION	PART NO.	PRICE
1	RIGHT SIDE PLATE ASSEMBLY	1-80	60.00	41	LEFT SIDE BEARING SPRING	41-50	.30
2	QUADRANT RING	2-80	4.75	54	HARNES LUG	54-80	4.30
3	BRIDGE ASSEMBLY	3-80	8.15	55	SPOOL BEARING	55-80	7.50
4	CAM THRUST WASHER	4-80	.50	56	ROD BRACE COMPLETE	56-80	5.00
5	MAIN GEAR	5-80	6.20	59	SLOTTED WASHER	59-50	.30
6	DRAG WASHER	6-50	3.50	60	BACKING WASHER	60-50	.30
6-60	LEATHER SPACER WASHER	6-60	.15	62	CLICK SPRING	62-50	.30
7	METAL DRAG WASHER	7-50	2.50	69	LOCATING PIN	69-50	.65
13	PINION GEAR	13-80	20.00	69B	RETAINING PIN	69B-50	.30
		13-80W	22.50	81	RATCHET	81-80	3.25
14	FLAT DOG SPRING	14-50	.25	83	COLLAR PLATE	83-50	2.00
15	DOG	15-50	.30	95	CLICK TONGUE BUSHING (not shown)	95-80	1.00
18	DISC CLUTCH SPRING	18-80	.40	95A	CLICK BUSHING SPRING (not shown)	18-20	.25
19	ECCENTRIC CAM	19-80	4.75	95B	CLICK BUSHING NUT (not shown)	38-710	.25
21	ECCENTRIC CAM LEVER	21-80	3.75	110	HANDLE LOCK SCREW	110-50	.20
22	DOG SPRING SCREW	22-109	.25	110A	HANDLE LOCKING PLATE	110A-50	.55
23	HANDLE SCREW	23-116	1.40	112	ECCENTRIC LEVER KNOB	112-50	1.05
24	HANDLE COMPLETE	24-80	9.00	112A	ECCENTRIC KNOB SCREW	112A-50	.35
26	RIGHT SIDE BEARING	55-80	7.50	113	ECCENTRIC LEVER CAP	113-50	.35
27	LEFT SIDE PLATE ASSEMBLY	27-80	50.00	117	DRIVE PLATE (outer)	117-80	9.75
29	SPOOL	29L-80	65.00	117A	DRIVE PLATE (inner)	117A-80	7.60
		29L-80W	75.00	118	MAIN GEAR PLATE SCREW	118-80	.25
30	STAND	30-80	7.75	119	MAIN GEAR PLATE	119-80	.55
		30-80W	10.00	123	CLICK BUTTON SCREW	123-50	.15
31	STAND SCREW	31-80	.20	124	BRIDGE COVER	124-80	2.95
31-20	QUADRANT SCREW	31-20	.20	134	GEAR STUD	134-80	3.50
33R	RINGED ROD CLAMP MODEL 80	33R-116	7.00	134A	GEAR STUD WASHER	134A-80	.50
	MODEL 80W	33R-116	7.00	138	RATCHET SCREW	31-19	.20
34	ROD CLAMP SCREW W/NUTS	34-116	1.50	141	CAM FOLLOWER	141-80	3.20
35	CLICK TONGUE	35-80	.55	142	CAM FOLLOWER PIN	142-50	.20
36	CLICK BUTTON	36-50	1.05	143	ADJUSTING SCREW	143-80	1.20
37	FRAME POST	37-80	.95	144	PRE SET KNOB	144-50	3.20
		37-80W	1.10	149	ROD CLAMP HEX NUT	149-116H	.40
37A	SPACER BAR	37A-80	7.50	152A	ROD CLAMP NUT	149-116L	.40
		37A-80W	9.00	156	DRAG COVER	156-80	2.60
38	POST SCREW	38-80	.20	157	QUADRANT SPACER BUSHING	157-50	.20
39	BRIDGE SCREW	39-12	.20	161	LOCATING PIN BUSHING	161-50	.50
39-50	SPECIAL POST SCREW	39-50	.45	162	LOCATING PIN SPRING	162-50	.20
40	LEFT SIDE BEARING	55-80	7.50	163	COLLAR PLATE SCREW	101-30	.20