

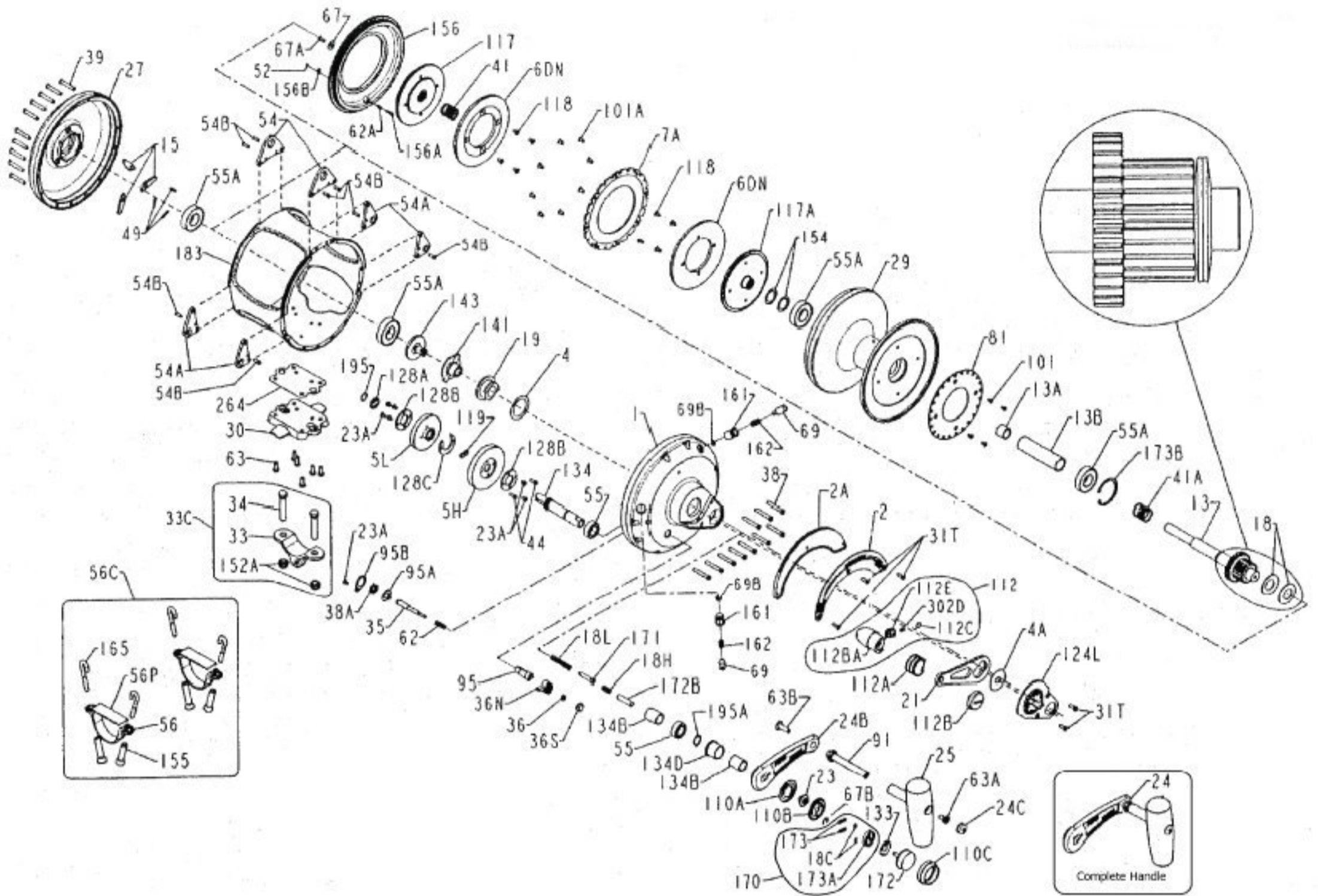

PARTS LIST FOR MODEL 130VSX



Penn Reel Parts list for:

KEY PART NO.	DESCRIPTION
1	1-130VS RIGHT SIDE PLATE ASSEMBLY
2	2-130VS QUADRANT RING
2A	2A-130VS DRAG LEVER RATCHET
4	4-130VS CAM THRUST WASHER (2 REQ.)
4A	4A-70 LEVER THRUST WASHER
5	5-130VSHS MAIN GEAR HIGH SPEED
5L	5-130VSLS MAIN GEAR LOW SPEED
6DN	6DN-130 DRAG WASHER ASSEMBLY (DURA-DRAG)
7A	7A-130VS DRAG PLATE
13	13-130ST PINION GEAR ASSEMBLY
13A	13A-130 PINION SLEEVE (SHORT)
13	13-130VSLV SPOOL SLEEVE (LONG)
14	49-710 DOG SPRING (3 REQ.)
15	15-130 DOG (3 REQ.)
18	18-130 DISC CLUTCH SPRINGS (2 REQ.)
18C	18C-15KG SHIFT BUTTON SPRING (2 REQ.)
18H	18H-30VS SHIFT SPRING (HEAVY)
18L	18L-30VS SHIFT SPRING (LIGHT)
19	19-130VS ECCENTRIC CAM
21	21-130VS ECCENTRIC LEVER
23	23-130VS HANDLE SCREW
23A	23A-750 SCREW, MAIN GEAR (7 REQ.)
24	24-130VS HANDLE COMPLETE
24B	24-130VS-1 HANDLE ARM (ONLY)
24C	24C-80ST HANDLE KNOB CAP
25	25-80ST HANDLE KNOB
27	27-130VS LEFT SIDE PLATE ASSEMBLY
29	29-130VS SPOOL
30	30-130VS STAND
31	31T-70 SCREW (5 REQ.)
33	33-130ST RINGED ROD CLAMP
33C	33C-130VSX ROD CLAMP KIT
34	34-130 CLAMP SCREW (2 REQ.)
34C	34C-130VSX ROD CLAMP SCREW W/ NUT
35	35-130VS CLICK TONGUE
36	36-700 CLICK BUTTON NUT
36C	36C-130VS CLICK BUTTON ASSEMBLY COMPLETE
36N	36N-50 CLICK BUTTON
36S	36S-80ST CLICK BUTTON CAP
38	38-130VS RIGHT SIDE PLATE SCREWS (10 REQ.)
38A	38-710 CLICK RETAINER NUT
39	39-130VS LEFT SIDE PLATE SCREW (10 REQ.)
41	41-130VS LEFT SIDE BEARING SPRING
41A	41A-130VS RIGHT SIDE BEARING SPRING
44	44-710 DRIVE PLATE SCREW (2 REQ.)
49	49-710 DOG SPRING (3 REQ.)
52	52-910 RETAINING RING
54	54-130VS HARNESS LUG (2 REQ.)
54A	54A-130VS ROD BRACE LUG (4 REQ.)
54B	54B-80VS LUG SCREW (8 REQ.)
55	55-80ST BALL BEARING (2 REQ.)
55A	55-130 BALL BEARING (4 REQ.)
56	56-130 ROD BRACE (2 REQ.)
56C	56C-130VSX ROD BRACE ASSEMBLY
56P	56P-117 ROD BRACE PAD (2 REQ.)
62	62-50 CLICK SPRING
62A	62A-54S DRAG COVER LOCK SPRING

Model: 130VSX

KEY PART NO.	DESCRIPTION
63	63-30T STAND SCREW (6 REQ.)
63A	63A-50 HANDLE KNOB SCREW (REVERSE THREAD)
63B	63B-80VS HANDLE SHAFT SCREW
67	67-70 PINION RETAINING WASHER
67A	67A-70 PINION RETAINING SCREW
67D	67D-130VS RETAINING RING
69	69-130 DRAG LOCATING PIN (2 REQ.)
69B	69B-130 RETAINING RING (2 REQ.)
81	81-130 CLICK RATCHET PLATE
91	91-80VS HANDLE SHAFT
95	95-70 CLICK TONGUE BUSHING
95A	95A-50 CLICK BUSHING LOCK WASHER
95B	95B-70 CLICK LOCKING PLATE
101	101-130VS CLICK RATCHET SCREW (4 REQ.)
101A	101A-130S DRAG WASHER SCREW (3 REQ.)
110A	110A-130VS HANDLE SCREW LOCKING RING
110B	110B-130VS SHIFTER BASE ASSEMBLY
110C	110C-130VS SHIFT BUTTON RETAINER
112	112-130VS LEVER KNOB ASSEMBLY
112A	112A-130VS SLEEVE
112B	112B-130VS SCREW
112BA	112BA-130VS-1 LEVER KNOB
112C	112C-30VS CLICK PLATE
112E	112E-30VS CLICK PLATE HOUSING
117	117-130 DRIVE PLATE (OUTER)
117A	117A-130 DRIVE PLATE (INNER)
118	118-80S DRIVE PLATE SCREW (8 REQ.)
119	119-130VS SHIFT PLATE
124L	124L-130VS BRIDGE COVER ASSEMBLY
128A	128A-130VS DRIVE PLATE
128B	128B-130VS DRIVE PLATE (2 REQ.)
128C	128C-130VS MAIN GEAR CONNECTING PLATE
133	133-30VS RETAINING CLIP
134	134-130VS GEAR STUD
134B	134B-130VS SHIFTER SLEEVE (2 REQ.)
134D	134D-130VS SHIFTER BUSHING
141	141-130VS CAM FOLLOWER
143	143-130VS ADJUSTING SCREW
152A	152A-80T ROD CLAMP ACORN NUT (2 REQ.)
154	154-130 SPOOL SHIM (2 REQ.)
155	155-130 TURNBUCKLE (2 REQ.)
156	156-130VS DRAG COVER
156A	156A-30VS DRAG COVER LOCK PIN
156B	156B-30VS DRAG COVER LOCK PLATE
161	161-130VS LOCATING PIN BUSHING (2 REQ.)
162	162-130 LOCATING PIN SPRING (2 REQ.)
165	165-116 RIGHT HAND SCREW HOOK (4 REQ.)
170	170-30VS CATCH ASSEMBLY
171	171-15KG SHIFTER PLUNGER
172B	172B-130S SHIFTER SPACER
173	173-30VS SHIFTER CATCH (2 REQ.)
173A	173A-30VS SHIFTER CATCH HOLDER
173B	173B-130VS RETAINING RING
183	183-130VSX TUBE FRAME
185	185-24KG SPIRAL RETAINING RING
185A	185A-600 RETAINING RING
264	264-130ST STAND GASKET
302D	302D-52MMAG SPRING