

Parts Schematic
Penn 209M-LH
(Left Hand Version)

PENN

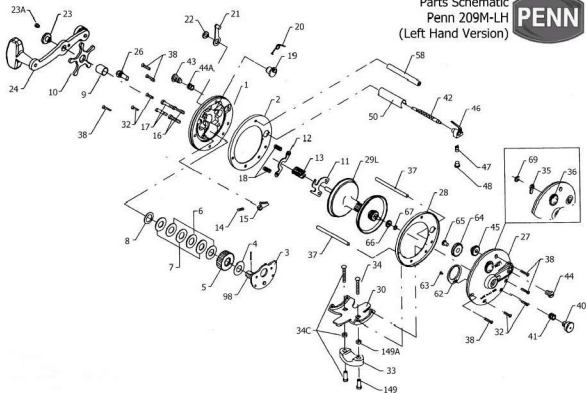

Penn Reel Parts list for:

Model: 209-LH, 209M-LH (LEFT HANDED VERSION)

KEY PART NO. NO.	DESCRIPTION
1-1-209LH	LEFT SIDE PLATE (LEFT HAND VERSION)
2-2-209	LEFT SIDE RING
3-8-155LH	BRIDGE W/ SLEEVE (LEFT HAND VERSION)
4-4-155	FIBER WASHER
5-5-155LH	MAIN GEAR (LEFT HAND VERSION)
6-6-155	DRAG WASHER
7-7C-155	DRAG WASHER (METAL SET)
8-8-60	TENSION WASHER
9-9-90	SPACING SLEEVE
10-10-600LH	STAR DRAG (LEFT HAND VERSION)
11-11-155	ECCENTRIC JACK
12-12-155	PINION YOKE
13-13-155LH	PINION GEAR (LEFT HAND VERSION)
14-14-90	DOG SPRING
15-15-200	DOG
16-16-600H	LOWER BRIDGE SCREW (2 REQ.)
17-17-600H	UPPER BRIDGE SCREW (2 REQ.)
18-18-60	CLUTCH SPRING
19-19-209LH	ECCENTRIC (LEFT HAND VERSION)
20-20-155	ECCENTRIC SPRING
21-21-209	ECCENTRIC LEVER
22-22-600H	ECCENTRIC SCREW
23-23-60	HANDLE SCREW
23A-110-60	HANDLE LOCK SCREW
24-24-310	HANDLE
26-26-155	LEFT SIDE BEARING
27-27-209	RIGHT SIDE PLATE
28-28-209	RIGHT SIDE RING
29L-29L-209	SPACIAL ALUMINUM
30-30-60	STAND
32-32-22	RIGHTLEFT SIDE STAND SCREW (2REQ. PER SIDE)

KEY PART NO. NO.	DESCRIPTION
33-33-113	ROD CLAMP
* 33R-200	RINGED CLAMP (OPTIONAL)
34-34-45	CLAMP SCREW (ONLY)
34C-34C-45	CLAMP SCREW/ NUTS
35-35-155	CLICK TOUNGE
36-36H-209	CLICK BUTTON
37-37-160	FRAME POST (2 REQ.)
38-38-8	RIGHTLEFT SIDE POST SCREW (8 REQ. PER SIDE)
40-40-60	RIGHT SIDE BEARING
41-41-60	RIGHT SIDE BEARING SPRING
42-42-209	WORM
43-43-109	LEFT SIDE WORM BEARING
44-43-109	RIGHT SIDE WORM BEARING
44A-57-109	WORM BEARING SPRING
45-45H-209	WORM GEAR
46-46-209	LINE GUIDE
47-47-109	PAWEL
48-48-109	PAWEL COVER
50-50-209	WORM SHIELD
58-58-209	SLOTTED POST
62-62-209	CLICK SPRING
63-63-209	CLICK SPRING SCREW
64-64-209	DILER GEAR
65-65-209	DILER GEAR SCREW
66-66-209	LEVEL WIND DRIVE GEAR
67-67-209	DRIVE GEAR LOCK SPRING
69-69B-600	CLICK BUTTON/RETAINING SPRING
98-98-155LH	GEAR SLEEVE (LEFT HAND VERSION)
149-149-45	CLAMP NUT (2 REQ.)
149A-149-200	HEX NUT (2 REQ.)

*Not Shown