

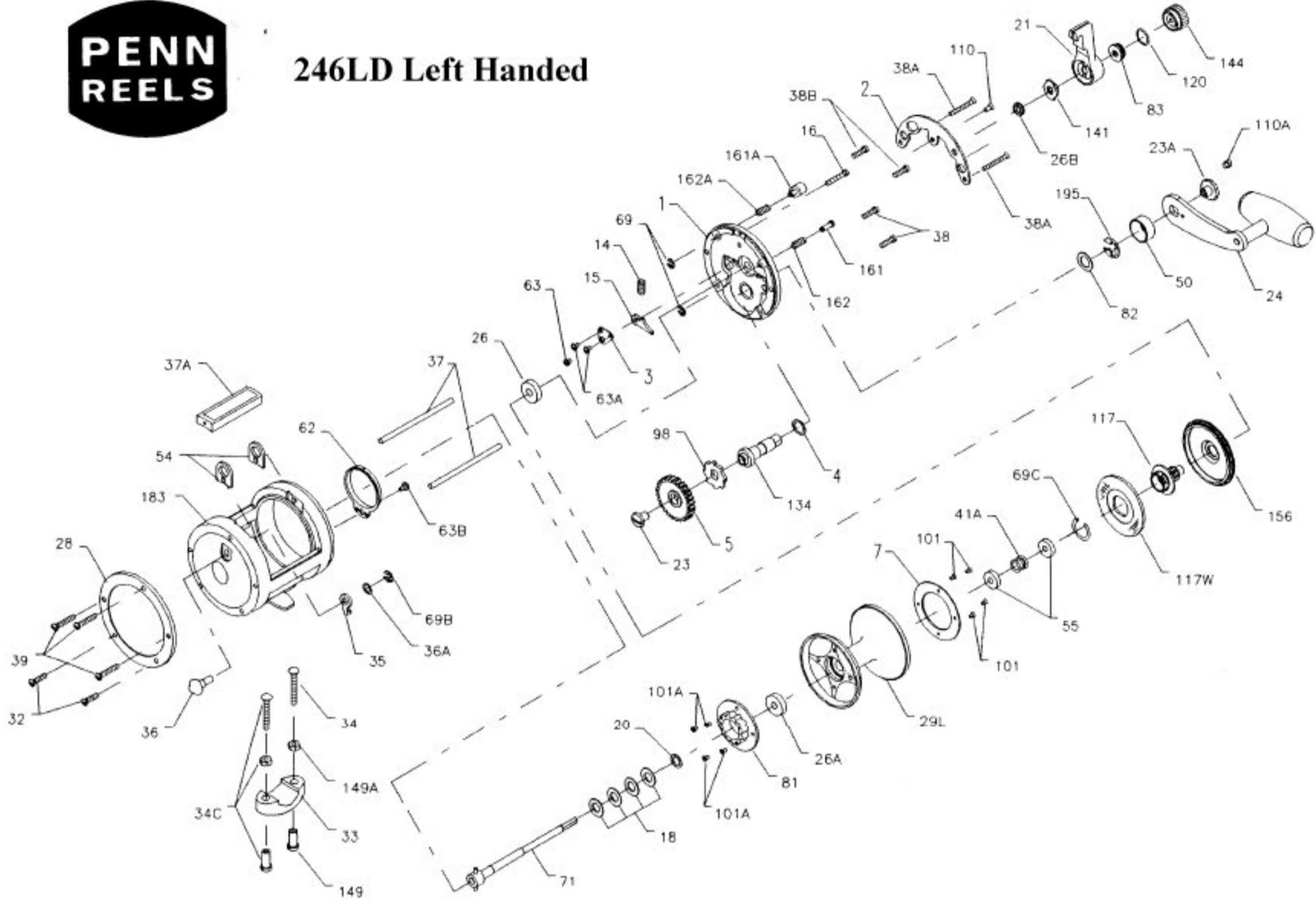

246LD Left Handed



Penn Reel Parts list for:

Model: 246LD (Left Handed)

KEY PART NO.	NO.	DESCRIPTION	KEY PART NO.	NO.	DESCRIPTION
1	1-245	RIGHT SIDE PLATE ASSEMBLY	50	50-40	GEAR STUD COVER
2	2-246	QUADRANT RING	54	54-113	SPOOL BEARING (2 REQ)
3	3-40	DOG BRIDGE	55	55.6	R.S. SPOOL BAIL BEAR
4	4-40	GEAR STUD WASHER	62	62-40	CLICK SPRING
5	5-45	MAIN GEAR	63	63-349	LOWER DOG BRIDGE S
7	7-40	METAL DRAG WASHER	63A	63-500S	UPPER DOG BRIDGE S
14	14-40	DOG SPRING	63B	63-500S	CLICK SPRING SCREW
15	15-40	DOG	69	69B-50	RETAINING RING (2 REQ)
16	16-9	TOP R.S. PLATE SCREW	69B	69B-600	CLICK BUTTON RETAIN
18	18-40	CLUTCH DISC SPRING	69C	69C-245	RETAINING RING
20	20-40	THRUST WASHER	71	71-40	SPINDLE SPOOL ASSE
21	21-246	DRAG LEVER ASSEMBLY	81	81-40	CLICK RATCHET
23	23-6CH	GEAR MOUNTING SCREW	82	82-40	HANDLE SHIM
23A	23-114	HANDLE SCREW ASSEMBLY	83	83-245	PRESET COLLAR
24	24-40P	HANDLE ASSEMBLY	98	98-40	MAIN GEAR RATCHET
26	26N-40	R.S. PLATE BALL BEARING	101	101-30	MAIN DRAG WASHER S
26A	26-40	L.S. SPOOL BEARING	101A	101-30	CLICK RATCHET SCRE
26B	26-45	R.S. BUSHING	110	110-50	QUADRANT RING SCRE
28	28-40	LEFT SIDE RING	110A	110-60	HANDLE LOCK SCREW
29L	29L-245	SPOOL ASSEMBLY	117	117-245	DRIVE PALTE ASSEMBE
32	32-310	LOWER L.S. RING SCREW (2 REQ)	117W	117W-245	DRIVE PLATE WASHER
33	33-113	ROD CLAMP	120	120-245	O-RING
*	33R-200	RINGED ROD CLAMP	134	134-40	GEAR STUD
34	34-45	ROD CLAMP SCREW (2 REQ)	141	141-245	LEVER CAM FOLLOWE
35	35-40	CLICK TOUNGE	144	144-40	PRESET KNOB
36	36N-209	CLICK BUTTON	149	149-45	ROD CLAMP NUT (2 RE
36A	36A-40	CLICK BUTTON WASHER	149A	149-200	HEX NUT (2 REQ.)
37	37-40	FRAME POST	156	156-245	DRAG COVER
37A	37A-246	TOP SPACER BAR	161	161-25	FREE SPOOL BUTTON
38	39.5	LOWER R.S. PLATE SCREW (2 REQ.)	161A	161-40	STRIKE BUTTON ASSE
38A	38-40	R.S. POST SCREW (2 REQ.)	162	162-50	FREE SPOOL BUTTON
38B	32-22	UPPER R.S. PLATE SCREW (2 REQ.)	162A	162-50	STRIKE BUTTON SPRIN
39	39.9	L.S. POST SCREW (3 REQ.)	183	183-246LH	FRAME ASSEMBLY
41A	41A-45	BEARING SPRING	195	195-40	GEAR STUD RETAINING

*NOT SHOWN