

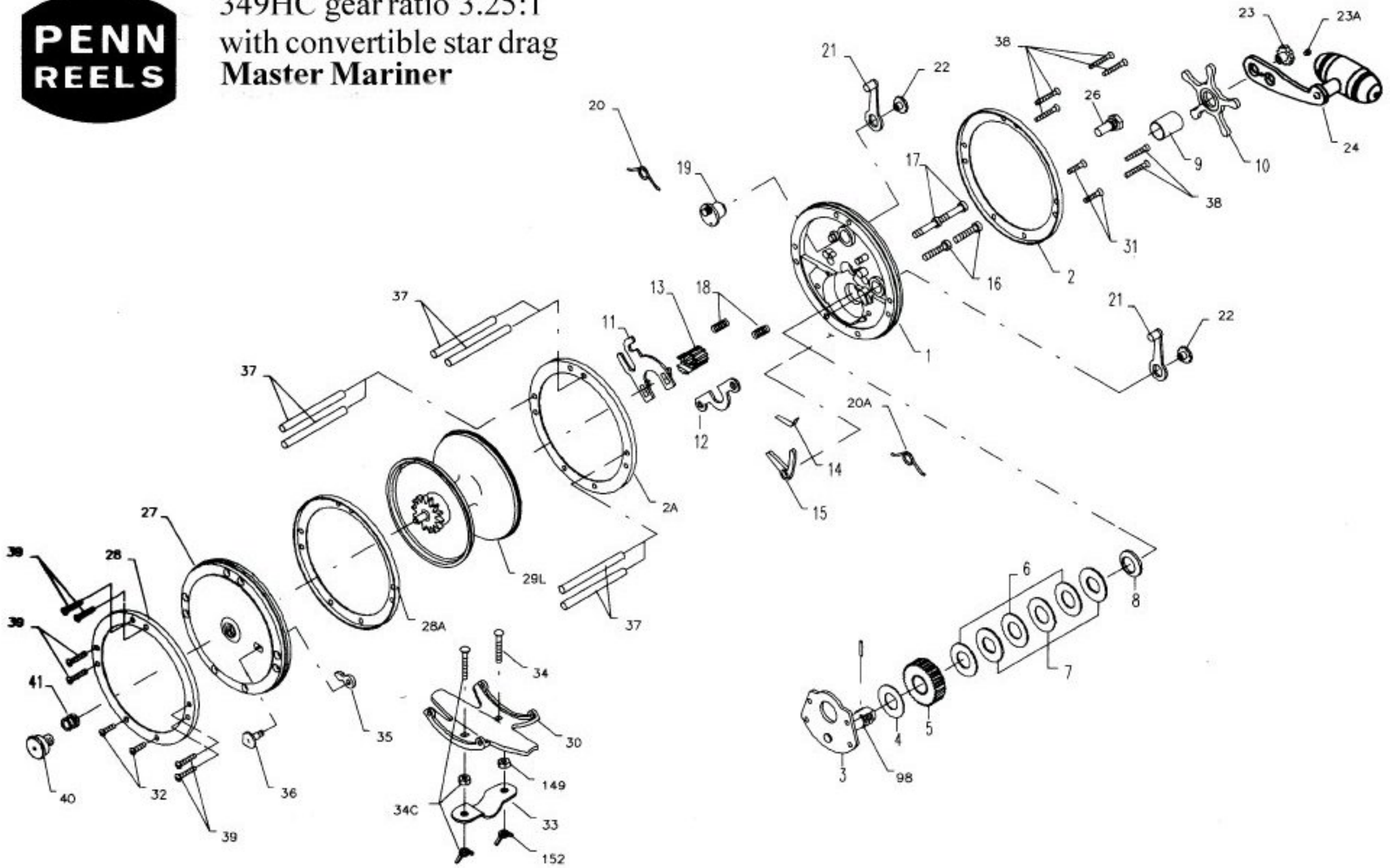

349HC gear ratio 3.25:1
with convertible star drag
Master Mariner



Penn Reel Parts list for:

Model: 349HC Master Mariner

convertible star drag 3.25:1 gear ratio vs 349 at 2.33:1

KEY PART

NO NO.	DESCRIPTION
1	1-349H R.S. PLATE
2	2-349 R.S. RING
3	3-349 BRIDGE W/ SLEEVE
4	4-349 FIBER WASHER
5	5-349H MAIN GEAR
6	6-349H DRAG WASHER
7	7-349H METAL DISC SET
8	8-349 TENSION SPRING
9	9-349 SPACING SLEEVE
10	10-349 STAR DRAG
11	11-349 ECCENTRIC JACK
12	12-349H PINION YOKE
13	13-349H PINION GEAR
14	14-349 DOG SPRING
15	15-349 DOG
16	16-60CH LOWER BRIDGE SCREW
17	17-60CH UPPER BRIDGE SCREW
18	18-349 CLUTCH SPRING
19	19-60 ECCENTRIC
20	20-60L ECCENTRIC SPRING
21	21-49 ECCENTRIC LEVER

KEY

NO NO.	DESCRIPTION
22	22-60CH ECCENTRIC SCREW
23	23-114 HANDLE SCREW
23A	110-60 HANDLE LOCK SCREW
24	24-349H COMPLETE HANDLE
25	25-114 KNOB, RIVET & OILER
26	26-349 R.S. BEARING
27	27-349 L.S. PLATE
28	28-349 L.S. RING
29M	29M-349 METAL SPOOL
30	30-349 STAND
31	32-18 R.S. STAND SCREW
32	32-18 L.S. STAND SCREW
33	33-49 ROD CLAMP
34	34C-49 CLAMP SCREW W/ NUTS
35	35-114 CLICK TONGUE
36	36-114H CLICK BUTTON
37	37-49 FRAME POST
38	39-9 R.S. POST SCREW
39	39-9 L.S. POST SCREW
40	40-349 L.S. BEARING
41	41-349 L.S. BEARING SPRING
98	98-349 BRIDGE SLEEVE