

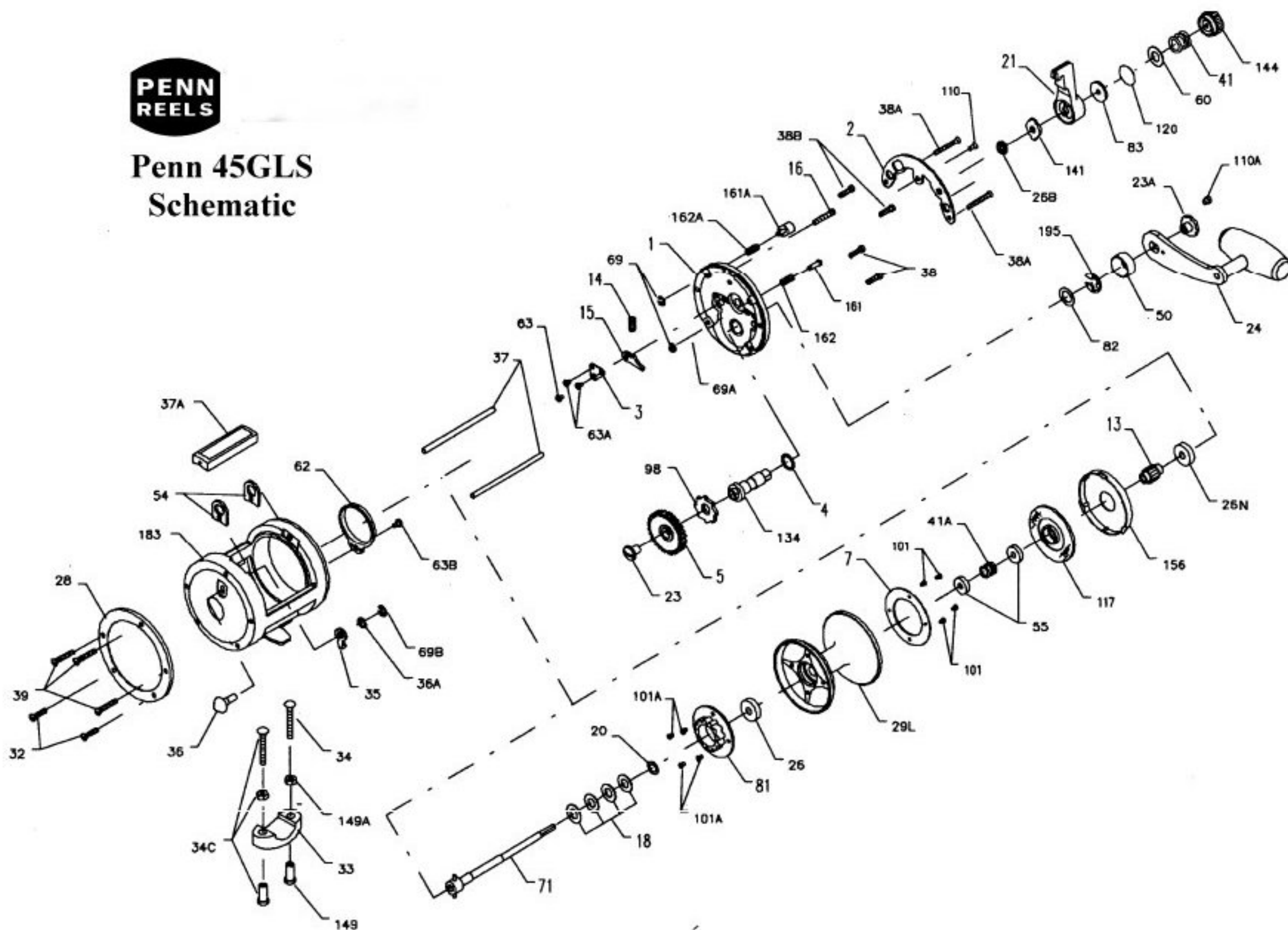

Penn 45GLS Schematic



Penn Reel Parts list for:

KEY	PART	NO.	NO.	DESCRIPTION
1	1-45			RIGHT SIDE PLATE
2	2-40			QUADRANT RING
3	3-40			DOG BRIDGE
4	4-40			GEAR STUD WASHER
5	5-45			MAIN GEAR
7	7-40			METAL DRAG WASHER
13	13N-45			PINION GEAR
14	14-40			DOG SPRING
15	15-40			DOG
16	16-9			TOP R.S. PLATE SCREW
18	18-40			CLUTCH DISC SPRING (4 REQ.)
20	20-40			THRUST WASHER
21	21-245		21-40 (old#)	DRAG LEVER ASSEMBLY
23	23-6CH			GEAR MOUNTING SCREW
23A	23-114			HANDLE SCREW
24	24-40P			HANDLE ASSEMBLY
26	26-40			L.S. SPOOL SPINDLE BALL BEARING
26N	26N-40			R.S. PLATE BALL BEARING
28	28-40			L.S. RING
29L	29L-40			SPOOL
32	32-310			LOWER PLATE SCREW (2 REQ.)
33	33-113			ROD CLAMP
34	34-45			ROD CLAMP SCREW (ONLY)
34C	34C-45			ROD CLAMP SCREW W/NUTS
35	35-40			CLICK TOUNGE
36	36N-209			CLICK BUTTON
36A	36A-40			CLICK BUTTON WASHER
37	37-40			FRAME POST (2 REQ.)
37A	37A-45			TOP SPACER BAR
38	39-5			LOWER R.S. PLATE SCREW (2 REQ.)
38A	38-40			R.S. POST SCREW (2 REQ.)
38B	32-22			UPPER R.S. PLATE SCREW (2 REQ.)
39	39-9			L.S. POST SCREW (2 REQ.)
41	41N-45			PRE-SET KNOB SPRING
41A	41A-45			BEARING SPRING

Model: 45GLS

KEY	PART	NO.	NO.	DESCRIPTION
50	50-40			GEAR STUD COVER
54	54-113			HARNES LUG (2 REQ.)
55	55-6			R.S. SPOOL SPINDLE BALL BEARING (2 REQ.)
60	60-40			LEVER BACKING WASHER
62	62-40			CLICK SPRING
63	63-349			LOWER DOG BRIDGE SCREW
63A	63-500S			UPPER DOG BRIDGE SCREW (2 REQ.)
63B	63-500S			CLICK SPRING SCREW
69	69B-50			STRIKE BUTTON RETAINING RING
69A	69B-50			FREE SPOOL BUTTON RETAINING RING
69B	69B-600			CLICK TONGUE RETAINING RING
71	71-40			SPOOL SPINDLE ASSEMBLY
81	81-40			CLICK RATCHET
82	82-40			HANDLE SHIM
83	83-40		83-40 (old#)	PRE-SET COLLAR
98	98-40			MAIN GEAR RATCHET
101	101-30			METAL DRAG WASHER SCREW (4 REQ.)
101A	101-30			CLICK RATCHET SCREW (4 REQ.)
110	110-50			QUADRANT RING SCREW
110A	110-60			HANDLE LOCK SCREW
117	117-45			DRIVE PLATE ASSEMBLY
120	120-245			O'RING (not used with original cam lever#)
134	134-40			GEAR STUD
141	141-40		141-40 (old#)	LEVER CAM FOLLOWER
144	144-40			PRE-SET KNOB
149	149-45			ROD CLAMP NUT (2 REQ.)
149A	149-200			HEX NUT (2 REQ.)
156	156-40			DRAG COVER
161	161-25			FREE SPOOL BUTTON
161A	161-40			STRIKE BUTTON
162	162-50			FREE SPOOL BUTTON SPRING
162A	162-50			STRIKE BUTTON SPRING
183	183-45			FRAME
195	195-40			GEAR STUD RETAINING RING