

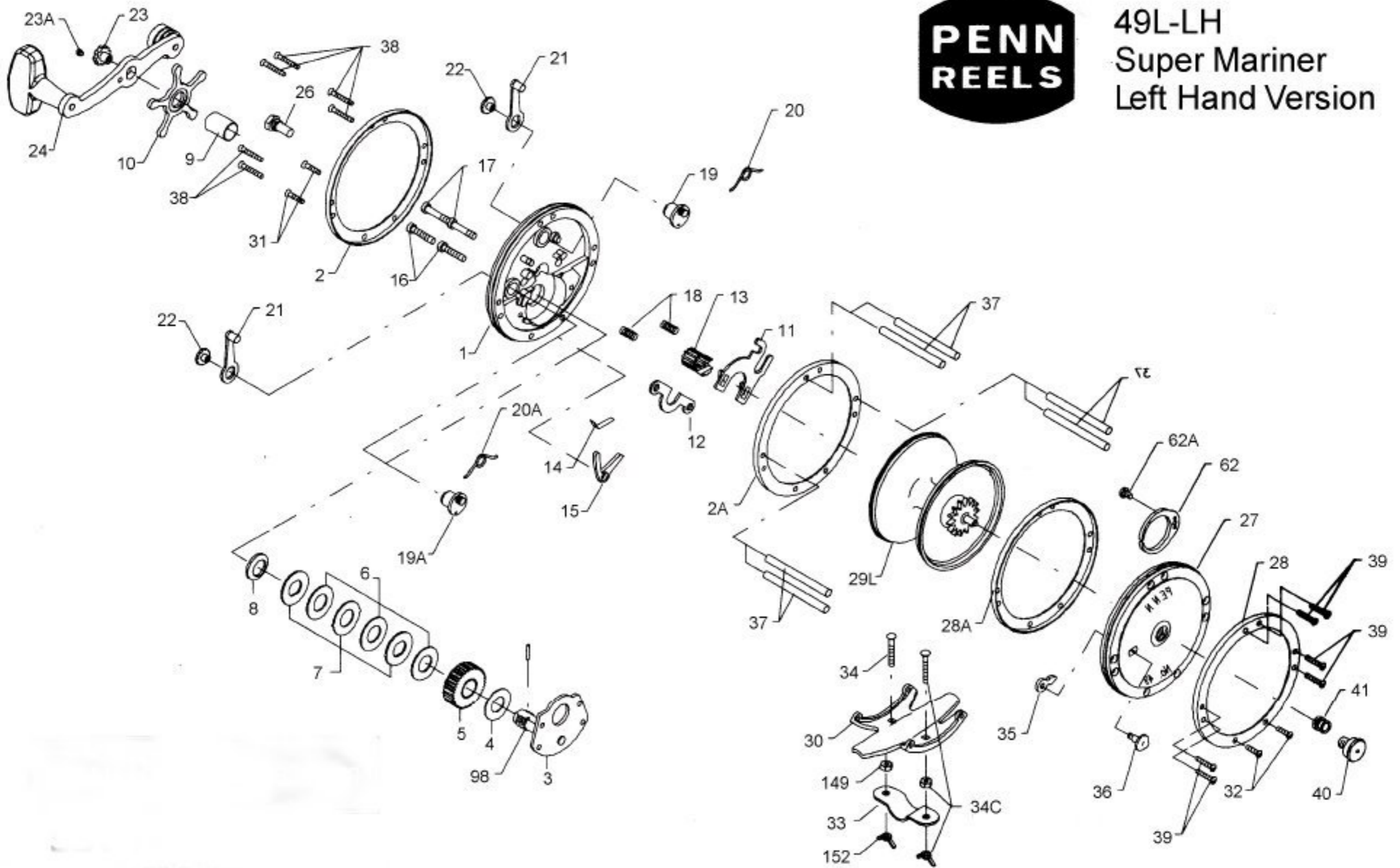

49L-LH Super Mariner Left Hand Version



Penn Reel Parts list for:

KEY PART

NO	NO.	DESCRIPTION
1	1-49LH	LEFT SIDE PLATE (LEFT HAND VERSION)
2	2-49-OL	OUTER RING
2A	2-49-I	INNER RING
3	3-49LH	BRIDGE W/ SLEEVE (LEFT HAND VERSION)
4	4-60	FIBER WASHER
5	5-49LH	MAIN GEAR (LEFT HAND VERSION)
6	6-49	DRAG WASHER (3 REQ.)
7	7C-49	METAL WASHER SET
8	8-60	TENSION SPRING
9	9-60	SPACING SLEEVE
10	10-49LH	STAR DRAG WHEEL (LEFT HAND VERSION)
11	11-49	ECCENTRIC JACK
12	12-60	PINION YOKE
13	13-49LH	PINION (LEFT HAND VERSION)
14	14-60	DOG SPRING
15	15-49LH	DOG (LEFT HAND VERSION)
16	16-60CH	LOWER BRIDGE SCREW (2 REQ.)
17	17-60CH	UPPER BRIDGE SCREW (2 REQ.)
18	18-60	CLUTCH SPRING (2 REQ.)
19	19-60	ECCENTRIC CAM
19A	19-49	ECCENTRIC CAM
20	20-60LH	ECCENTRIC SPRING (LEFT HAND VERSION)
20A	20-155	ECCENTRIC SPRING
21	21-49	ECCENTRIC LEVER

Model: 49L-LH Super Mariner (LEFT Hand Version)

KEY PART

NO	NO.	DESCRIPTION
22	22-60CH	ECCENTRIC SCREW (2 REQ.)
23	23-60	HANDLE SCREW
23A	110-60	HANDLE LOCK SCREW
24	24-49	HANDLE
26	26-60	LEFT SIDE BEARING
27	27-49	RIGHT SIDE PLATE
28	28-49-O	OUTER RIGHT SIDE RING
28A	2-49-I	INNER RING
29L	29L-49	SPOOL
30	30-49	STAND
31	39-3	RIGHT/RIGHTSTAND SCREW
33	33-49	ROD CLAMP
34	34-49	ROD CLAMP SCREWS (2 REQ.)
34C	34C-49	ROD CLAMP SCREW W/ NUTS
35	35-60	CLICK TONGUE
36	36-60CH	CLICK BUTTON
37	37-49	POST (6 REQ.)
38	39-9	RIGHT/LEFT SIDE POST SCREW (6 REQ. PER SIDE)
40	40-60	RIGHT SIDE BEARING
41	41-60	RIGHT SIDE BEARING SPRING
62	62-309	CLICK SPRING
62A	63-209	CLICK SPRING SCREW
98	98-60LH	GEAR SLEEVE (LEFT HAND VERSION)
149	149-200	HEX NUT
152	152-200	WING NUT