

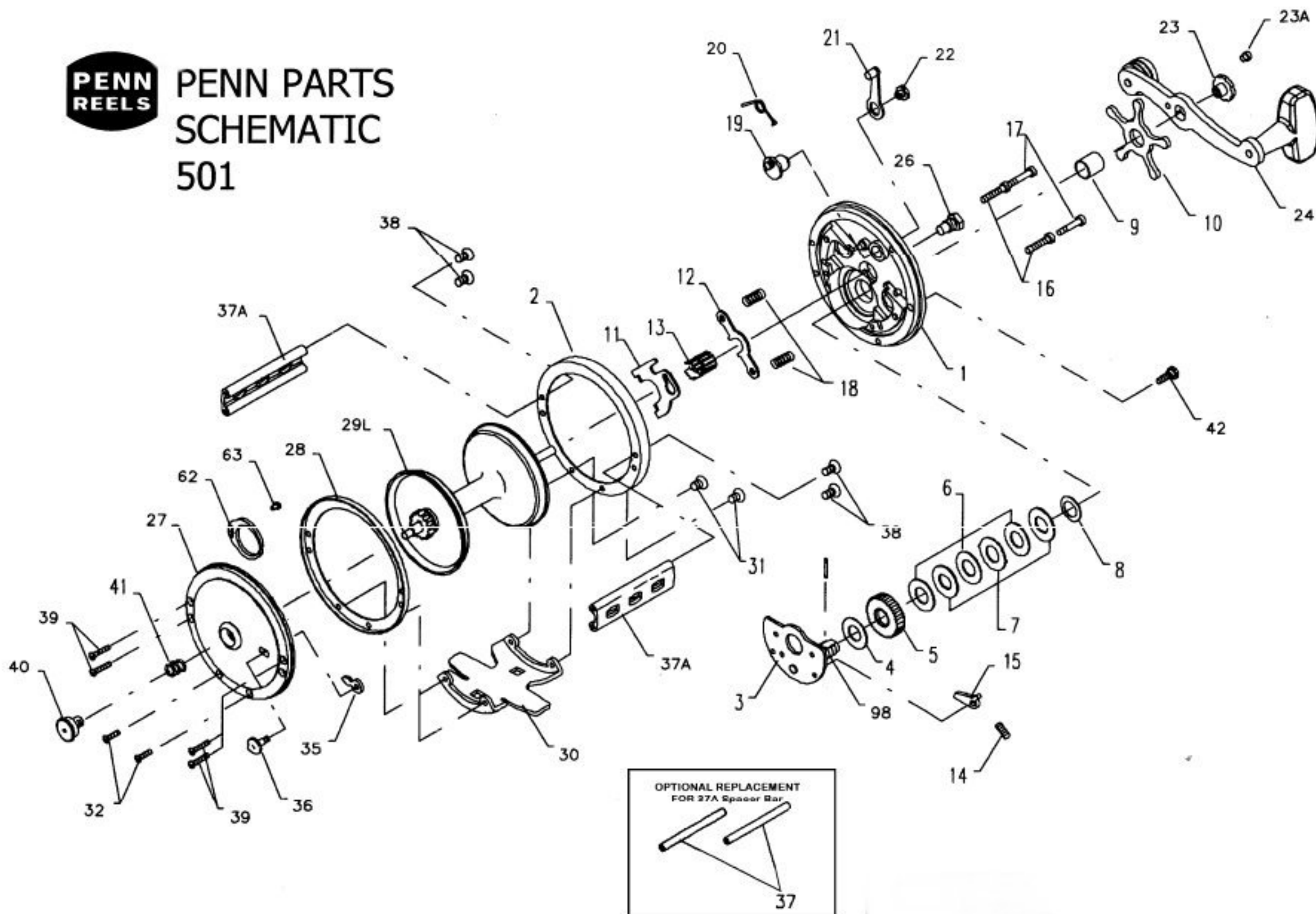

# PENN PARTS SCHEMATIC 501



## Penn Reel Parts list for:

## Model: 501

KEY NO	PART NO.	DESCRIPTION	KEY NO	PART NO.	DESCRIPTION
1	1-501	RIGHT SIDE PLATE	26	26-155	RIGHT SIDE BEARING
2	2-250	LEFT SIDE RING	27	27-500	LEFT SIDE PLATE
3	**3-500S	BRIDGE W/ SLEEVE	28	28-250	L.S. RING (INNER)
4	4-60	FIBER WASHER	29L	29L-501	SPOOL
5	5-500	MAIN GEAR	30	30-49	STAND
6	6-309	DRAG WASHER (3 REQ.)	31	31-19	RIGHT SIDE STAND SCREW (2 REQ.)
7	7C-500	METAL WASHER SET	32	32-16CH	LEFT SIDE STAND SCREW
8	8-60	TENSION SPRING	33	33-49	ROD CLAMP
9	9-60	SPACING SLEEVE	34	34-49	CLAMP SCREW
10	***10-505	STAR DRAG WHEEL	34C	34C-49	CLAMP SCREW W/ NUTS
11	11-99	ECCENTRIC JACK	35	35-60	CLICK TOUNGE
12	12-500	PINION YOKE	36	36-60CH	CLICK BUTTON
13	13-500	PINION	37	37-180	POST (OPTIONAL) USE 2 IN PLACE OF 1 SPACER BAR
14	14-500	DOG SPRING	37A	37A-508	SPACER BAR
15	15-500	DOG	38	38-7	R.S. SPACER SCREW (4 REQ.)
16	16-60CH	LOWER BRIDGE SCREW	39	39-5	J.S. SPACER SCREW (4 REQ.)
17	17-60CH	UPPER BRIDGE SCREW	40	40-60	LEFT SIDE BEARING
18	18-60	CLUTCH SPRING	41	41-60	BEARING SPRING
19	19-250	ECCENTRIC	42	129-200	TAKE APART THUMB SCREW
20	20-60L	ECCENTRIC SPRING	62	62-309	CLICK SPRING
21	21-66	ECCENTRIC LEVER	63	63-209	CLICK SPRING SCREW
22	22-99	ECCENTRIC SCREW	98	****98-505	GEAR SLEEVE
23	23-60	HANDLE SCREW	149A	149-200	HEX NUT (2 REQ.)
23A	110-60	HANDLE LOCK SCREW	*	152-200	CLAMP WING NUT (501-2 REQ.)
24	24-155	HANDLE			

\* Not Shown

\*\* Fine tooth sleeve, older reels take a 3-500 with a coarse tooth sleeve, bridge will still be stamped 3500s

\*\*\* Fine tooth star drag, older reels take a 10-60 or a 10-140 with a coarse thread

\*\*\*\* Fine tooth gear sleeve, older reels take a 98-60 with a coarse thread