

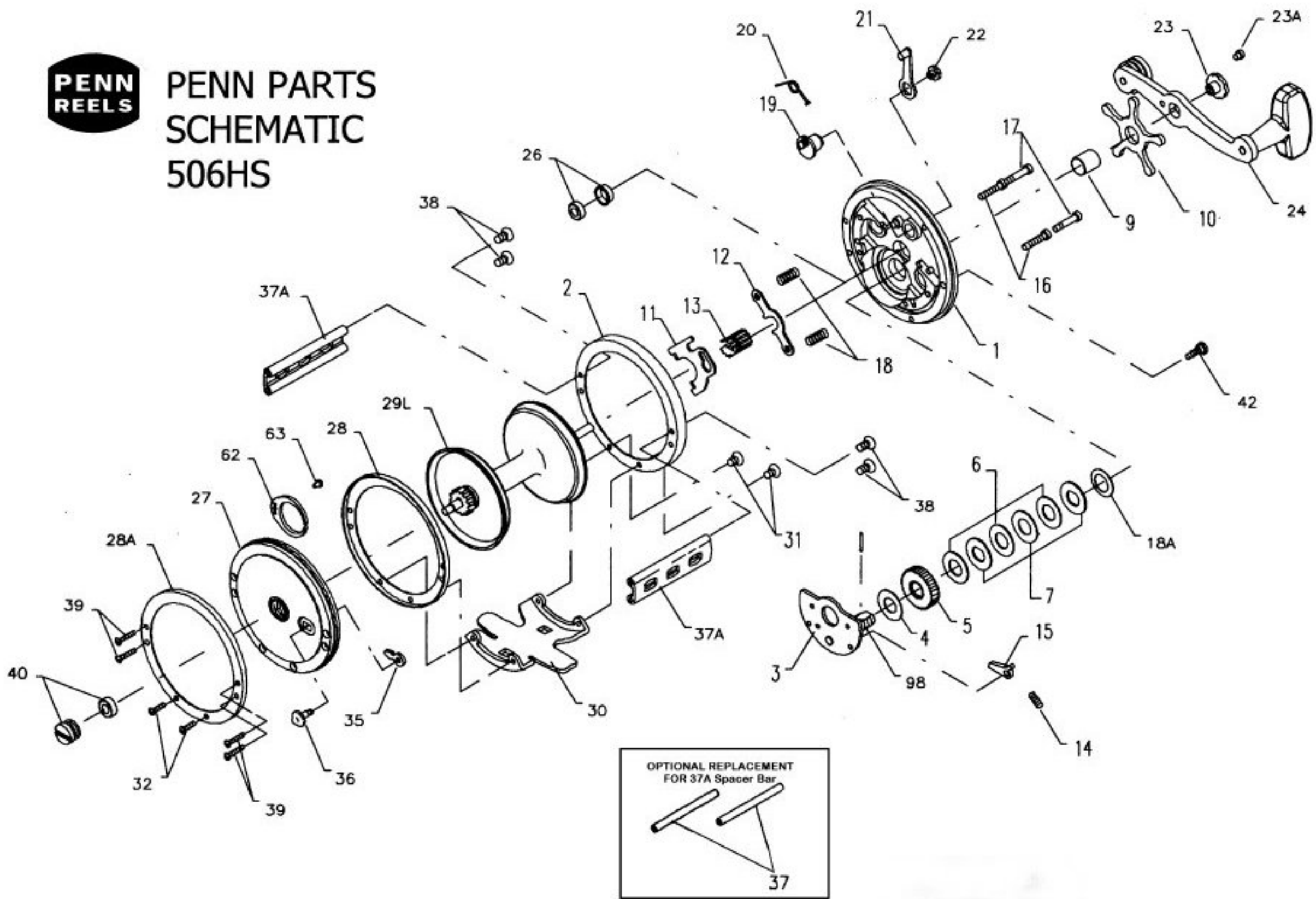

PENN PARTS SCHEMATIC 506HS



Penn Reel Parts list for:

Model: 506HS

KEY PART

NO	NO.	DESCRIPTION
1	1-506	RIGHT SIDE PLATE
2	2-250	RIGHT SIDE RING
3	3-505	BRIDGE W/ SLEEVE
4	4-60	FIBER WASHER
5	5-505	MAIN GEAR
6	6-309	WASHER
7	7C-500	WASHER (METAL SET)
8	8-60	TENSION SPRING
9	9-60	SPACING SLEEVE
10	10-505	STAR DRAG
	11-99	ECCENTRIC JACK
12	12-500	PINION YOKE
13	13-505	PINION GEAR
14	14-500	DOG SPRING
15	15-500	DOG
16	16-60CH	LOWER BRIDGE SCREW
17	17-60CH	UPPER BRIDGE SCREW
18	18-60	CLUTCH SPRING
18A	18-505	DRAG SPRING DISC
19	19-250	ECCENTRIC
20	20-60L	ECCENTRIC SPRING
21	21-285	ECCENTRIC LEVER
22	22-99	ECCENTRIC SCREW
23	23-60	HANDLE SCREW
23A	110-60	HANDL LOCK SCREW
24	24-66	HANDLE (COMPLETE)

KEY PART

NO	NO.	DESCRIPTION
26	26-113H	RIGHT SIDE BEARING
27	27-505	LEFT SIDE PLATE
28	28-110-I	LEFT SIDE PLATE (INNER)
28A	28-110-O	LEFT SIDE RING (OUTER)
29L	29L-506	ALUMINUM SPOOL
30	30-49	STAND
31	31-19	R.S. STAND SCREW
32	39-3	L.S. STAND SCREW
33	33-49	ROD CLAMP
34	34-49	CLAMP SCREW (2 REQ.)
34C	34C-49	CLAMP SCREW W/ NUTS
35	35-60	CLICK TONGE
36	36-209	CLICK BUTTON
37	37-180	POST (OPTIONAL) USE 2 IN PLACE OF 1 SPACER BAR
37A	37A-506	SPACER BAR
38	38-7	RIGHT SIDE POST SCREW
39	39-9	LEFT SIDE POST SCREW
40	40A-210	LEFT SIDE BEARING
42	129-200	TAKE APART THUMB SCREW
62	62-309	CLICK SPRING
63	63-209	CLICK SPRING SCREW
98	98-505	GEAR SLEEVE
149	149-45	CLAMP NTU (2 REQ.)
149A	149-200	HEX NUT (2 REQ.)
*	152-200	CLAMP WING NUT (2 REQ.)

* Not Shown