

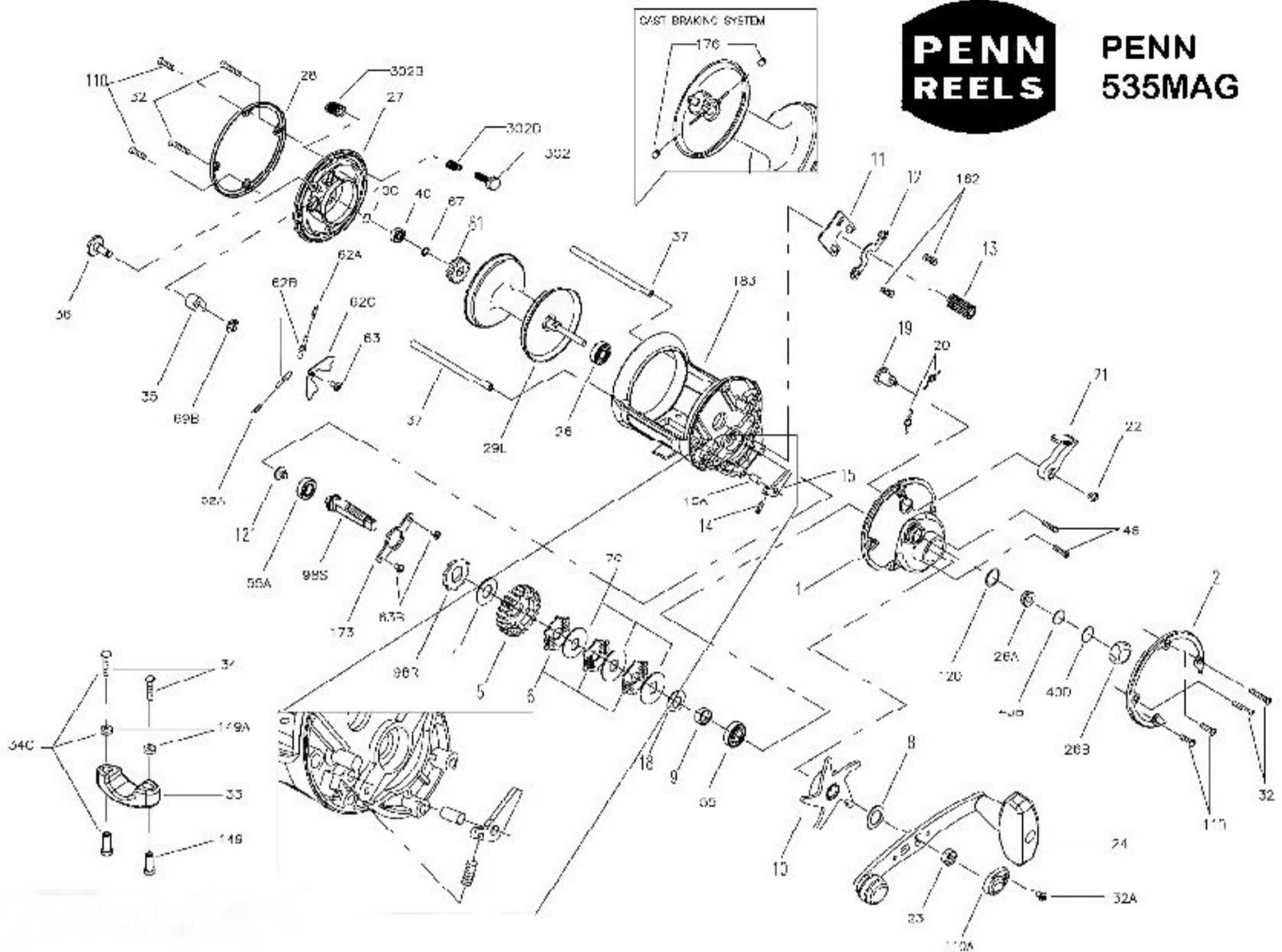

**PENN
535MAG**



Penn Reel Parts list for:

Model: 535MAG

KEY PART

NO	NO.	DESCRIPTION
1	1-535	RIGHT SIDE PLATE
2	2-535	RIGHT SIDE PLATE
4	4-60	FIBER WASHER
5	5-545MAG	MAIN GEAR
6	6-49MAG	FRICITION DRAG WASHER (3 REQ.)
7C	86-49L	METAL DRAG WASHER (3 REQ.)
8	8-60	TENSION SPRING WASHER
9	9-555	SPACING SLEEVE
10	10N-555	DRAG STAR
11	11-535	ECCENTRIC JACK
12	12-555	PINON YOKE
13	13-545	PINON GEAR
14	14-535	DOG SPRING
15	15-535	DOG
15A	158-535	DOG PIN
18	18-505	TENSION SPRING WASHER
19	19-535	ECCENTRIC
20	20-155	ECCENTRIC SPRING (2 REQ.)
21	21-310	ECCENTRIC LEVER
22	22-310	ECCENTRIC SCREW
23	23-555	HANDLE NUT
24	24-525	HANDLE
26	26-25	R.S. SCREW BALL BEARING
26A	26-555	RIGHT SIDE BUSHING
26B	26B-555	SPOOL TENSION CONTROL CAP
27	27-535MAG	LEFT SIDE PLATE
28	28-535	LEFT SIDE RING
29L	29L-535	ALUMINUM SPOOL ASSEMBLY
32	32-310	FRAME POST SCREW (4 REQ.)
32A	32-15	HANDLE LOCK SCREW
33	33-113	ROD CLAMP
34	34-45	ROD CLAMP SCREW (2 REQ.)

KEY PART

NO	NO.	DESCRIPTION
34C	34C-45	ROD CLAMP SCREW W/ NUTS
35	35-310N	CLICK TOUNGE
36	36-555	CLICK BUTTON
37	37-535	FRAME POST (2 REQ.)
40	40-320	L.S. SPOOL BALL BEARING
40B	40C-555	METAL THRUST WASHER
40C	40C-310	METAL THRUST WASHER
40D	40D-555	RUBBER THRUST WASHER
46	46-4300	SIDE PLATE SCREW (2 REQ.)
55	55-12H	BALL BEARING
55A	20-722	BALL BEARING
62A	62-545	CLICK SPRING (2 REQ.)
62B	62B-310	CLICK PIN (2 REQ.)
62C	62C-310	CLICK SPRING COVER
63	63-500S	CLICK SPRING SCREW
63B	63-330	BEARING RETAINER SCREW (2 REQ.)
67	67-9	LOCK RING
69B	69B-600	RETAINING RING
81	81-555	CLICK RATCHET
98R	98-555	MAIN GEAR RATCHET
98S	134-555	GEAR STUD
110	110-50	SIDE PLATE SHORT SCREW (4 REQ.)
110A	110A-555	HANDLE NUT LOCK CAP
120	120-113H	O-RING
121	121-525	BEARING SCREW
149	149-45	ROD CLAMP NUT (2 REQ.)
149A	149-200	ROD CLAMP HEX NUT (2 REQ.)
162	162-130	CLUTCH SPRING (2 REQ.)
173	173-555	BEARING RETAINER
176	176-555	CASTING BRAKES (2 REQ.)
183	183-535	FRAME
302	302-535MAG	MAGNET HOUSING
302B	302B-525MAG	MAGNET KNOB