

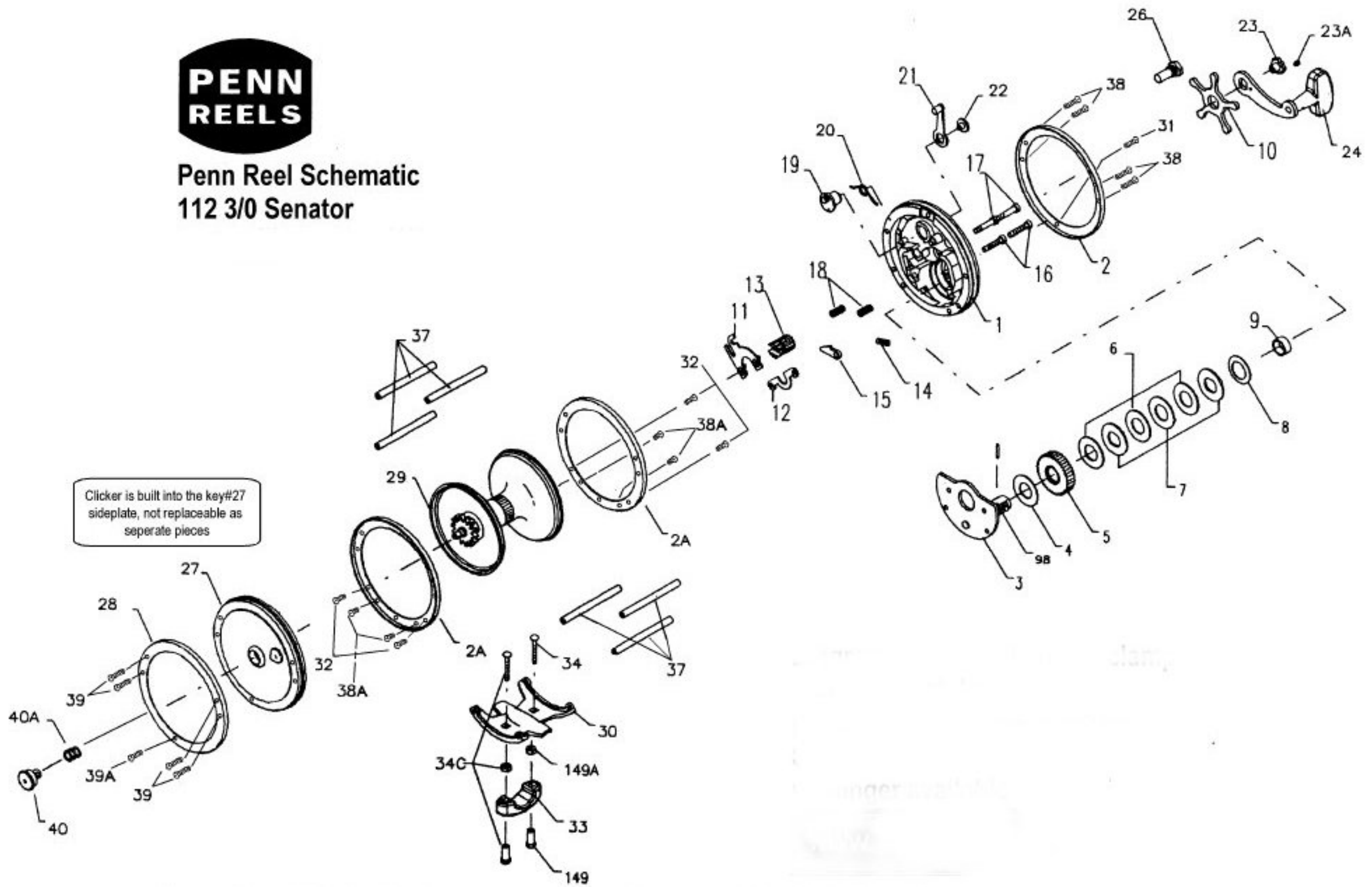

**Penn Reel Schematic
112 3/0 Senator**



Clicker is built into the key#27 sideplate, not replaceable as separate pieces

Penn Reel Parts list for:

Model: 112 3/0 Senator

KEY NO	PART NO.	DESCRIPTION
1	1-112	RIGHT SIDE PLATE
2	2-111-O	OUTER RIGHT SIDE RING
2A	2-111-I	INNER RING (2)
3	3-66	BRIDGE W/ SLEEVE
4	4-60	FIBER WASHER
5	5-66	MAIN GEAR
6	6-113	DRAG WASHER (3)
7	7C-60	METAL DRAG WASHER SET (3)
8	8-60	TENSION SPRING
9	9-66	SPACING SLEEVE
10	10-60	STAR DRAG WHEEL
11	11-60	ECCENTRIC JACK
12	12-60	PINION YOKE
13	13-49	PINION
14	14-99	DOG SPRING
15	15-99	DOG
16	16-60CH	LOWER BRIDGE SCREW (2)
17	17-60CH	UPPER BRIDGE SCREW (2)
18	18-60	CLUTCH SPRING (2)
19	19-250	ECCENTRIC
20	20-60L	ECCENTRIC SPRING
21	21-66	ECCENTRIC LEVER
22	22-99	ECCENTRIC SCREW
23	23-60	HANDLE SCREW
23A	110-60	HANDLE LOCK SCREW

KEY NO	PART NO.	DESCRIPTION
24	24-155	HANDLE
26	26-60	R.S. BEARING
27	27-111	LEFT SIDE PLATE w/clicker
28	2-111-O	OUTER LEFT SIDE RING
29	29M-112	SPOOL
30	30-112	STAND
31	39-3	R.S. OUTER STAND SCREW (1)
32	32-15	INNER R/L STAND SCREWS (4)
33	33-200	ROD CLAMP (ORIG. METAL)
	33-113	ROD CLAMP (PLASTIC)
34	34-200	CLAMP SCREW (2)
34C	34C-200	ROD CLAMP SCREW W/ NUTS (for metal)
	34C-45	ROD CLAMP SCREW W/ NUTS (for plastic)
37	37-113	FRAME POST (6)
38	39-9	R.S. POST SCREW (4)
38A	39-10	INNER R/L POST SCREW (8)
39	39-3	L.S. POST SCREW (4)
39A	32-17	L.S. OUTER STAND SCREW (1)
40	40-60	L.S. BEARING
41	41-60	L.S. BEARING SPRING
98	98-60	GEAR SLEEVE
149	149-45	ROD CLAMP NUT (2)
149A	149-200	HEX NUT (2)