

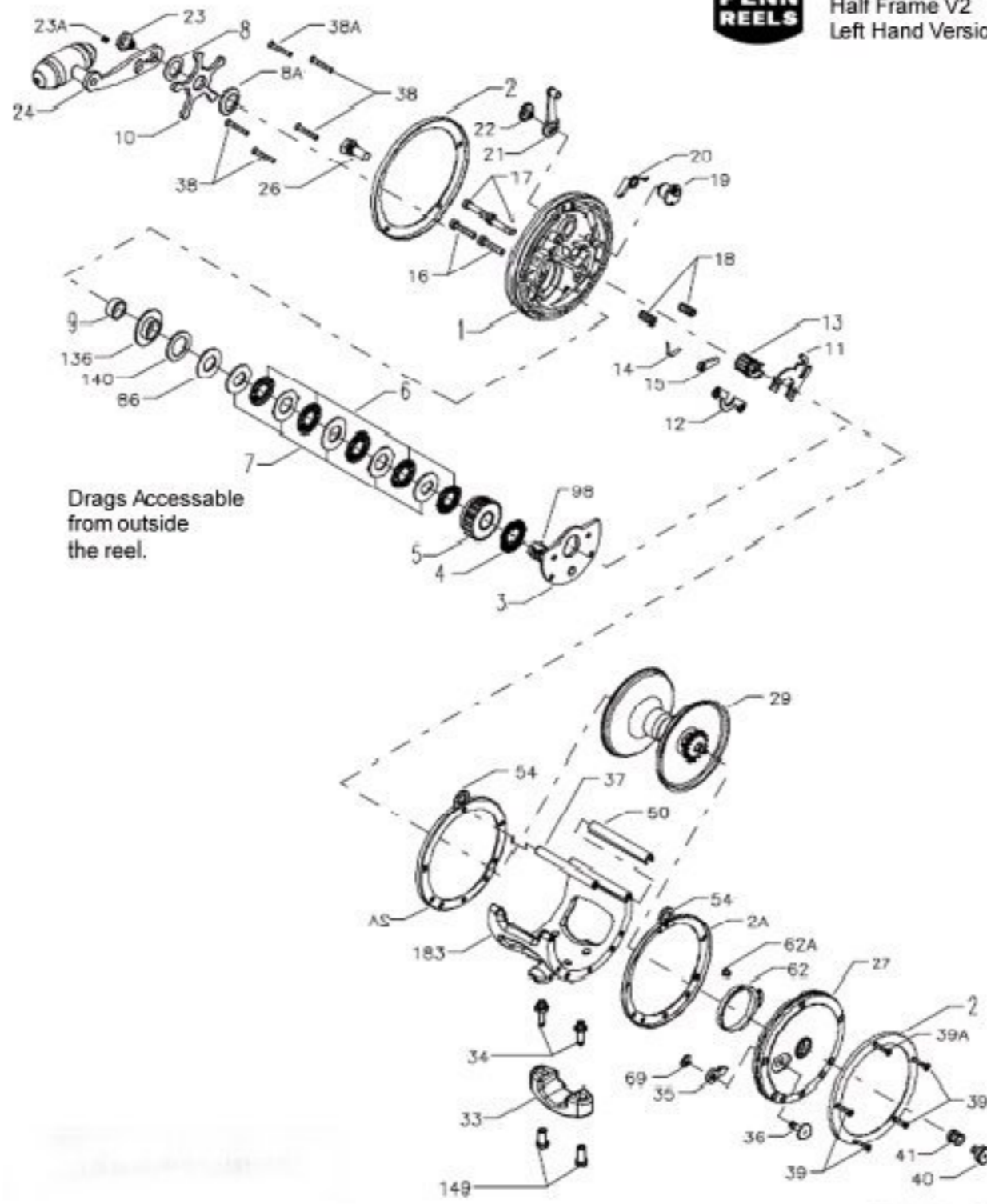

Penn 114-LH 6/0  
Half Frame V2  
Left Hand Version



407-114HF 9/01

Penn Reel Parts list for:

Model: 114-LH HALF Frame 6/0 Version 2, 2002 (LEFT HAND VERSION)

KEY NO.	PART NO.	DESCRIPTION	KEY NO.	PART NO.	DESCRIPTION
	1 1-114	Right Side Plate	24	24-57	Handle
	2 2N-114	Right Side Ring	26	26-114	Bearing Right Side
	2A 2-114I	Inner Ring	27	27-114	Left Side Plate
	3 3-114LH	Bridge with Sleeve (LEFT HAND VERS	29	29L-114	Spool
	4 4-114	Fiber Washer	33	33-340	Rod Clamp
	5 5-114LH	Main Gear (LEFT HAND VERSION)	34	34-10KG	Clamp Screw (2 Required)
	6 6-114	Drag Washer	35	35-114	Click Tongue
	7 7C-114	Metal Drag Washer Set	36	36-114H	Click Button
	8 8-114	Tension Spring	37	37-114	Frame Post
	8A 8-115	Tension Spring	38	38-114	R.S. Frame Screw (4req)
	9 9N-114	Spacing Sleeve	38A	39-12	R.S. Post Screw
	10 10-114	Star Drag Wheel	39	39-114	L.S. Frame Screw (4 req)
	11 11-114	Eccentric Jack	39A	32-21	L.S. Post Screw
	12 12-114	Pinion Yoke	40	40-114	L.S. Bearing
	13 13-114LH	Pinion (LEFT HAND VERSION)	41	41-114	Bearing Spring
	14 14-114	Dog Spring	50	50-114HF	Frame Shield
	15 15-114	Dog	54	54-114	Harness Lug (2 Required)
	16 16-114	Bridge Screw Lower (2 Required)	62	62-114	Click Spring
	17 17-114	Bridge Screw Upper (2 Required)	62A	63-209	Click Spring Screw
	18 18-114	Clutch Spring	69	69B-600	Retaining Ring
	19 19-114	Eccentric	86	86-114L	Metal Drag Washer
	20 20-114	Eccentric Spring	98	98-114LH	Gear Sleeve (LEFT HAND VERSION)
	21 21-114	Eccentric Lever	136	136-114	Pressure Plate Washer
	22 23-60	Eccentric Screw	140	140-114	Felt Washer
	23 23-116	Handle Screw	149	149-45	Clamp Nut (2 Required)
	23A 110-60	Handle Lock Screw	183	183-114HF	Frame