

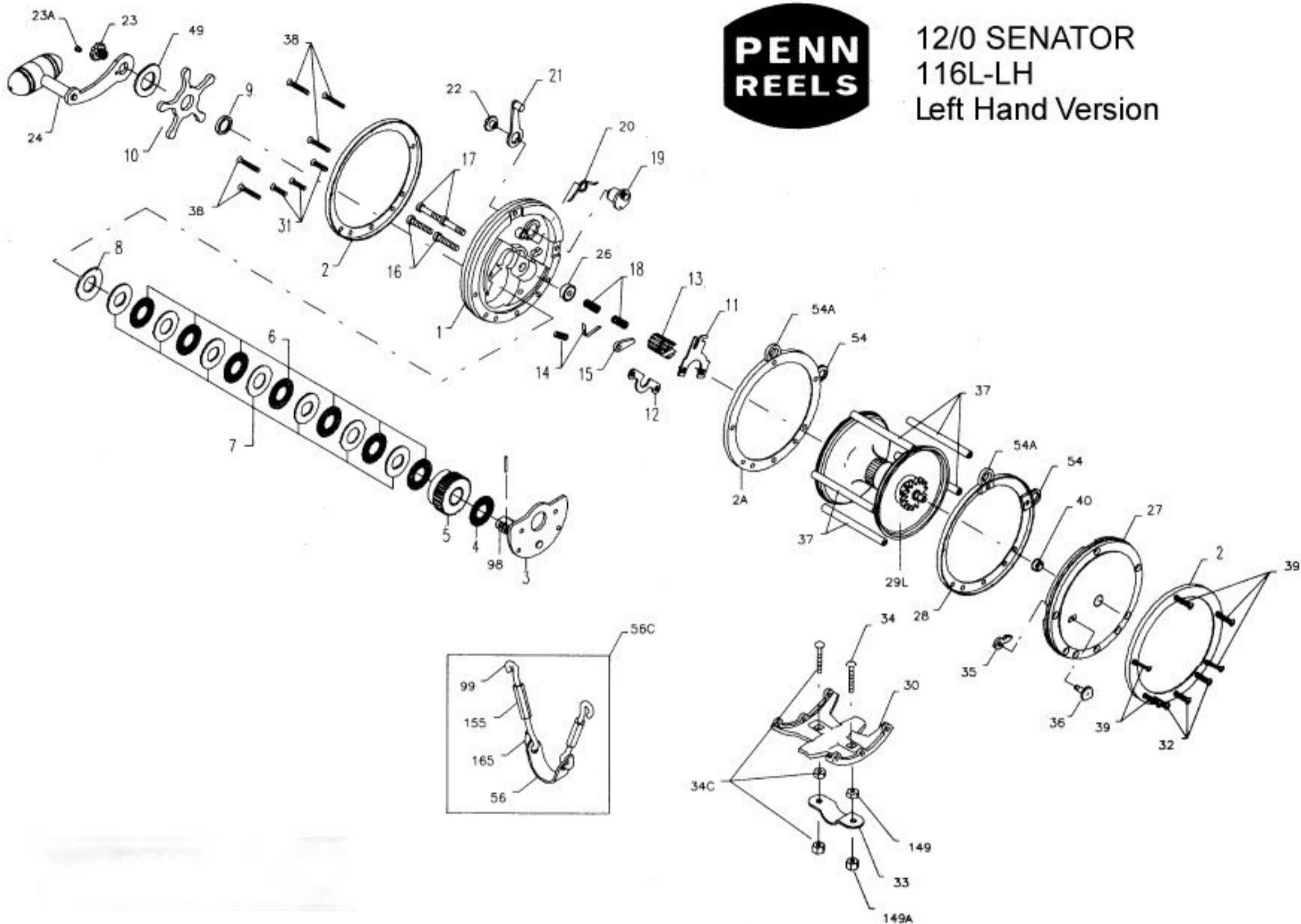

**12/0 SENATOR
116L-LH
Left Hand Version**



Penn Reel Parts list for:

Model: 116L-LH Senator (LEFT HAND Version)

KEY NO	PART NO.	DESCRIPTION
1	1-116LH	LEFT SIDE PLATE (LEFT HAND VERSION)
2	2-116-O	OUTER RING (2 REQ.)
2A	2-116-I	INNER RING SIDE RING
3	3-116LH	BRIDGE W/ SLEEVE (LEFT HAND VERSION)
4	4-116	FIBER WASHER
5	5-116LH	MAIN GEAR (LEFT HAND VERSION)
6	6-116	DRAG WASHER (7 REQ.)
7C	7c-116	METAL DRAG WASHER SET
8	8-116	TENSION SPRING
9	9-116	SPACING SLEEVE
10	10-116	STAR DRAG WHEEL
11	11-116	ECCENTRIC JACK
12	12-116	PINION YOKE
13	13-116LH	PINION (LEFT HAND VERSION)
14	14-116	DOG SPRING
15	15-116	DOG
16	16-114	LOWER BRIDGE SCREW (2 REQ.)
17	17-114	UPPER BRIDGE SCREW (2 REQ.)
18	18-114	CLUTCH SPRING (2 REQ.)
19	19-115	ECCENTRIC
20	20-114	ECCENTRIC SPRING
21	21-116	ECCENTRIC LEVER
22	22-60	ECCENTRIC SCREW
23	23-116	HANDLE SCREW
23A	110-60	HANDLE LOCK SCREW
24	24-116	HANDLE
26	26-116	LEFT SIDE BEARING

KEY NO	PART NO.	DESCRIPTION
27	27-116	RIGHT SIDE PLATE
28	28-116-I	INNER RIGHT SIDE RING
29L	29L-116	SPOOL
30	30-116	STAND
31	39-12	R.S. STAND SCREW
32	32-21	L.S. STAND SCREW
33	33-116	ROD CLAMP
*	33-130ST	RINGED ROD CLAMP (OPTIONAL)
34	34-116	CLAMP SCREW
34C	34c-116	CLAMP SCREW W/ NUTS
35	35-115	CLICK TONGUE
36	36-115	CLICK BUTTON
37	37-116	FRAME POST (8 REQ.)
38	39-13	LEFT/RIGHT SIDE POST SCREW (8 REQ. per side)
40	26-116	RIGHT SIDE BEARING
49	49-116	HANDLE SPACER
54	54-114	HARNES LUG (2 REQ.)
54A	54-116	HARNES LUG (2 REQ.)
56	56-116	ROD BRACE
56C	56C-116	ROD BRACE (COMPLETE)
56P*	56P-117	ROD BRACE PAD
98	98-116LH	GEAR SLEEVE (LEFT HAND VERSION)
99	99-116	HOOK SCREW L.H. THREAD (2 REQ.)
149	149-116L	HEX NUT (2 REQ.)
149A	149-116H	CLAMP NUT (2 REQ.)
155	155-116	TURNBUCKLE (2 REQ.)
165	165-116	HOOK SCREW L.H. THREAD (2 REQ.)

*Not Shown