

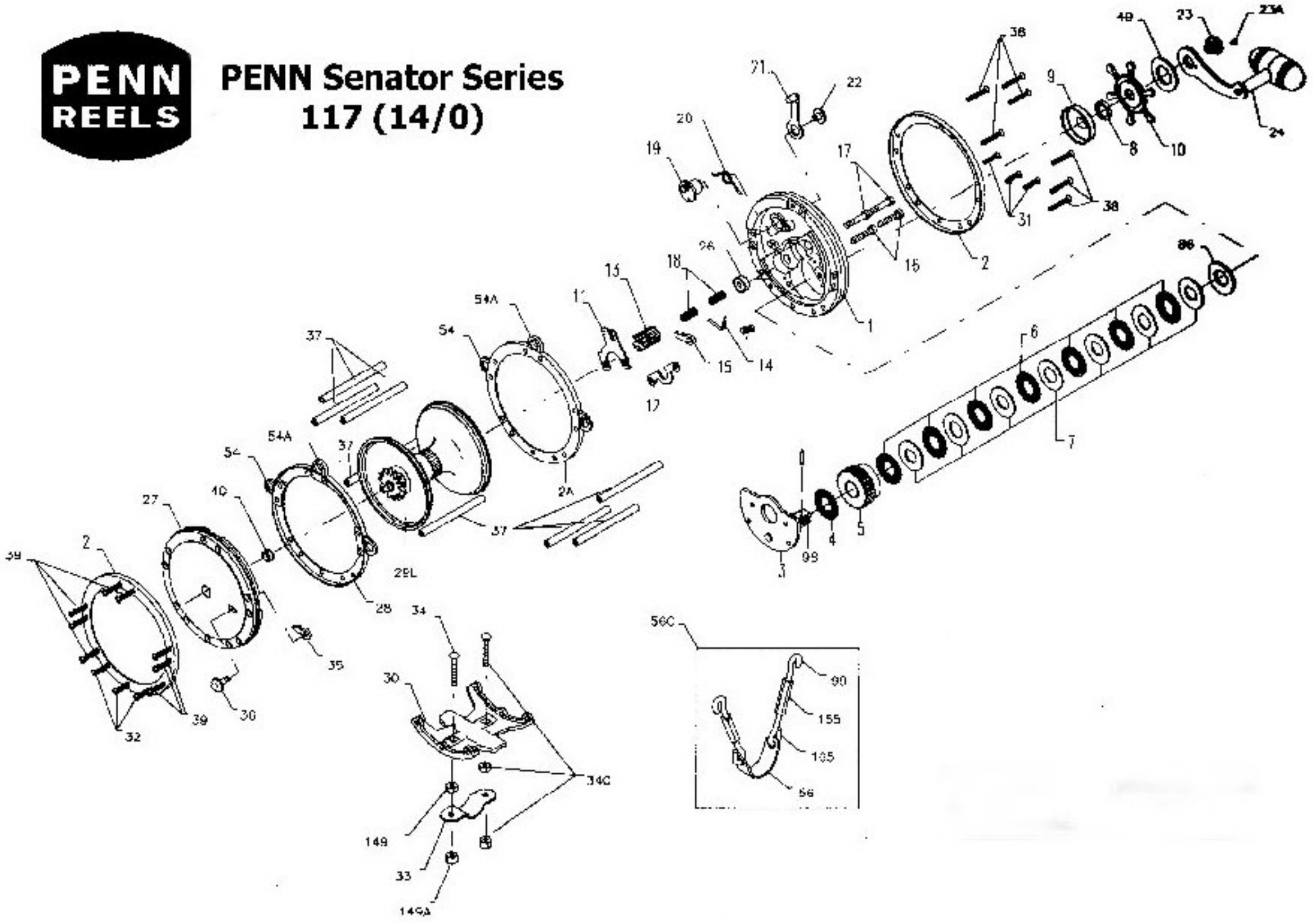

PENN Senator Series 117 (14/0)



Penn Reel Parts list for:

Model: 117L (14/0)

KEY PART

NO	NO.	DESCRIPTION
1	1-117	RIGHT SIDE PLATE
2	2-117-0	OUTER RIGHT SIDE RING (2 REQ.)
2A	2-117-1	INNER PLATE SIDE RING (2 REQ.)
3	3-117	BRIDGE W/ SLEEVE
4	4-117	FIBER WASHER
5	5-117	MAIN GEAR
6	6-117	DRAG WASHER (7 REQ.)
7C	7c-117	METAL DRAG WASHER SET
8	8-117	TENSION SPRING
10	10-117	STAR DRAG WHEEL
11	11-116	ECCENTRIC JACK
12	12-116	PINION YOKE
13	13-117	PINION
14	14-117	DOG SPRING
15	15-117	DOG
16	16-114	LOWER BRIDGE SCREW (2 REQ.)
17	17-114	UPPER BRIDGE SCREW (2 REQ.)
18	18-114	CLUTCH SPRINGS (2 REQ.)
19	19-115	ECCENTRIC
20	20-114	ECCENTRIC SPRING
21	21-117	ECCENTRIC LEVER
22	22-60	ECCENTRIC SCREW
23	23-116	HANDLE SCREW
23A	110-60	HANDLE LOCK SCREW
24	24-117	HANDLE
26	26-117	RIGHT SIDE BEARING

KEY PART

NO	NO.	DESCRIPTION
27	27-117	LEFT SIDE PLATE
29L	29L-117	SPOOL
30	30-117	STAND
31	39-12	RIGHT/LEFT SIDE STAND SCREW
33	33-117	ROD CLAMP
*	*33R-117	RINGED ROD CLAMP (OPTIONAL)
34	34-130	CLAMP SCREW
34C	34C-116	CLAMP SCREW W/ NUTS
35	35-115	CLICK TONGUE
36	36-117	CLICK BUTTON
37	37-116	FRAME POST (8 REQ.)
38	39-13	RIGHT/LEFT SIDE POST SCREW (8 REQ. PER SIDE)
40	26-117	LEFT SIDE BEARING
49	49-116	HANDLE SPACER
54	54-117	HARNES LUG (6 REQ.)
56	56-117	ROD BRACE (2 REQ.)
56C	56C-117	ROD BRACE (COMPLETE)
56P	56P-117	ROD BRACE PAD
86	86-118	BEVELED WASHER
98	98-117	GEAR SLEEVE
99	99-116	HOOK SCREW L.H. THREAD (2 REQ.)
149	149-116L	HEX NUT (2 REQ.)
149A	149-116H	CLAMP NUT (2 REQ.)
155	155-116	TURN BUCKLE (2 REQ)
156	156-117	DRAG COVER
165	165-116	HOOK SCREW L.H. THREAD (4 REQ.)

* Not Shown