

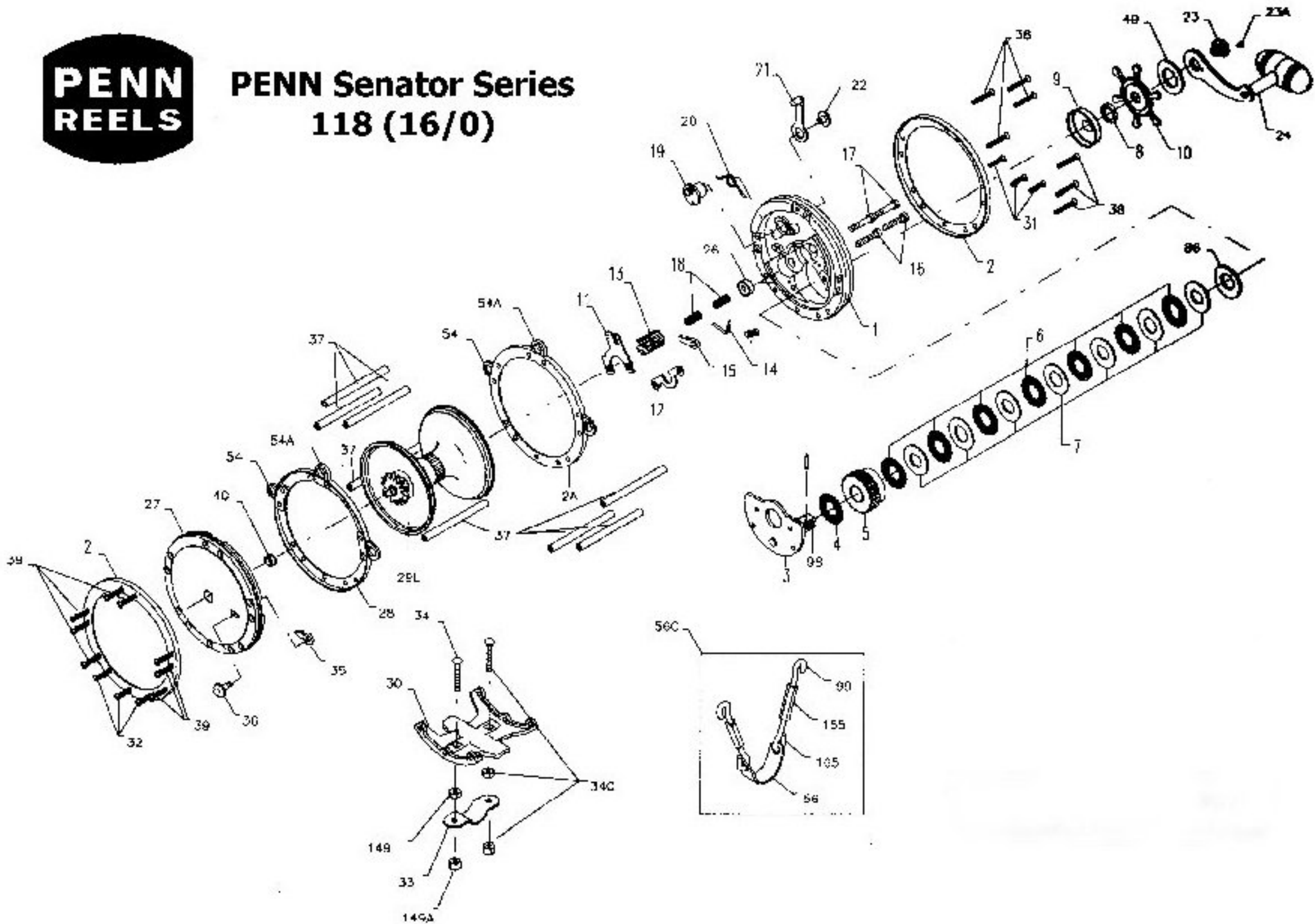

PENN Senator Series 118 (16/0)



Penn Reel Parts list for:

Model: 118 (16/0)

KEY NO	PART NO.	DESCRIPTION	KEY NO	PART NO.	DESCRIPTION
1	1-118	RIGHT SIDE PLATE	27	27-117	LEFT SIDE PLATE
2	2-117-0	OUTER RIGHT SIDE RING (2 REQ.)	29L	29M-118	SPOOL
2A	2-117-1	INNER PLATE SIDE RING (2 REQ.)	30	30-118	STAND
3	3-117	BRIDGE W/ SLEEVE	31	39-12	RIGHT/LEFT SIDE STAND
4	4-117	FIBER WASHER	33	33-117	ROD CLAMP
5	5-117	MAIN GEAR	*	*33R-117	RINGED ROD CLAMP (OF
6	6-117	DRAG WASHER (7 REQ.)	34	34-130	CLAMP SCREW
7C	7C-117	METAL DRAG WASHER SET	34C	34C-116	CLAMP SCREW W/ NUTS
8	8-117	TENSION SPRING	35	35-115	CLICK TONGUE
9	9-117	DRAG COVER ONLY	36	36-117	CLICK BUTTON
10	10-117	STAR DRAG WHEEL	37	37-118	FRAME POST (8 REQ.)
11	11-116	ECCENTRIC JACK	38	39-13	SIDE POST SCREW (8 RE
12	12-116	PINION YOKE	40	26-117	LEFT SIDE BEARING
13	13-117	PINION	49	49-116	HANDLE SPACER
14	14-117	DOG SPRING	54	54-117	HARNES LUG (6 REQ.)
15	15-117	DOG	56	56-117	ROD BRACE (2 REQ.)
16	16-114	LOWER BRIDGE SCREW (2 REQ)	56C	56C-117	ROD BRACE (COMPLETE
17	17-114	UPPER BRIDGE SCREW (2 REQ.)	56P	56P-117	ROD BRACE PAD
18	18-114	CLUTCH SPRINGS (2 REQ.)	86	86-118	BEVELED WASHER
19	19-115	ECCENTRIC	98	98-117	GEAR SLEEVE
20	20-114	ECCENTRIC SPRING	99	99-116	HOOK SCREW L.H. THRE
21	21-117	ECCENTRIC LEVER	149	149-116L	HEX NUT (2 REQ.)
22	23-60	ECCENTRIC SCREW	149A	149-116H	CLAMP NUT (2 REQ.)
23	23-116	HANDLE SCREW	155	155-116	TURN BUCKLE (2 REQ)
23A	110-60	HANDLE LOCK SCREW	165	165-116	HOOK SCREW L.H. THRE
24	24-117	HANDLE			
26	26-117	RIGHT SIDE BEARING			

* Not Shown