

# SIGMA REEL

2200GX-050 SW

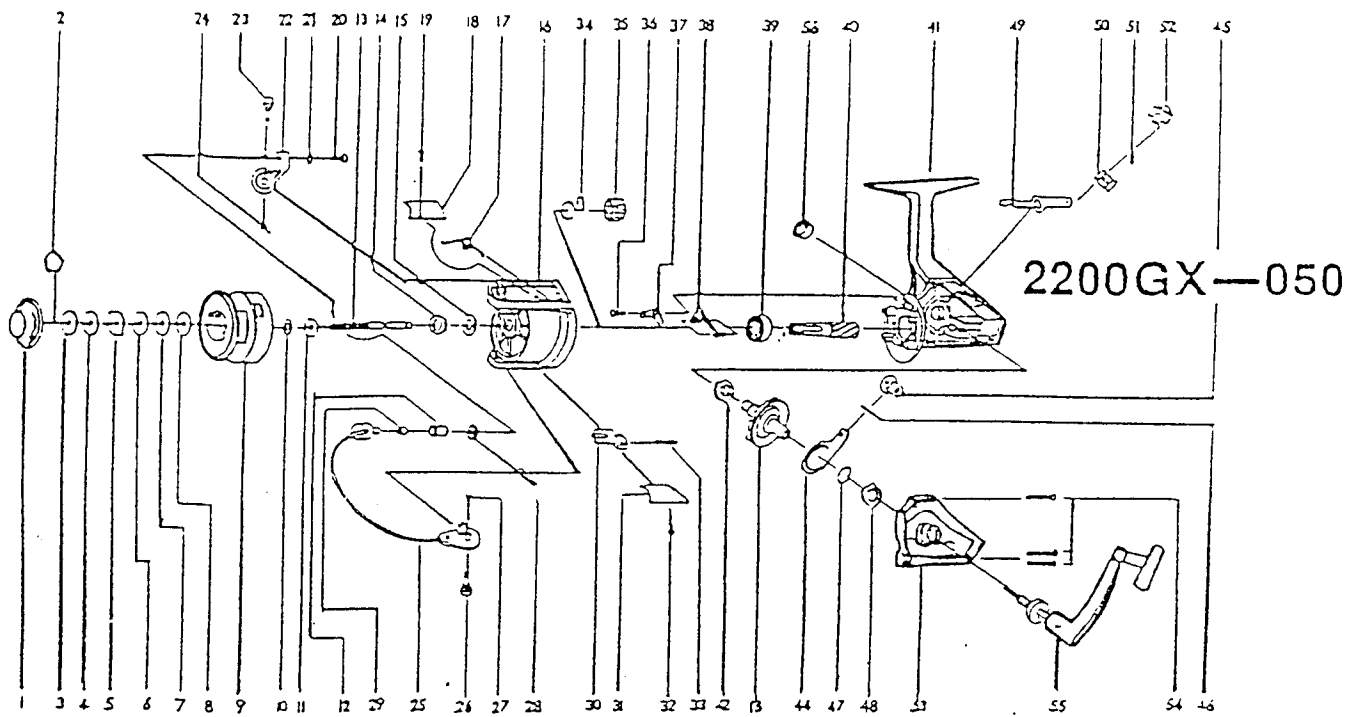

REF

| #  | PART NUMBER   | DESCRIPTION         |
|----|---------------|---------------------|
| 1  | 79-40-0172-01 | Drag Knob Ass'y     |
| 2  | 79-54-0123-01 | Spool Retainer      |
| 3  | 79-72-0583-01 | Spool "D" W/S       |
| 4  | 79-72-0584-01 | Spool "B" W/S       |
| 5  | 79-72-0586-01 | Spool "A" W/S       |
| 6  | 79-72-0584-01 | Spool "B" W/S       |
| 7  | 79-72-0583-01 | Spool "D" W/S       |
| 8  | 79-72-0584-01 | Spool "B" W/S       |
| 9  | 79-66-0245-01 | Spool Ass'y         |
| 10 | 79-72-0589-01 | Spool Adj. W/S      |
| 11 | 79-28-0156-01 | Click Gear          |
| 12 | 79-57-0042-01 | Line Roller         |
| 13 | 79-60-0133-01 | Main Shaft          |
| 14 | 79-40-0175-01 | Rotor Nut           |
| 15 | 79-72-0597-01 | Rotor Retainer      |
| 16 | 79-34-0136-01 | Rotor               |
| 17 | 79-67-0619-01 | Bail Spring         |
| 18 | 79-19-0090-01 | Bail S/P Cover      |
| 19 | 79-58-0577-01 | Bail S/P Cover S/C  |
| 20 | 79-58-0562-01 | Bail Screw          |
| 21 | 79-72-0595-01 | Bail W/S            |
| 22 | 79-07-0075-01 | Arm Lever           |
| 23 | 79-58-0587-01 | Arm Lever Pin       |
| 24 | 79-15-0050-01 | E-Clip              |
| 25 | 79-03-0105-01 | Bail Ass'y          |
| 26 | 79-58-0587-01 | Bail Holder Pin     |
| 27 | 79-15-0050-01 | E-Clip              |
| 28 |               | Bail Collar         |
| 29 | 79-09-0017-01 | Line Roller Bushing |
| 30 | 79-37-0163-01 | Kick Lever          |

REF

| #  | PART NUMBER   | DESCRIPTION        |
|----|---------------|--------------------|
| 31 | 79-19-0092-01 | Kick Lever Cover   |
| 32 | 79-58-0577-01 | Kick L/V C/V S/C   |
| 33 | 79-67-0603-01 | Kick L/V S/P       |
| 34 | 79-67-0610-01 | Sliding Spring "A" |
| 35 | 79-28-0159-01 | Ratchet Gear       |
| 36 | 79-58-0576-01 | A.R. Stopper S/C   |
| 37 | 79-37-0178-01 | A.R. Stopper       |
| 38 | 79-58-0571-01 | Bearing S/C        |
| 39 | 79-04-0063-01 | Ball Bearing       |
| 40 | 79-46-0094-01 | Pinion Gear        |
| 41 | 79-27-0165-01 | Body               |
| 42 | 79-07-0019-01 | Body Bushing       |
| 43 | 79-28-0165-01 | Drive Gear         |
| 44 | 79-37-0167-01 | O/S Slider         |
| 45 | 79-64-0051-01 | Pin Slider         |
| 46 | 79-45-0040-01 | O/S Pin            |
| 47 | 79-72-0608-01 | Drive Gear Adj W/S |
| 48 | 79-09-0019-01 | Body Cover Bush    |
| 49 | 79-11-0053-01 | A.R. Cam           |
| 50 | 79-67-0615-01 | A.R. Plate S/P     |
| 51 | 79-45-0041-01 | A.R. Lever Pin     |
| 52 | 79-37-0175-01 | A.R. Lever         |
| 53 | 79-19-0094-01 | Body Cover         |
| 54 | 79-58-0574-01 | Body Cover S/C     |
| 55 | 79-20-0141-01 | Handle Ass'y       |
| 56 | 79-12-0050-01 | Handle S/C Cap     |

**Shakespeare**®