

Shakespeare[®]

SINCE 1897

Boss™ (Series 8000/8100)
Mag Boss™ (Series 9000/9100)

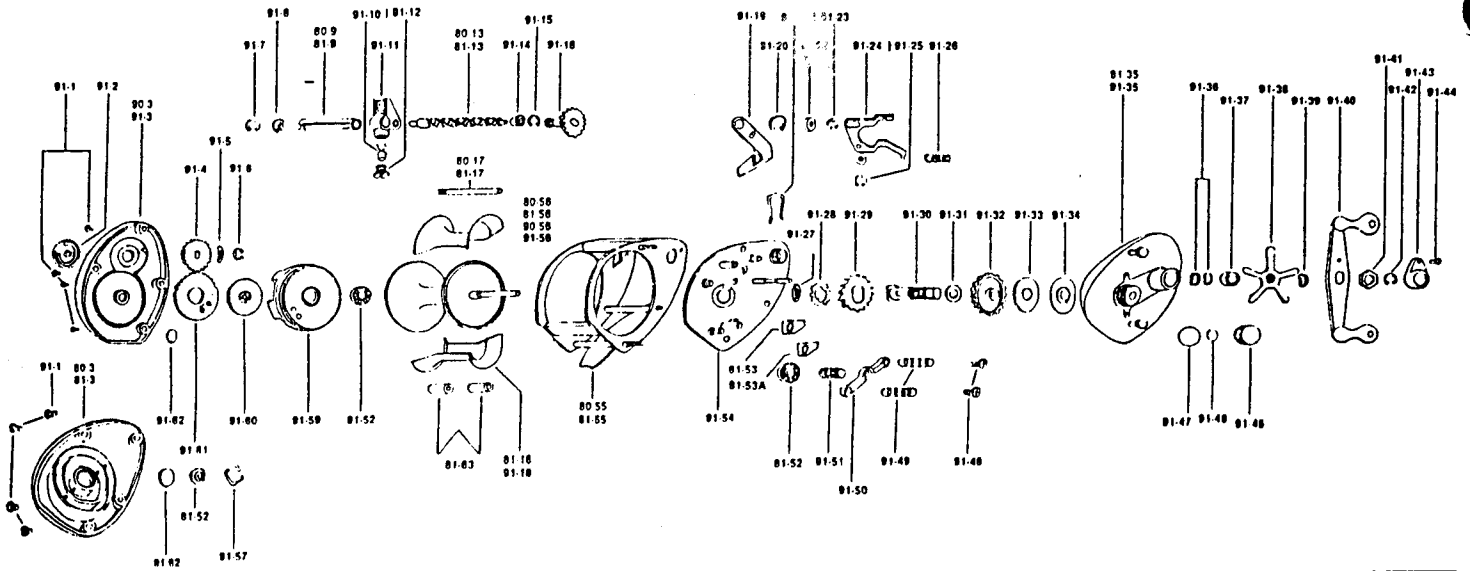

PART NO.	DESCRIPTION	PART NO.	DESCRIPTION
91-1	Side Plate Screws	91-33	Drag Washer
91-2	Mag Adjustment Knob	91-34	Metal Key Disc
90-3	Left Side Plate [9000]	81-35	Right Side Plate [8000, 8100]
91-3	Left Side Plate [9100]	91-35	Right Side Plate [9000, 9100]
80-3	Left Side Plate [8000]	91-36	Drag Shims
81-3	Left Side Plate [8100]	91-37	Drag Spacer
91-4	Adjusting Ratchet	91-38	Star Wheel
91-5	Spacer Shim	91-39	Handle Spring Washer
91-6	Clip	91-40	Handle
91-7	C-Clip	91-41	Handle Nut
91-8	Carriage Guard Bushing	91-42	Shaft Clip
80-9	Carriage Guard [8000, 9000]	91-43	Handle Lock Ring
81-9	Carriage Guard [8100, 9100]	91-44	Handle Lock Screw
91-10	Pawl	91-45	Spool-Tension Cap
91-11	Line Guide	91-46	Shim
91-12	Pawl Cap	91-47	O-Ring
80-13	Carriage Screw [8000, 9000]	91-48	Yoke Screws
81-13	Carriage Screw [8100, 9100]	91-49	Yoke Spring
91-14	Carriage Bushing	91-50	Pinion Yoke
91-15	C-Clip	91-51	Pinion Gear
91-16	Idler Gear	81-52	Graphite Bushing [8000, 8100]
80-17	Carriage Pillar [8000, 9000]	91-52	Ball Bearing [9000, 9100]
81-17	Carriage Pillar [8100, 9100]	81-53	A/R Pawl Spring
81-18	Spool Arbor [8000, 9000]	81-53A	A/R Pawl Spring
91-18	Spool Arbor [8100, 9100]	91-54	Brake Plate
91-19	Thumb Bar	80-55	Main Frame [8000, 9000]
91-20	C-Clip	81-55	Main Frame [8100, 9100]
91-21	Idler Clip	90-56	Spool [9000]
91-22	Thumb Bar Bushing	91-56	Spool [9100]
91-23	C-Clip	80-56	Spool [8000]
91-24	Trip Lever	81-56	Spool [8100]
91-25	C-Clip	91-57	Bushing Retainer Clip
91-26	Trip Lever Spring	91-59	Mag Housing
91-27	Shaft Spacer	91-60	Mag Shim Plate
91-28	Release Cam	91-61	Mag Ratchet
91-29	Anti-Reverse Ratchet	91-62	Shim
91-30	Drive Shaft	91-62	Bushing Shim
91-31	Base Washer	81-63	Brake Blocks [8000, 8100]
91-32	Drive Gear		