

### EXPLODED PARTS VIEW

GRAPHITE CONSTRUCTION  
**BAITRUNNER**  
*150*

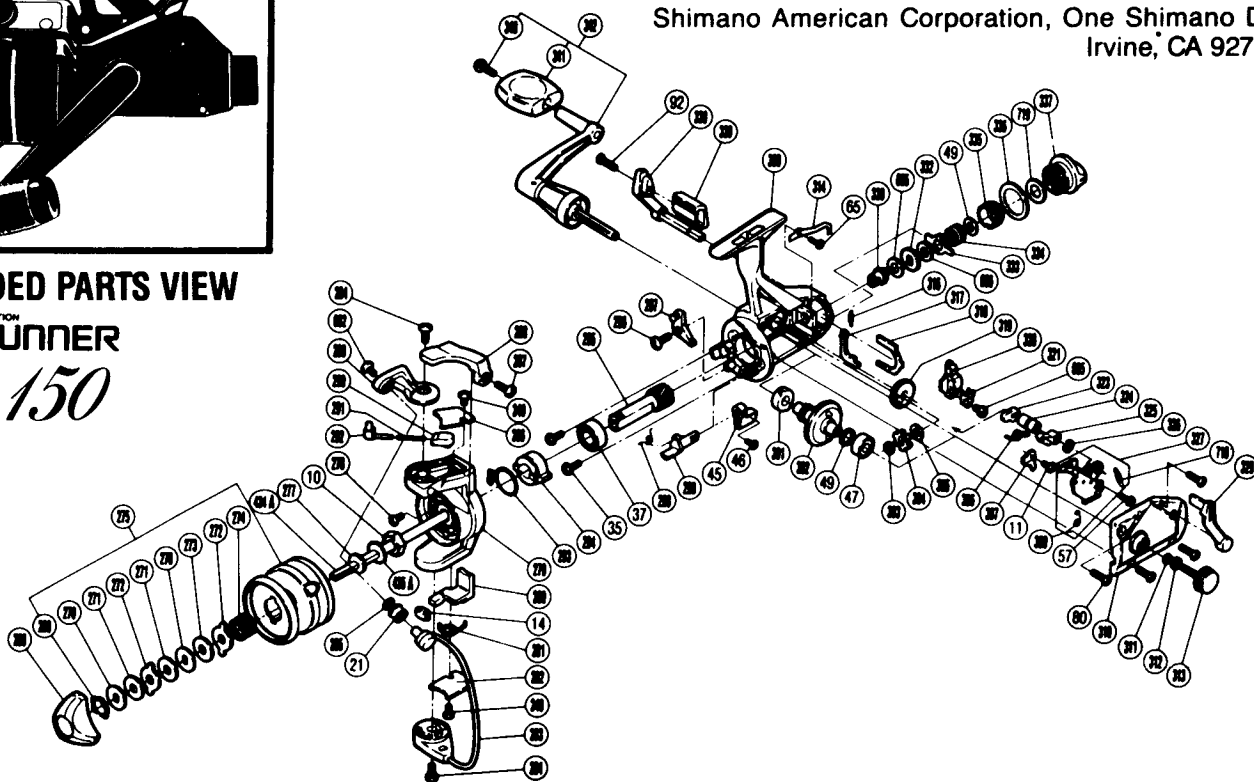

### PARTS LIST

**PART # DESCRIPTION**

- BR 0010 Rotor Nut
- BR 0011 Nut Lock Screw
- BR 0014 Bail Trip Slide Cam
- BR 0021 Line Roller
- BR 0035 Bearing Retainer Screw
- BR 0037 Ball Bearing
- BR 0045 Anti-Reverse Lever
- BR 0046 Anti-Reverse Lever Screw
- BR 0047 Ball Bearing
- BR 0049 Drive Gear Washer
- BR 0057 Clutch Plate Screw
- BR 0065 Dial Click Screw
- BR 0080 Side Cover Screw B
- BR 0092 Baitrunner Lever Screw
- BR 0240 Bail Trip Cover Screw
- BR 0268 Drag Knob
- BR 0269 Drag Washers Retainer
- BR 0270 Key Washer
- BR 0271 Drag Washer 1
- BR 0272 Eared Washer
- BR 0273 Drag Washer 2
- BR 0274 Drag Spring
- BR 0275 Spool Assembly
- BR 0277 Spool Washer
- BR 0278 Nut Lock Screw
- BR 0279 Rotor
- BR 0280 Bail Trip Lever
- BR 0281 Lever Spring
- BR 0282 Bail Trip Cover
- BR 0283 Bail Assembly
- BR 0284 Bail Trip Cam Screw

**PART # DESCRIPTION**

- BR 0285 Line Roller Washer
- BR 0286 Bail Spring Cover
- BR 0287 Trigger Screw
- BR 0288 Quick-Fire II Trigger
- BR 0289 Bail Arm
- BR 0290 Bail Spring Guide B
- BR 0291 Bail Spring
- BR 0292 Bail Spring Guide A
- BR 0293 Anti-Reverse Pawl Spring
- BR 0294 Anti-Reverse Ratchet
- BR 0295 Pinion Gear
- BR 0296 Anti-Reverse Pawl Screw
- BR 0297 Anti-Reverse Pawl
- BR 0298 Anti-Reverse Cam Spring
- BR 0299 Anti-Reverse Cam
- BR 0300 Body
- BR 0301 Bushing
- BR 0302 Drive Gear
- BR 0303 "C" Lock
- BR 0304 Baitrunner Ratchet
- BR 0305 Ratchet Spacer
- BR 0306 Clutch Spring
- BR 0307 Baitrunner Pawl Guide
- BR 0309 Clutch Pawl Spring
- BR 0310 Side Cover
- BR 0311 Lock Washer Retainer
- BR 0312 Handle Lock Washer
- BR 0313 Handle Screw Cap
- BR 0314 Dial Click
- BR 0316 Baitrunner Pawl Spring
- BR 0317 Baitrunner Pawl

**PART # DESCRIPTION**

- BR 0318 Dial Retainer
- BR 0319 Oscillating Gear
- BR 0320 Oscillating Slider
- BR 0321 Oscillating Slider Retainer
- BR 0323 Clutch Cam
- BR 0324 Clutch Cam Spacer
- BR 0325 Clutch Arm
- BR 0326 Lever Shaft Retainer
- BR 0327 Clutch Plate Assembly
- BR 0329 Baitrunner Lever Arm (L)
- BR 0330 Free Spool Tension Shaft
- BR 0332 Click Gear
- BR 0333 Eared Washer "BFS"
- BR 0334 Free Spool Tension Spring
- BR 0335 Free Spool Tension Screw
- BR 0336 Dial Spacer
- BR 0337 Baitrunner Tension Dial
- BR 0338 Baitrunner Lever Arm (R)
- BR 0339 Baitrunner Lever Bridge
- BR 0340 Handle Knob Screw
- BR 0341 Handle Knob
- BR 0342 Handle Assembly
- BR 0434A Main Shaft
- BR 0435A Spool Support
- BR 0652 Line Roller Screw
- BR 0655 Free Spool Tension Washer (A)
- BR 0656 Free Spool Tension Washer (B)
- BR 0685 Slider Retainer Screw
- BR 0718 Baitrunner Click Spring
- BR 0719 Adjusting Spacer