

# SHIMANO®

## 1987 REPAIR MANUAL

Shimano American Corporation, One Shimano Dr.  
Irvine, CA 92718

### EXPLODED PARTS VIEW

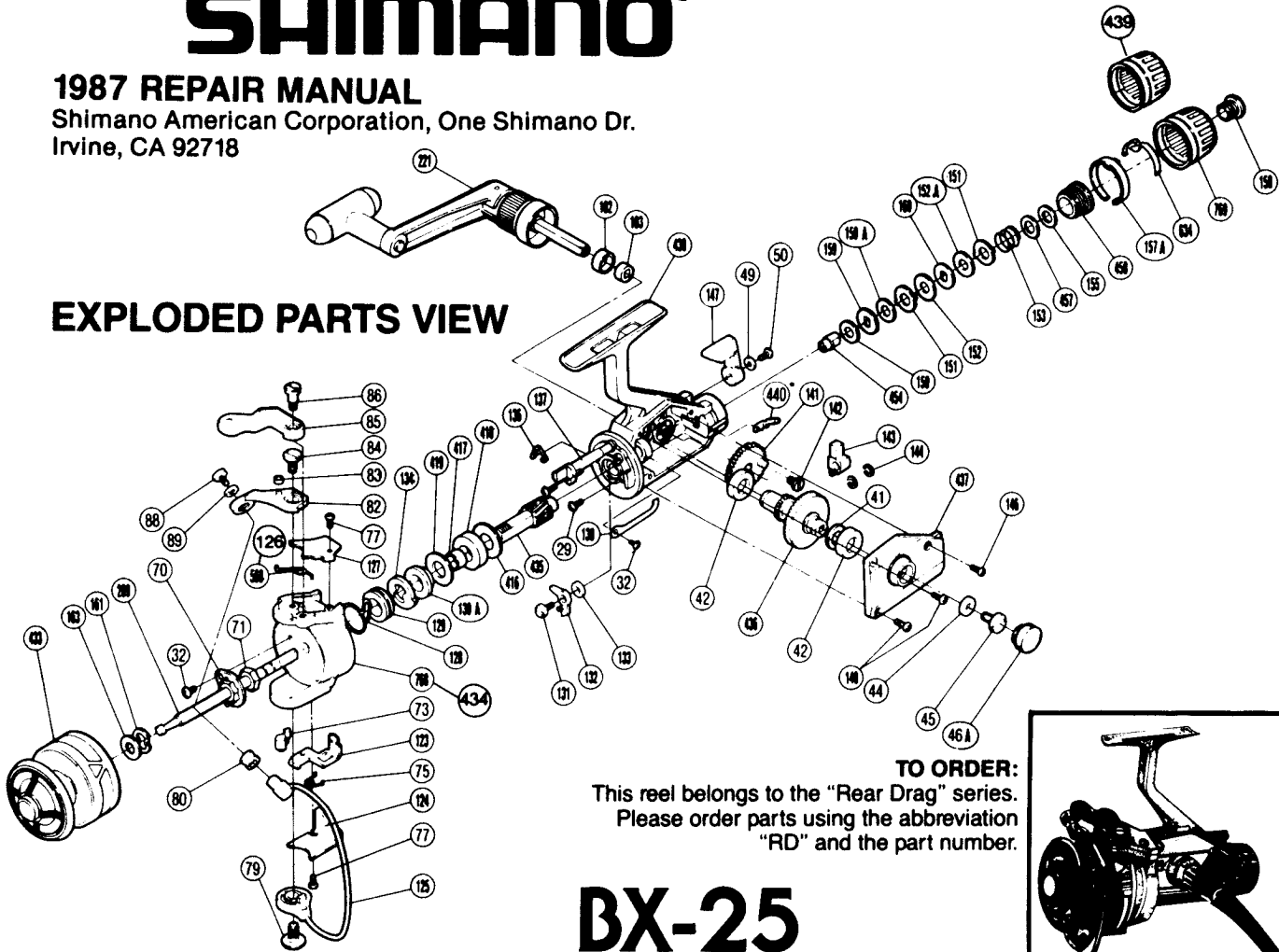

**TO ORDER:**  
This reel belongs to the "Rear Drag" series.  
Please order parts using the abbreviation  
"RD" and the part number.

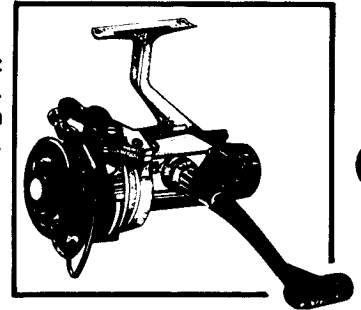

## BX-25

### PARTS LIST

#### PART# DESCRIPTION

- 29. Bearing Retainer Screw
- 32. Multi Purpose Screw
- 41. Thrust Washer
- 42. Drive Gear Bushing
- 44. Handle Screw Lock Washer
- 45. Handle Screw
- 46A. Dust Cap
- 49. Lock Washer
- 50. Anti Reverse Lever Screw
- 70. Rotor Nut Lock
- 71. Rotor Nut
- 73. Trip Plate Cam
- 75. Trip Plate Spring
- 77. Cover Screw
- 79. Bail Screw
- 80. Roller Line Guide
- 82. Bail Mount
- 83. Trigger Pin Roller
- 84. Bail Mount Screw
- 85. QuickFire Trigger
- 86. Trigger Screw
- 88. Bail Wire Screw
- 89. Guide Screw Lock Washer
- 102. Bushing Ring
- 103. Handle Shaft Bushing
- 123. Trip Plate
- 124. Trip Plate Cover

#### PART# DESCRIPTION

- 125. Bail Wire
- 126. Bail Spring (orig. 2-coil)
- 127. Bail Spring Cover
- 128. Rotor Stop Spring
- 129. Stop Spring Arbor
- 130A. Ratchet Spacer
- 131. Anti Reverse Dog Screw
- 132. Anti Reverse Dog
- 133. Anti Reverse Dog Spacer
- 134. Self Center Ratchet
- 136. Anti Reverse Shaft Spring
- 137. Anti Reverse Shaft
- 138. Drag Click Spring
- 140. Side Plate Screw #1
- 141. Oscillation Gear
- 142. Oscillation Gear Screw
- 143. Oscillation Block
- 144. "C" Lock
- 146. Side Plate Screw #2
- 147. Anti Reverse Lever
- 150. Drag Washer (Black)
- 150A. Drag Washer (White)
- 151. Keyed Washer #1
- 152. Drag Washer (Black)
- 152A. Drag Washer (White)
- 153. Drag Spring
- 155. Friction Washer
- 157A. Stop Ring

#### PART# DESCRIPTION

- 158. Drag Screw
- 159. Ratchet Washer
- 160. D Washer
- 161. Tension Spring
- 163. Spool Spacer
- 209. Spindle
- 221. Handle
- 416. Bushing Washer A
- 417. Bearing Spacer
- 418. Pinion Gear Bushing
- 419. Bushing Washer B
- 433. Spool
- 434. Rotor (orig. 2-coil spring)
- 435. Pinion Gear
- 436. Drive Gear
- 437. Side Plate
- 438. Housing
- 439. Drag Adjusting Knob (orig.)\*
- 440. Drag Knob Click Spring \*
- 454. Drag Shaft
- 455. Lock Washer
- 456. Lock Spring
- 457. Base Spring Washer
- 458. Spring Housing
- 568. Bail Spring ('85) 4-Coil
- 634. Drag Knob Click Spring ('85)
- 768. Rotor ('85) 4-Coil Spring
- 769. Drag Knob ('85)