

SHIMANO

1987 REPAIR MANUAL

Shimano American Corporation, One Shimano Dr.
Irvine, CA 92718

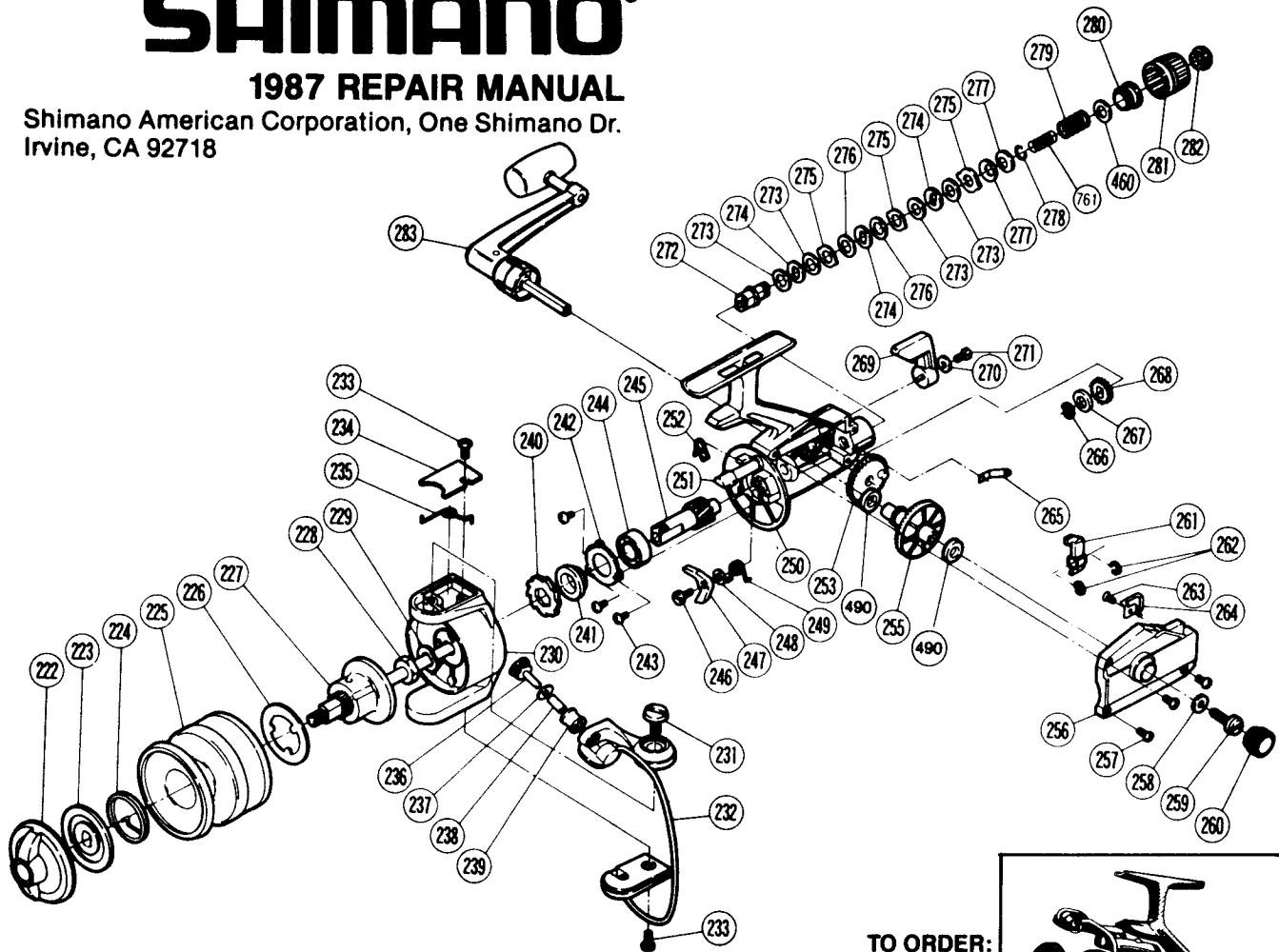

TO ORDER:
This reel belongs to the "Rear Drag" series.
Please order parts using the abbreviation
"RD" and the part number.

EXPLODED PARTS VIEW CUSTOM 6000

PARTS LIST

PART# DESCRIPTION

222. Spool Drag Knob
223. Spool Drag Disc
224. Click Spring
225. Spool
226. Base Drag Washer
227. Spool Shaft
228. Rotor Nut
229. Rotor Lock
230. Rotor
231. Bail Mount Screw
232. Bail Wire
233. Multi Purpose Screw
234. Bail Spring Cover
235. Bail Spring
236. Line Guide Screw
237. Line Guide Cover
238. Line Guide Bushing
239. Roller Line Guide
240. Anti Reverse Ratchet
241. Ratchet Spacer
242. Bearing Lock
243. Bearing Lock Screw

PART# DESCRIPTION

244. Ball Bearing
245. Pinion Gear
246. Anti Reverse Dog Screw
247. Anti Reverse Dog
248. Anti Reverse Dog Spacer
249. Anti Reverse Dog Spring
250. Housing
251. Anti Reverse Shaft
252. Anti Reverse Shaft Spring
253. Oscillation Gear
255. Drive Gear
256. Side Plate
257. Side Plate Screw
258. Handle Screw Lock Washer
259. Handle Screw
260. Dust Cap
261. Oscillation Guide
262. "C" Lock
263. Click Spring Screw
264. Click Spring
265. Detent Spring
266. Drag "C" Lock

PART# DESCRIPTION

267. Spacer
268. Drag Ratchet Wheel
269. Anti Reverse Lever
270. Lever Screw Lock Washer
271. Anti Reverse Lever Screw
272. Stern Drag Shaft
273. Drag "C" Washer
274. "D" Washer
275. Keyed Washer
276. Drag Washer D
277. Coned Disc Spring
278. Drag "C" Lock
279. Stern Drag Spring
280. Spring Housing
281. Stern Drag Knob
282. Drag Knob Screw
283. Handle
460. "E" Washer
490. Drive Gear Bushing
761. Lock Spring (orig. 459A)

Prices and specifications subject to change without notice

JUNE 1986