

## CUSTOM GT2000 PLUS

1985 PRODUCTION (Red Anti-Reverse Lever)  
1987 REPAIR MANUAL

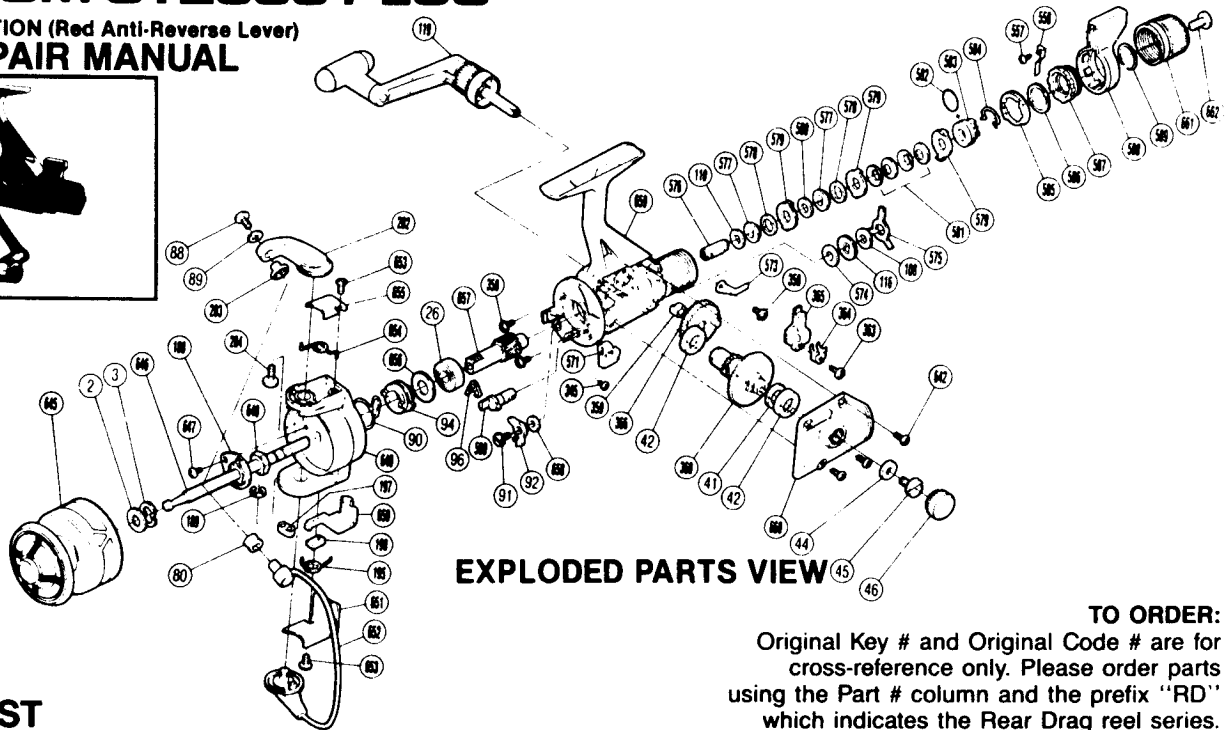
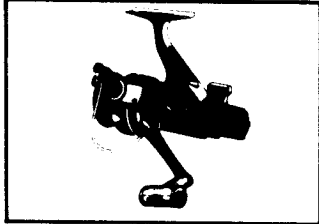

EXPLODED PARTS VIEW

**TO ORDER:**

Original Key # and Original Code # are for cross-reference only. Please order parts using the Part # column and the prefix "RD" which indicates the Rear Drag reel series.

### PARTS LIST

ORIGINAL PART #	ORIGINAL KEY #	ORIGINAL CODE #	DESCRIPTION	ORIGINAL PART #	ORIGINAL KEY #	ORIGINAL CODE #	DESCRIPTION
645.	1.	6-0209 31120S	Spool Assembly	366.	40.	6-0449 27220S	Oscillating Gear Assembly
2.	2.	7-0217 26100S	Spool Washer	42.	41.	7-0617 26100S	Drive Gear Bushing
3.	3.	7-2101 06100S	Tension Spring	360.	42.	7-0408 29220S	Drive Gear
646.	4.	6-0219 31120S	Main Shaft Assembly	41.	43.	7-0446 01100S	Drive Gear Washer
647.	5.	7-0014 30220S	Nut Lock Screw	660.	44.	6-0609 33200S	Side Cover
188.	6.	7-2124 06100S	Rotor Nut Lock Plate	44.	45.	7-0725 05500S	Handle Lock Washer
648.	7.	7-0311 10100S	Rotor Nut	45.	46.	7-0710 05100S	Handle Lock Screw
649.	8.	7-0301 29200S	Rotor	46.	47.	7-0453 26100S	Handle Screw Cap
197.	9.	7-0355 29200S	Bail Trip Slide Cam	573.	48.	7-0122 32200S	Drag Click
650.	10.	7-0336 29230S	Bail Trip Lever	365.	49.	7-0410 29200S	Oscillating Slider
198.	11.	7-0369 29200S	Trip Lever Guide	364.	50.	7-0538 29200S	Oscillating Slider Retainer
195.	12.	7-0337 29201S	Lever Spring	363.	51.	7-0014 30120S	Slider Retainer Screw
651.	13.	7-0338 33200S	Bail Trip Cover	642.	52.	7-0011 30711S	Side Cover Screw
652.	14.	6-0309 29230S	Bail	574.	53.	7-0139 26210S	Drag Washer "C <sub>2</sub> "
653.	15.	7-0013 40360S	Multi-Purpose Screw	116.	54.	7-0113 26200S	Click Gear
80.	16.	7-0304 01100S	Line Roller	108.	55.	7-0139 26200S	Drag Washer "C <sub>1</sub> "
189.	17.	7-0040 00550S	"E" Lock	575.	56.	7-0159 32200S	Eared Washer "BF"
654.	18.	7-0310 29200S	Bail Spring	576.	57.	7-0112 32200S	Drag Shaft
655.	19.	7-0307 33200S	Bail Spring Cover	110.	58.	7-0140 26200S	Drag Washer "D"
202.	20.	7-0303 28820S	Bail Arm	557.	59.	7-0115 29200S	Key Washer "A"
88.	21.	7-0013 40410S	Line Roller Screw	578.	60.	7-0146 32210S	Drag Washer "F <sub>2</sub> "
89.	22.	7-0316 01100S	Lock Washer	579.	61.	7-0116 32200S	Eared Washer "B"
203.	23.	7-0318 28820S	Line Roller Washer	580.	62.	7-0146 32200S	Drag Washer "F <sub>1</sub> "
204.	24.	7-0013 40430S	Ball Arm Screw	581.	63.	7-0150 32200S	Coned Disc Springs
90.	25.	7-0422 21700S	Anti-Reverse Pawl Spring	582.	64.	7-0160 32200S	"O" Ring
94.	26.	7-0421 21700S	Anti-Reverse Ratchet	583.	65.	7-0110 32200S	Pressure Screw
656.	27.	7-0514 33200S	Bushing Washer	584.	66.	7-0149 32200S	Hold Click Spring
26.	28.	7-0402 19300S	Ball Bearing	585.	67.	7-0155 32200S	Lever Click Gear
657.	29.	7-0407 33200S	Pinion Gear	586.	68.	7-0157 32200S	Fightin' Pressure Screw Washer
358.	30.	7-0011 30470S	Bearing Retainer Screw	587.	69.	7-0156 32200S	Fightin' Pressure Screw
96.	31.	7-0426 21200S	Anti-Reverse Cam Spring	557.	70.	7-0010 00110S	Fightin' Drag Click Screw
569.	32.	7-0424 32200S	Anti-Reverse Cam	558.	71.	7-0154 32100S	Fightin' Drag Click
91.	33.	7-0425 21700S	Anti-Reverse Pawl Screw	588.	72.	6-0441 32200S	Fightin' Drag Lever
92.	34.	6-0419 21700S	Anti-Reverse Pawl Assembly	589.	73.	7-0158 32200S	Lever Hold Spring
658.	35.	7-0457 33200S	Anti-Reverse Pawl Spacer	661.	74.	6-0439 30200S	Drag Programmer
659.	36.	6-0409 33200S	Body	662.	75.	7-0013 50400S	Drag Programmer Screw
571.	37.	7-0404 32200S	Anti-Reverse Lever	119.	76.	6-0709 27215S	Handle Assembly
345.	38.	7-0013 00110S	Anti-Reverse Lever Screw				
359.	39.	7-0537 29200S	Oscillating Gear Bushing				