

# SHIMANO®

## 1987 REPAIR MANUAL

Shimano American Corporation, One Shimano Dr.  
Irvine, CA 92718

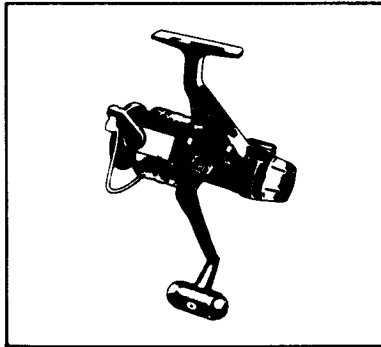

**TO ORDER:**  
This reel belongs to the "Rear Drag" series.  
Please order parts using the abbreviation  
"RD" and the part number.

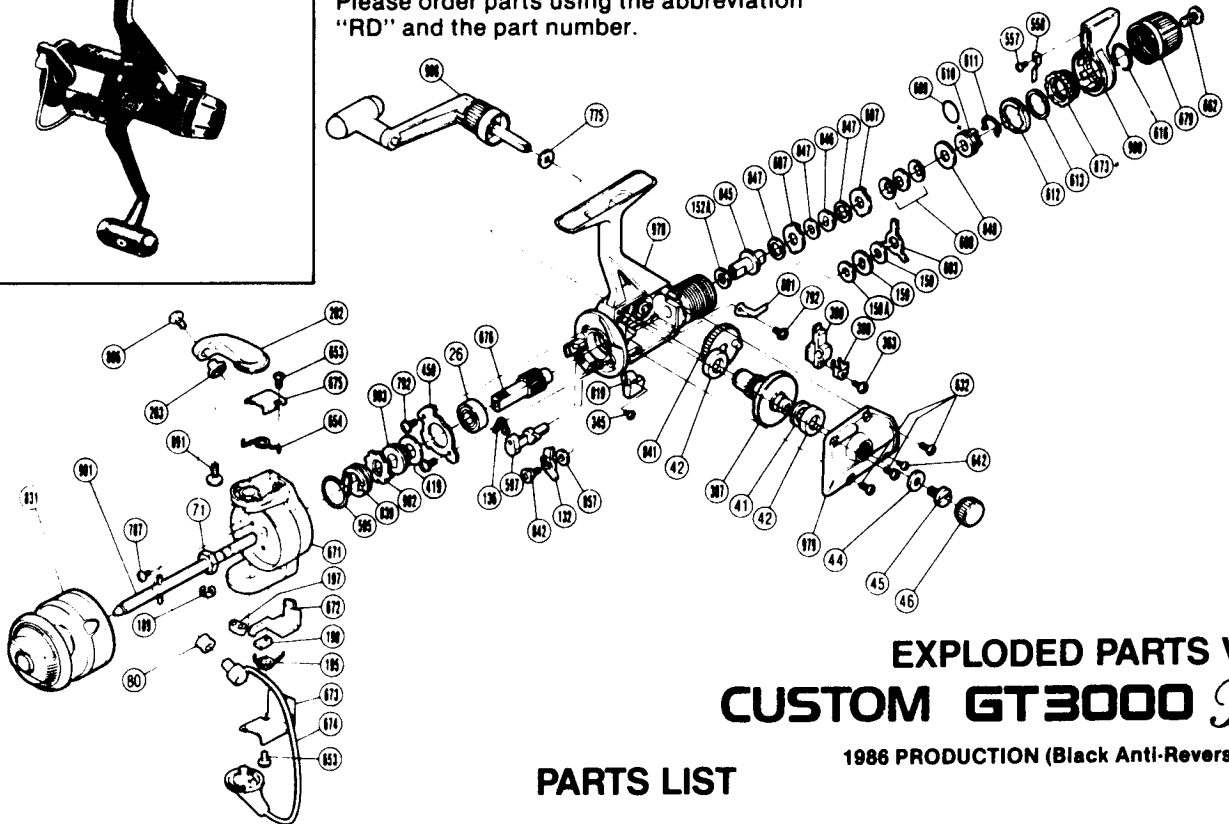

### EXPLODED PARTS VIEW CUSTOM GT3000 *Plus*

1986 PRODUCTION (Black Anti-Reverse Lever)

#### PARTS LIST

##### PART # DESCRIPTION

- 26. Ball Bearing
- 41. Drive Gear Washer
- 42. Bushing
- 44. Handle Lock Washer
- 45. Handle Lock Screw (Originally 796)
- 46. Handle Screw Cap
- 71. Rotor Nut
- 80. Line Roller
- 132. Anti-Reverse Pawl
- 136. Anti-Reverse Cam Spring
- 150. Drag Washer "C<sub>1</sub>"
- 150A. Drag Washer "C<sub>2</sub>"
- 152A. Drag Washer "D<sub>2</sub>"
- 159. Click Gear
- 189. "E" Lock
- 195. Lever Spring
- 197. Bail Trip Slide Cam
- 198. Trip Lever Guide
- 202. Bail Arm
- 203. Line Roller Washer
- 345. Anti-Reverse Lever Screw
- 363. Slider Retainer Screw
- 387. Drive Gear
- 389. Oscillating Slider Retainer
- 390. Oscillating Slider

##### PART # DESCRIPTION

- 419. Pinion Spacer B (Originally 904)
- 459. Bearing Retainer
- 557. Fightin' Drag Click Screw
- 558. Fightin' Drag Click
- 595. Anti-Reverse Pawl Spring
- 597. Anti-Reverse Cam
- 601. Drag Click
- 603. Eared Washer "B<sub>F</sub>"
- 607. Eared Washer "B"
- 608. Coned Disc Springs
- 609. "O" Ring
- 610. Pressure Screw
- 611. Hold Click Spring
- 612. Lever Click Gear
- 613. Fightin' Pressure Screw Washer
- 616. Lever Hold Spring
- 632. Side Cover Screw A
- 642. Side Cover Screw B
- 653. Cover Screw
- 654. Bail Spring
- 662. Drag Programmer Screw
- 671. Rotor
- 672. Bail Trip Lever
- 673. Bail Trip Cover
- 674. Bail Assembly

##### PART # DESCRIPTION

- 675. Bail Spring Cover
- 676. Pinion Gear
- 679. Drag Programmer
- 775. Handle Lock Spacer
- 787. Nut Lock Screw
- 792. Multi Purpose Screw
- 806. Line Roller Screw
- 819. Anti-Reverse Lever
- 831. Spool Assembly (Universal)
- 839. Anti-Reverse Spring Holder
- 841. Oscillating Gear
- 842. Anti-Reverse Pawl Screw
- 845. Drag Shaft
- 846. Key Washer "A"
- 847. Drag Washer "H<sub>1</sub>"
- 848. Drag Spring Washer "A"
- 857. Anti-Reverse Pawl Spacer
- 873. Fightin' Pressure Screw
- 891. Bail Arm Screw
- 901. Main Shaft
- 902. Anti-Reverse Ratchet
- 903. Pinion Spacer A
- 908. Handle Assembly
- 978. Body
- 979. Side Cover
- 980. Fightin' Drag Lever

Prices and specifications subject to change without notice.

JUNE 1986