

SHIMANO®

1987 REPAIR MANUAL

Shimano American Corporation, One Shimano Dr.
Irvine, CA 92718

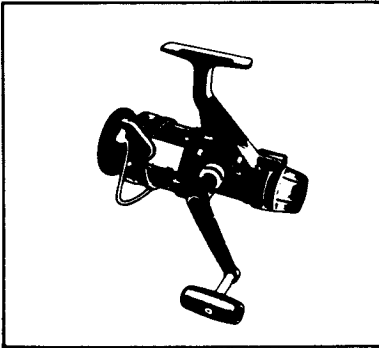

TO ORDER:

This reel belongs to the "Rear Drag" series.
Please order parts using the abbreviation
"RD" and the part number.

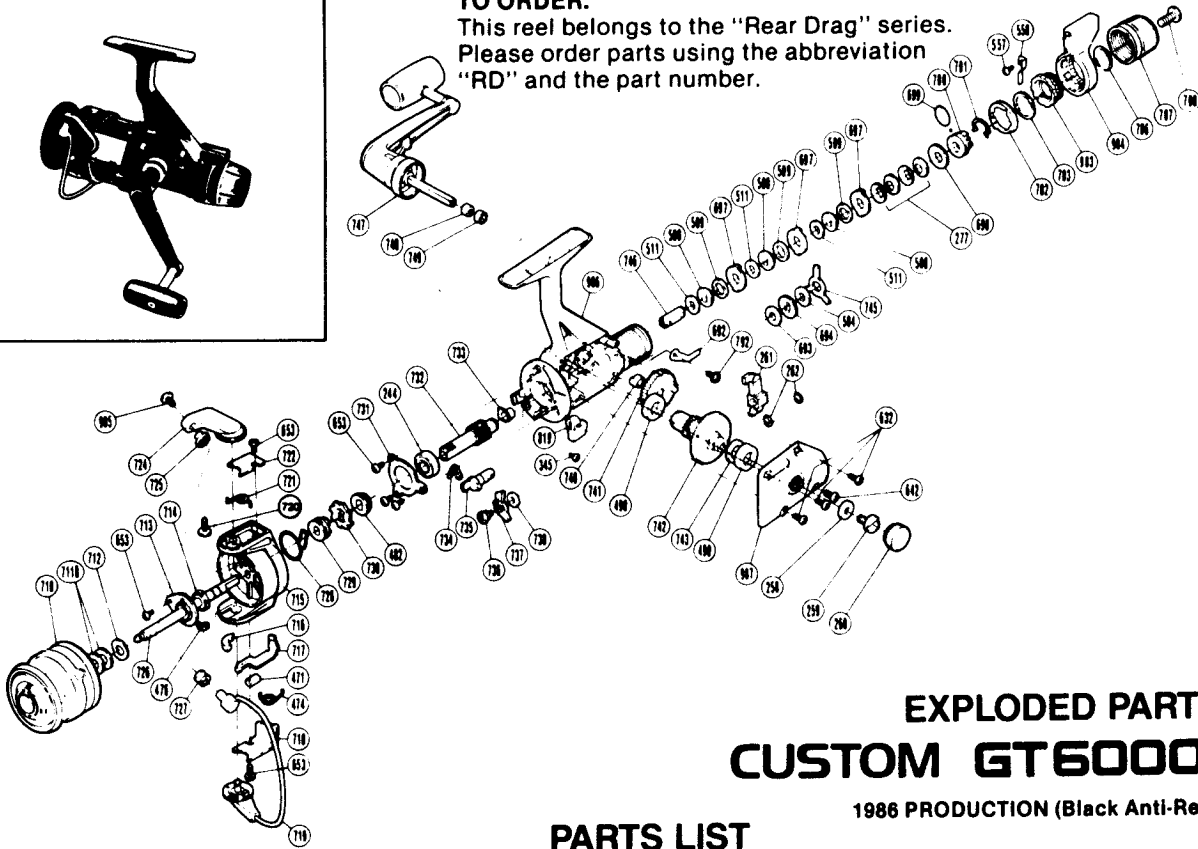

EXPLODED PARTS VIEW CUSTOM GT6000 *Plus*

1986 PRODUCTION (Black Anti-Reverse Lever)

PARTS LIST

PART # DESCRIPTION

- 244. Ball Bearing
- 258. Handle Lock Washer
- 259. Handle Lock Screw
(Originally 988)
- 260. Handle Screw Cap
- 261. Oscillating Slider
- 262. "C" Lock
- 277. Coned Disc Springs
- 345. Anti-Reverse Lever Screw
- 471. Trip Lever Guide
- 474. Lever Spring
- 476. "E" Lock
- 482. Pinion Spacer
- 490. Bushing
- 504. Drag Washer "C,"
- 508. Key Washer "A"
- 509. Drag Washer "F,"
- 511. Drag Washer "D,"
- 557. Fightin' Drag Click Screw
- 558. Fightin' Drag Click
- 632. Side Cover Screw A
- 642. Side Cover Screw B
- 653. Multi Purpose Screw
- 692. Drag Click
- 693. Drag Washer "C,"
- 694. Click Gear
- 697. Eared Washer "B"
- 698. Drag Spring Washer "A"

PART # DESCRIPTION

- 699. "O" Ring
- 700. Pressure Screw
- 701. Hold Click Spring
- 702. Lever Click Gear
- 703. Fightin' Pressure Screw
Washer
- 706. Lever Hold Spring
- 707. Drag Programmer
- 708. Drag Programmer Screw
- 710. Spool Assembly
- 711B. Spool Washer B
- 712. Tension Spring
- 713. Rotor Nut Lock Plate
- 714. Rotor Nut
- 715. Rotor
- 716. Bail Trip Slide Cam
- 717. Bail Trip Lever
- 718. Bail Trip Cover
- 719. Bail Assembly
- 720. Bail Arm Screw
(Originally 996)
- 721. Bail Spring
- 722. Bail Spring Cover
- 724. Bail Arm
- 725. Line Roller Washer
- 726. Main Shaft
- 727. Line Roller

PART # DESCRIPTION

- 728. Anti-Reverse Pawl Spring
- 729. Anti-Reverse
Spring Holder
- 730. Anti-Reverse Ratchet
- 731. Bearing Retainer
- 732. Pinion Gear
- 733. Pinion Gear Bushing
- 734. Anti-Reverse Cam Spring
- 735. Anti-Reverse Cam
- 736. Anti-Reverse Pawl Screw
- 737. Anti-Reverse Pawl
- 738. Anti-Reverse Pawl Spacer
- 740. Oscillating Gear Bushing
- 741. Oscillating Gear
- 742. Drive Gear
- 743. Drive Gear Washer
- 745. Eared Washer "B"
- 746. Drag Shaft
- 747. Handle Assembly
- 748. Handle Lock Spacer
- 749. Handle Lock Ring
- 792. Drag Click Screw
- 819. Anti-Reverse Lever
- 983. Fightin' Pressure Screw
- 984. Fightin' Drag Lever
- 985. Line Roller Screw
- 986. Body
- 987. Side Cover

Prices and specifications subject to change without notice.

JUNE 1986