

CUSTOM GT6000 PLUS

1985 PRODUCTION (Red Anti-Reverse Lever)

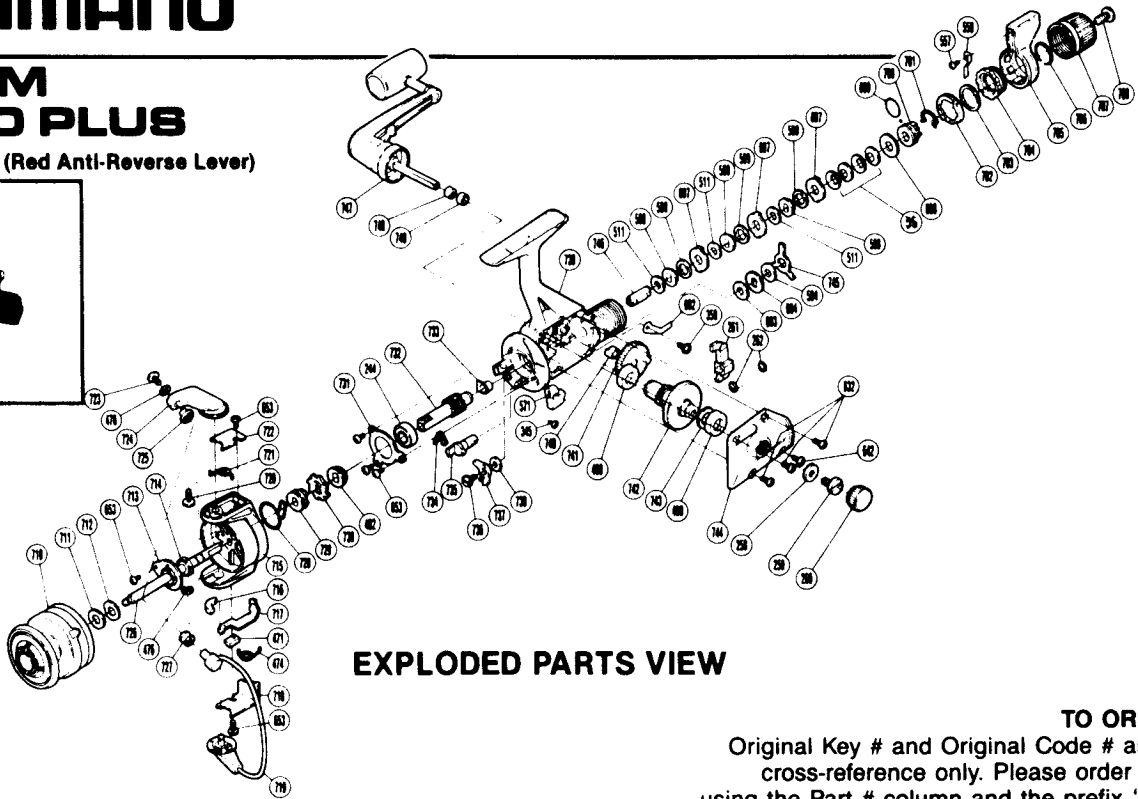
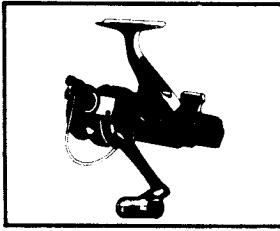

EXPLODED PARTS VIEW

PARTS LIST

ORIGINAL PART #	ORIGINAL KEY #	ORIGINAL CODE #	DESCRIPTION	ORIGINAL PART #	ORIGINAL KEY #	ORIGINAL CODE #	DESCRIPTION
710.	1.	6-0209 31160S	Spool Assembly	741.	41.	6-0449 27710S	Oscillating Gear Assembly
711.	2.	7-0217 29730S	Spool Washer	490.	42.	7-0608 29410S	Drive Gear Bushing
712.	3.	7-0218 29730S	Tension Spring	742.	43.	7-0408 29770S	Drive Gear
653.	4.	7-0013 40360S	Multi Purpose Screw	743.	44.		Drive Gear Washer
713.	5.	7-0360 29700S	Rotor Nut Lock Plate	744.	45.	6-0609 33600S	Side Cover
714.	6.	7-0311 29730S	Rotor Nut	258.	46.	7-0725 01200S	Handle Lock Washer
715.	7.	7-0301 29730S	Rotor	259.	47.	7-0710 25100S	Handle Lock Screw
716.	8.	7-0355 29730S	Bail Trip Slide Cam	260.	48.	7-0453 21400S	Handle Screw Cap
717.	9.	7-0336 29730S	Bail Trip Lever	692.	49.	7-0122 33400S	Drag Click
471.	10.	7-0369 29400S	Trip Lever Guide	358.	50.	7-0011 30470S	Drag Click Screw
474.	11.	7-0337 29400S	Lever Spring	261.	51.	7-0410 25500S	Oscillating Slider
718.	12.	7-0338 33600S	Bail Trip Cover	262.	52.	7-0041 25500S	"C" Lock
719.	13.	6-0309 33600S	Bail	632.	53.	7-0011 40302S	Side Cover Screw A
720.	14.	7-0013 40700S	Bail Arm Screw	642.	54.	7-0011 30711S	Side Cover Screw B
721.	15.	7-0310 29730S	Bail Spring	693.	55.	7-0139 29410S	Drag Washer "C ₂ "
722.	16.	7-0307 33600S	Bail Spring Cover	694.	56.	7-0113 33400S	Click Gear
723.	17.	7-0013 40800S	Line Roller Screw	504.	57.	7-0139 29400S	Drag Washer "C ₁ "
478.	18.	7-0316 29400S	Lock Washer	745.	58.	7-0159 33600S	Eared Washer "BF"
724.	19.	7-0303 29730S	Bail Arm	746.	59.	7-0112 33600S	Drag Shaft
725.	20.	7-0318 33600S	Line Roller Washer	511.	60.	7-0140 29400S	Drag Washer "D"
726.	21.	6-0219 31160S	Main Shaft Assembly	508.	61.	7-0115 29400S	Key Washer "A"
476.	22.	7-0040 10610S	"E" Lock	509.	62.	7-0146 29400S	Drag Washer "F"
727.	23.	7-0304 33600S	Line Roller	697.	63.	7-0116 33400S	Eared Washer "B"
728.	24.	7-0422 29730S	Anti-Reverse Pawl Spring	277.	64.	7-0145 25500S	Coned Disc Springs
729.	25.	7-0498 29730S	Anti-Reverse Spring Holder	698.	65.	7-0135 33400S	Drag Spring Washer "A"
730.	26.	7-0421 29730S	Anti-Reverse Ratchet	699.	66.	7-0160 33400S	"O" Ring
482.	27.	7-0428 29430S	Pinion Spacer	700.	67.	7-0110 33400S	Pressure Screw
731.	28.	7-0403 29730S	Bearing Retainer	701.	68.	7-0149 33400S	Hold Click Spring
244.	29.	7-0402 01300S	Ball Bearing	702.	69.	7-0155 33600S	Lever Click Gear
732.	30.	7-0407 29770S	Pinion Gear	703.	70.	7-0157 33400S	Fightin' Pressure Screw Washer
733.	31.	7-0513 29730S	Pinion Gear Bushing	704.	71.	7-0156 33400S	Fightin' Pressure Screw
734.	32.	7-0426 29730S	Anti-Reverse Cam Spring	557.	72.	7-0010 00110S	Fightin' Drag Click Screw
735.	33.	7-0424 33600S	Anti-Reverse Cam	558.	73.	7-0154 32100S	Fightin' Drag Click
736.	34.	7-0424 33600S	Anti-Reverse Pawl Screw	705.	74.	6-0441 33400S	Fightin' Drag Lever
737.	35.	6-0419 30600S	Anti-Reverse Pawl Assembly	706.	75.	7-0158 33400S	Lever Hold Spring
738.	36.	7-0457 29700S	Anti-Reverse Pawl Spacer	707.	76.	6-0439 30400S	Drag Programmer
739.	37.	6-0409 33600S	Body	708.	77.	7-0013 60400S	Drag Programmer Screw
571.	38.	7-0404 32200S	Anti-Reverse Lever	747.	78.	6-0709 31160S	Handle Assembly
345.	39.	7-0013 00110S	Anti-Reverse Lever Screw	748.	79.	7-0743 29700S	Handle Lock Spacer
740.	40.	7-0537 29700S	Oscillating Gear Bushing	749.	80.	7-0731 29700S	Handle Lock Ring

TO ORDER:

Original Key # and Original Code # are for cross-reference only. Please order parts using the Part # column and the prefix "RD" which indicates the Rear Drag reel series.