

# SHIMANO®

## 1987 REPAIR MANUAL

Shimano American Corporation, One Shimano Dr.  
Irvine, CA 92718

### NEW DRAG PARTS

440. Drag Knob Click Spring*	.20
441. Drag Shaft	1.20
450. Lock Washer	.20
451. Lock Spring	.15
452. Base Spring Washer	.15
453. Spring Housing	.50

\*New Longer Spring

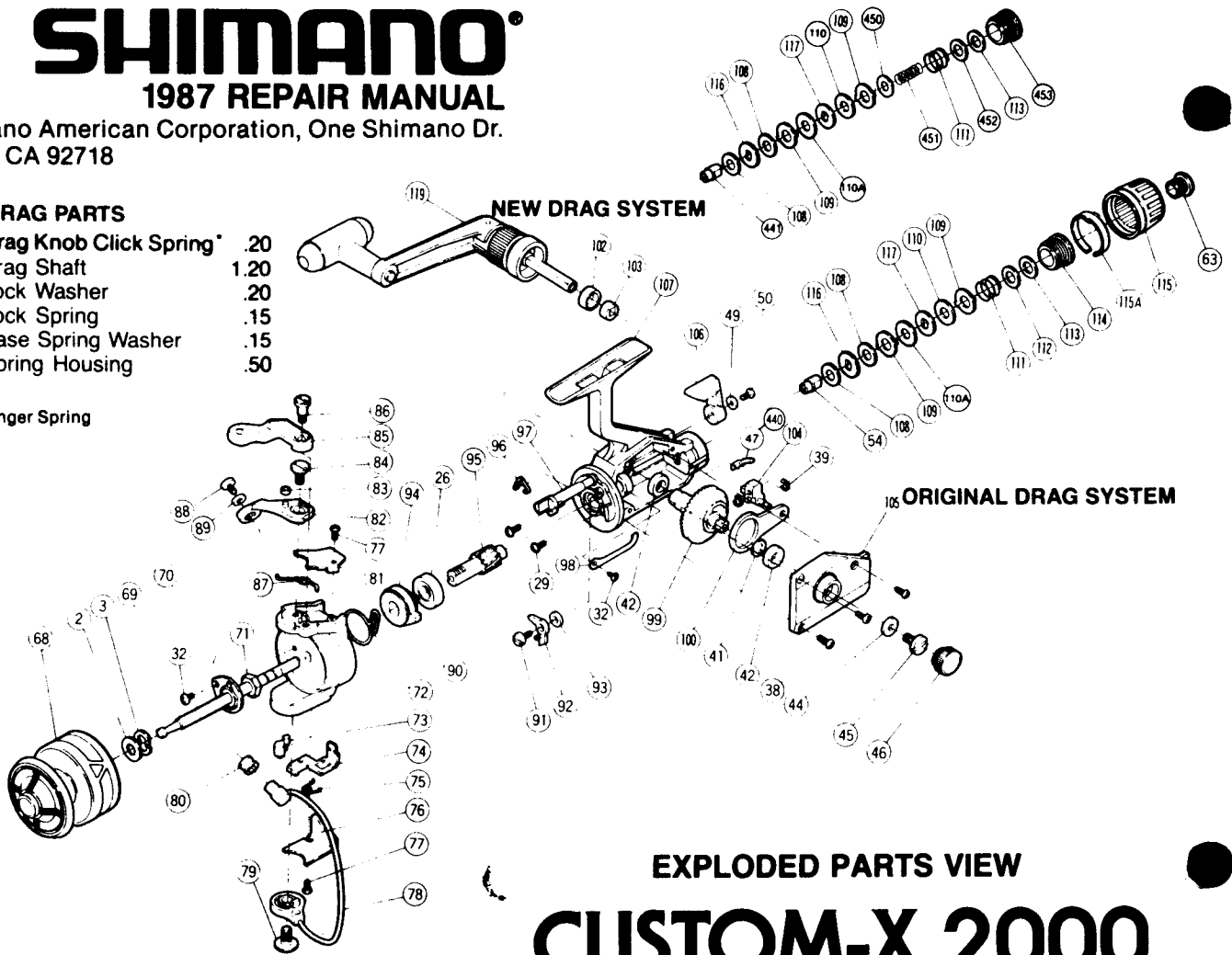

### EXPLODED PARTS VIEW

# CUSTOM-X 2000

#### TO ORDER:

This reel belongs to the "Rear Drag" series.  
Please order parts using the abbreviation  
"RD" and the part number.

### PARTS LIST

#### PART# DESCRIPTION

- 2. Spool Spacer
- 3. Tension Spring
- 26. Ball Bearing
- 29. Bearing Retainer Screw
- 32. Multi Purpose Screw
- 38. Side Plate Screw
- 39. "C" Lock
- 41. Thrust Washer
- 42. Drive Gear Bushing
- 44. Handle Screw Lock Washer
- 45. Handle Screw
- 46. Dust Cap
- 47. Drag Knob Click Spring
- 49. Lock Washer
- 50. Anti Reverse Lever Screw
- 54. Drag Shaft
- 63. Drag Screw
- 68. Spool
- 69. Spindle
- 70. Rotor Nut Lock
- 71. Rotor Nut
- 72. Rotor
- 73. Trip Plate Cam

#### PART# DESCRIPTION

- 74. Trip Plate
- 75. Trip Plate Spring
- 76. Trip Plate Cover
- 77. Cover Screw
- 78. Bail Wire
- 79. Bail Screw
- 80. Roller Line Guide
- 81. Bail Spring Cover
- 82. Bail Mount
- 83. Trigger Pin Roller
- 84. Bail Mount Screw
- 85. Quickfire Trigger
- 86. Trigger Screw
- 87. Bail Spring
- 88. Bail Wire Screw
- 89. Guide Screw Lock Washer
- 90. Rotor Stop Spring
- 91. Anti Reverse Dog Screw
- 92. Anti Reverse Dog
- 93. Anti Reverse Dog Spacer
- 94. Self Center Ratchet
- 95. Pinion Gear
- 96. Anti Reverse Shaft Spring

#### PART# DESCRIPTION

- 97. Anti Reverse Shaft
- 98. Drag Click
- 99. Drive Gear
- 100. Oscillation Guide
- 102. Bushing Ring
- 103. Handle Shaft Bushing
- 104. Oscillation Guide Block
- 105. Side Plate
- 106. Anti Reverse Lever
- 107. Housing
- 108. Drag Washer A
- 109. Keyed Washer
- 110. Drag Washer (Black)
- 110A. Drag Washer (White)
- 111. Drag Spring
- 112. Base Spring Washer
- 113. Friction Washer
- 114. Spring Housing
- 115. Drag Adjusting Knob
- 115A. Stop Ring
- 116. Ratchet Washer
- 117. D Washer
- 119. Handle

Prices and specifications subject to change without notice

JUNE 1986