

SHIMANO®

1987 REPAIR MANUAL

Shimano American Corporation, One Shimano Dr.
Irvine, CA 92718

NEW DRAG SYSTEM

NEW DRAG PARTS

440. Drag Knob Click Spring*	.20
454. Drag Shaft	1.25
455. Lock Washer	.20
456. Lock Spring	.15
457. Base Spring Washer	.15
458. Spring Housing	.75

*New Longer Spring

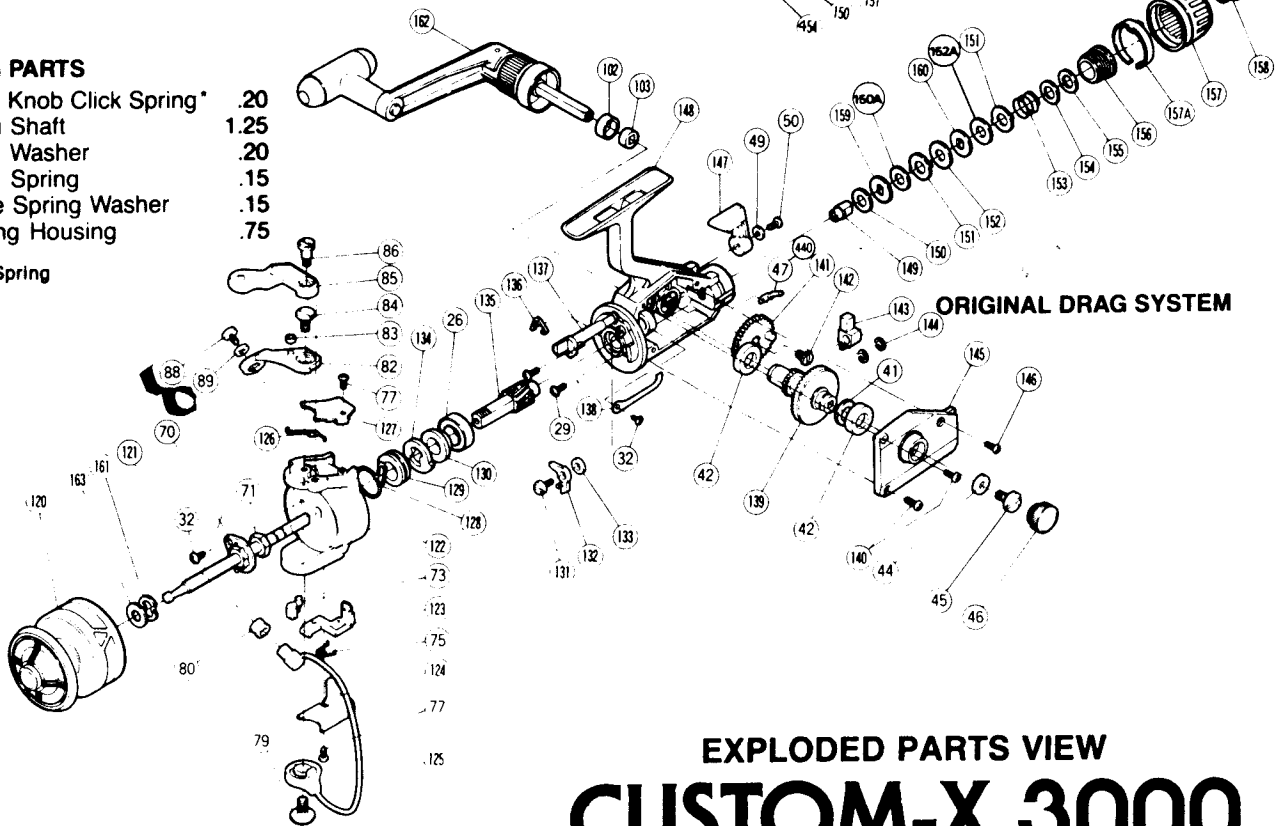

TO ORDER:

This reel belongs to the "Rear Drag" series.
Please order parts using the abbreviation
"RD" and the part number.

EXPLODED PARTS VIEW CUSTOM-X 3000

PARTS LIST

PART# DESCRIPTION

26. Ball Bearing
29. Bearing Retainer Screw
32. Multi Purpose Screw
41. Thrust Washer
42. Drive Gear Bushing
44. Handle Screw Lock Washer
45. Handle Screw
46. Dust Cap
47. Drag Knob Click Spring
49. Lock Washer
50. Anti Reverse Lever Screw
70. Rotor Nut Lock
71. Rotor Nut
73. Trip Plate Cam
75. Trip Plate Spring
77. Cover Screw
79. Bail Screw
80. Roller Line Guide
82. Bail Mount
83. Trigger Pin Roller
84. Bail Mount Screw
85. Quickfire Trigger
86. Trigger Screw
88. Bail Wire Screw

PART# DESCRIPTION

89. Guide Screw Lock Washer
102. Bushing Ring
103. Handle Shaft Bushing
120. Spool
121. Spindle
122. Rotor
123. Trip Plate
124. Trip Plate Cover
125. Bail Wire
126. Bail Spring
127. Bail Spring Cover
128. Rotor Stop Spring
129. Stop Spring Arbor
130. Ratchet Spacer
131. Anti Reverse Dog Screw
132. Anti Reverse Dog
133. Anti Reverse Dog Spacer
134. Self Center Ratchet
135. Pinion Gear
136. Anti Reverse Shaft Spring
137. Anti Reverse Shaft
138. Drag Click Spring
139. Drive Gear
140. Side Plate Screw 1
141. Oscillation Gear

PART# DESCRIPTION

142. Oscillation Gear Screw
143. Oscillation Block
144. "C" Lock
145. Side Plate
146. Side Plate Screw 2
147. Anti Reverse Lever
148. Housing
149. Drag Shaft
150. Drag Washer (Black)
150A. Drag Washer (White)
151. Keyed Washer 1
152. Drag Washer (Black)
152A. Drag Washer (White)
153. Drag Spring
154. Base Spring Washer
155. Friction Washer
156. Spring Housing
157. Drag Adjusting Knob
157A. Stop Ring
158. Drag Screw
159. Ratchet Washer
160. D Washer
161. Tension Spring
162. Handle
163. Spool Spacer

Prices and specifications subject to change without notice

JUNE 1986