

SHIMANO®

1987 REPAIR MANUAL

Shimano American Corporation, One Shimano Dr.
Irvine, CA 92718

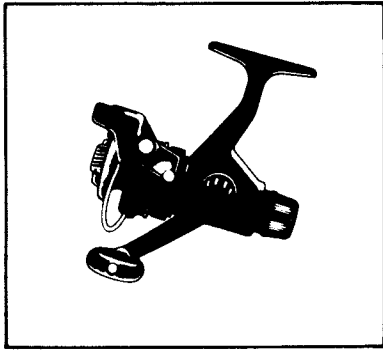

TO ORDER:

This reel belongs to the "Rear Drag" series.
Please order parts using the abbreviation
"RD" and the part number.

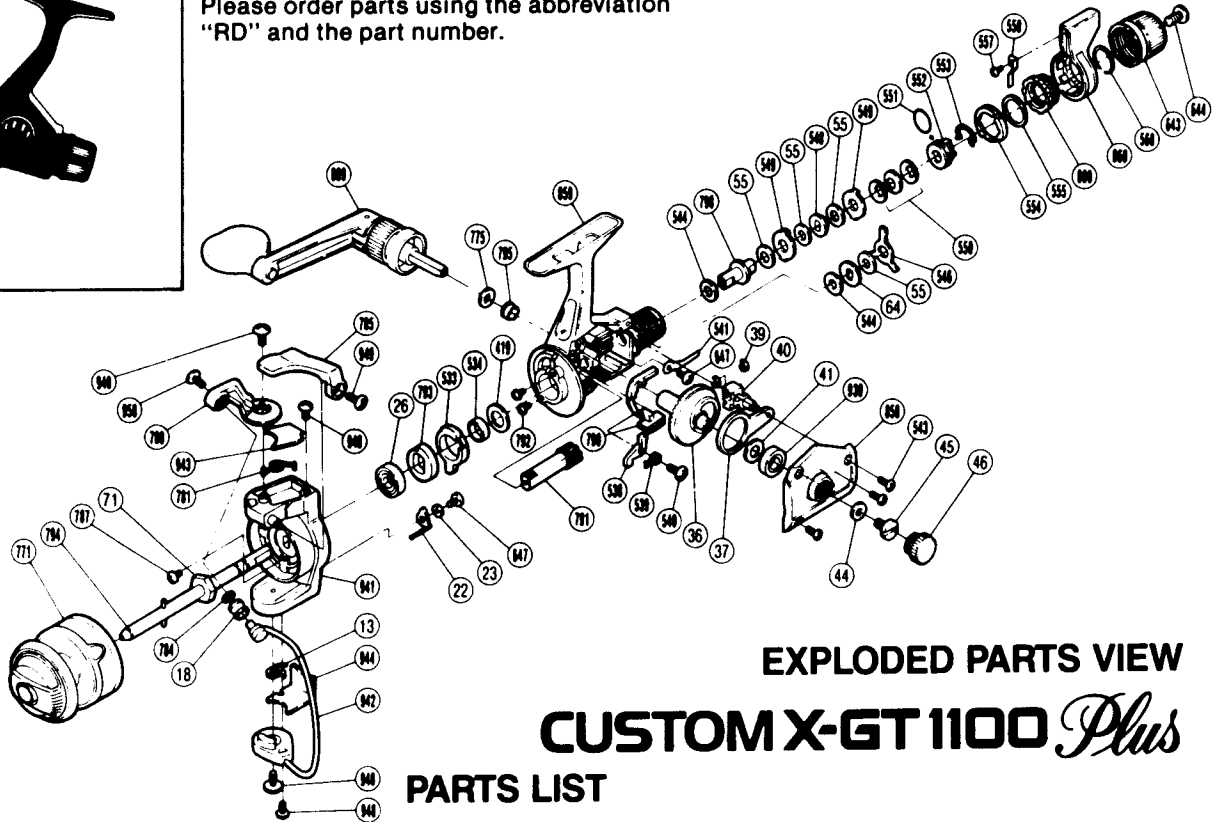

EXPLODED PARTS VIEW

CUSTOM X-GT 1100 *Plus*

PARTS LIST

PART # DESCRIPTION

- 13. Lever Spring
- 18. Line Roller
- 22. Bail Trip Lever
- 23. Trip Lever Spacer
- 26. Ball Bearing
- 36. Drive Gear
- 37. Oscillating Arm
- 39. "C" Lock
- 40. Oscillating Block
- 41. Drive Gear Washer
- 44. Handle Lock Washer
- 45. Handle Lock Screw (Originally 796)
- 46. Handle Screw Cap
- 55. Drag Washer "C,"
- 64. Click Gear
- 71. Rotor Nut
- 419. Bushing Washer
- 533. Anti-Reverse Lock Out
- 534. Pinion Spacer
- 538. Anti-Reverse Pawl
- 539. Anti-Reverse Pawl Spring
- 540. Anti-Reverse Pawl Screw
- 541. Drag Click

PART # DESCRIPTION

- 543. Side Cover Screw
- 544. Drag Washer "C₂"
- 546. Eared Washer "BF"
- 548. Key Washer "A"
- 549. Eared Washer "B"
- 550. Coned Disk Spring
- 551. "O" Ring
- 552. Pressure Screw
- 553. Hold Click Spring
- 554. Lever Click Gear
- 555. Fightin' Pressure Screw Washer
- 557. Fightin' Lever Click Screw
- 558. Fightin' Lever Click
- 560. Lever Hold Spring
- 643. Drag Programmer
- 644. Drag Programmer Screw
- 647. Multi-Purpose Screw (Universal)
- 771. Spool Assembly
- 775. Handle Lock Spacer
- 780. Bail Arm
- 781. Bail Spring
- 784. Line Roller Washer

PART # DESCRIPTION

- 785. Quick-Fire II Trigger
- 787. Nut Lock Screw
- 790. Anti-Reverse Switch
- 791. Pinion Gear
- 792. Bearing Retainer Screw
- 793. Anti-Reverse Ratchet
- 794. Main Shaft
- 795. Bushing
- 798. Drag Shaft
- 800. Fightin' Pressure Screw
- 858. Side Cover
- 859. Body
- 860. Fightin' Drag Lever
- 889. Handle Assembly
- 930. Ball Bearing
- 940. Bail Trip Cam Screw
- 941. Rotor
- 942. Bail Assembly
- 943. Bail Spring Cover
- 944. Bail Trip Cover
- 948. Bail Trip Cover Screw
- 949. Trigger Screw
- 950. Line Roller Screw