

SHIMANO[®]

1988 REPAIR MANUAL

Shimano American Corporation, One Shimano Dr.
Irvine, CA 92718

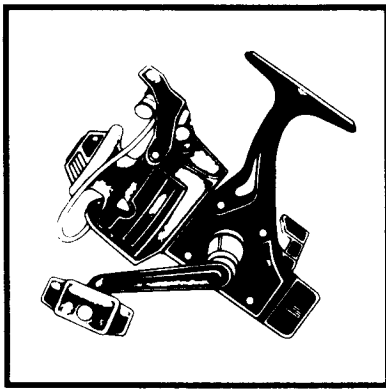

EXPLODED PARTS VIEW

LIGHT SPECIAL GRAPHITE CONSTRUCTION
FX200

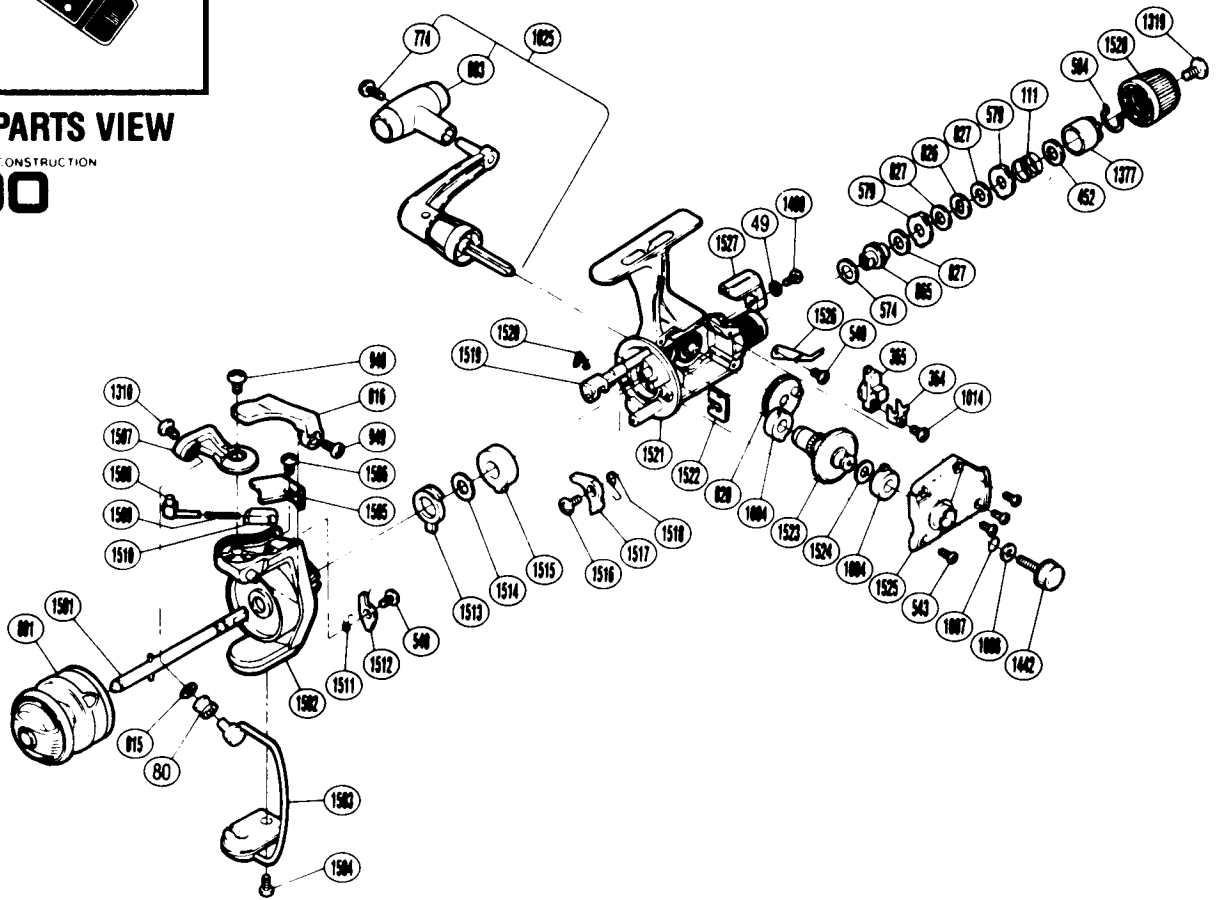

PARTS LIST

PART # DESCRIPTION

RD 0049 Lock Washer
RD 0080 Line Roller
RD 0111 Drag (Coil) Spring
RD 0364 Oscillating Slider Retainer
RD 0365 Oscillating Slider
RD 0452 Drag Spring Washer "A"
RD 0540 Anti-Reverse Pawl Screw
RD 0543 Side Cover Screw (B)
RD 0574 Drag Washer "C2" (White)
RD 0579 Eared Washer "B"
RD 0584 Hold Click Spring
RD 0774 Handle Knob Screw
RD 0801 Spool Assembly (Universal)
RD 0803 Handle Knob
RD 0815 Line Roller Washer
RD 0816 Quick-Fire II Trigger
RD 0820 Oscillating Gear
RD 0826 Key Washer "A"
RD 0827 Drag Washer "H1"
RD 0865 Drag Shaft

PART # DESCRIPTION

RD 0940 Bail Trip Cam Screw
RD 0949 Trigger Screw
RD 1004 Bushing A
RD 1007 Lock Washer Retainer
RD 1008 Handle Lock Washer
RD 1014 Slider Retainer Screw
RD 1025 Handle Assembly
RD 1310 Line Roller Screw
RD 1319 Drag Knob Screw
RD 1377 Pressure Screw
RD 1442 Handle Screw Cap
RD 1490 Anti-Reverse Lever Screw
RD 1501 Main Shaft
RD 1502 Rotor
RD 1503 Bail Assembly
RD 1504 Bail Hold Cover Screw
RD 1505 Bail Spring Cover
RD 1506 Bail Spring Cover Screw
RD 1507 Bail Arm
RD 1508 Bail Spring Guide A

PART # DESCRIPTION

RD 1509 Bail Spring
RD 1510 Bail Spring Guide B
RD 1511 Lever Spring
RD 1512 Bail Trip Lever
RD 1513 Anti-Reverse Lock Out
RD 1514 Bushing Washer
RD 1515 Bushing
RD 1516 Anti-Reverse Pawl Screw
RD 1517 Anti-Reverse Pawl
RD 1518 Anti-Reverse Pawl Spring
RD 1519 Anti-Reverse Cam
RD 1520 Anti-Reverse Cam Spring
RD 1521 Body
RD 1522 Rotor Lock
RD 1523 Drive Gear
RD 1524 Drive Gear Washer
RD 1525 Side Cover
RD 1526 Drag Click
RD 1527 Anti-Reverse Lever
RD 1528 Drag Knob