

# SHIMANO®

## 1988 REPAIR MANUAL

Shimano American Corporation, One Shimano Dr.  
Irvine, CA 92718

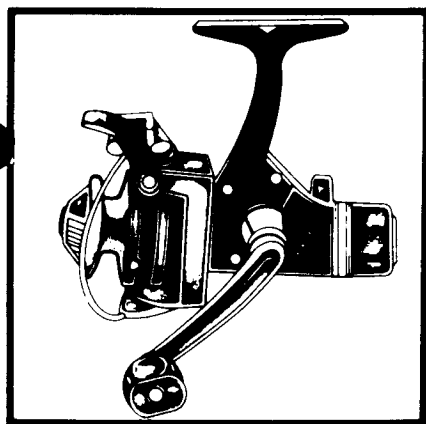

### EXPLODED PARTS VIEW

ULTRA LIGHT SPECIAL / GRAPHITE CONSTRUCTION

## FX-B100

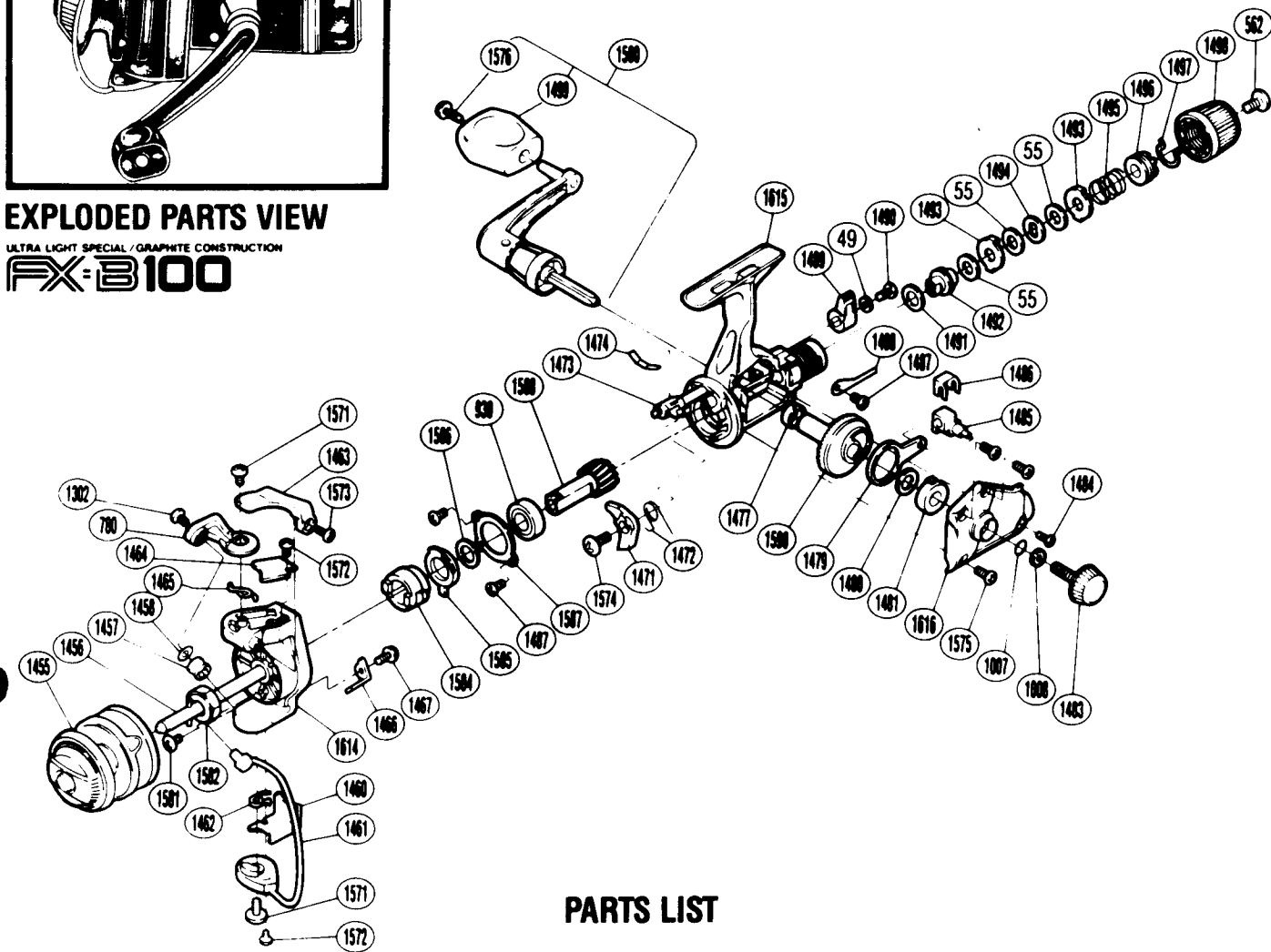

### PARTS LIST

PART #	DESCRIPTION
RD 0049	Lock Washer
RD 0055	Drag Washer "C(1)" (Black)
RD 0562	Drag Programmer Screw
RD 0780	Bail Arm
RD 0930	Ball Bearing
RD 1007	Lock Washer Retainer
RD 1008	Handle Lock Washer
RD 1302	Line Roller Screw
RD 1455	Spool Assembly
RD 1456	Main Shaft
RD 1457	Line Roller
RD 1458	Line Roller Washer
RD 1460	Bail Trip Cover
RD 1461	Bail Assembly
RD 1462	Lever Spring
RD 1463	Quick-Fire II Trigger
RD 1464	Bail Spring Cover
RD 1465	Bail Spring
RD 1466	Bail Trip Lever
RD 1467	Trip Lever Screw
RD 1471	Anti-Reverse Pawl
RD 1472	Anti-Reverse Pawl Spring
RD 1473	Anti-Reverse Cam
RD 1474	Anti-Reverse Cam Spring
RD 1477	Bushing B
RD 1479	Oscillating Arm
RD 1480	Drive Gear Washer
RD 1481	Bushing A
RD 1483	Handle Screw Cap
RD 1484	Side Cover Screw (B)
RD 1485	Oscillating Block
RD 1486	Oscillating Block Retainer
RD 1487	Drag Click Screw
RD 1488	Drag Click
RD 1489	Anti-Reverse Lever
RD 1490	Anti-Reverse Lever Screw
RD 1491	Drag Washer "H2"
RD 1492	Drag Shaft
RD 1493	Eared Washer "B"
RD 1494	Key Washer "A"
RD 1495	Drag Coil Spring
RD 1496	Pressure Screw
RD 1497	Hold Click Spring
RD 1498	Drag Knob
RD 1499	Handle Knob
RD 1500	Handle Assembly
RD 1571	Bail Trip Cam Screw
RD 1572	Bail Trip Cover Screw
RD 1573	Trigger Screw
RD 1574	Anti-Reverse Pawl Screw
RD 1575	Side Cover Screw (A)
RD 1576	Handle Knob Screw
RD 1581	Nut Lock Screw
RD 1582	Rotor Nut
RD 1584	Anti-Reverse Ratchet
RD 1585	Anti-Reverse Lock Out
RD 1586	Bushing Washer
RD 1587	Bearing Retainer
RD 1588	Pinion Gear
RD 1590	Drive Gear
RD 1614	Rotor
RD 1615	Body
RD 1616	Side Cover

Prices and specifications subject to change without notice.

OCTOBER, 1987