

SHIMANO®

1988 REPAIR MANUAL

Shimano American Corporation, One Shimano Dr.
Irvine, CA 92718

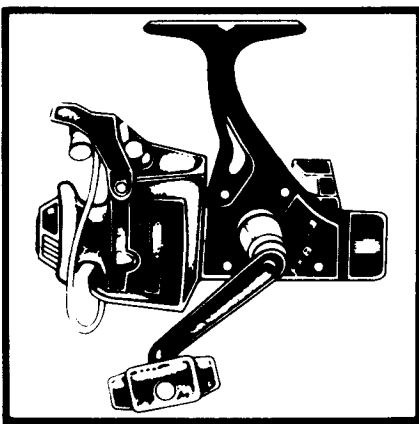

EXPLODED PARTS VIEW

MEDIUM SPECIAL GRAPHITE CONSTRUCTION
FX-B300

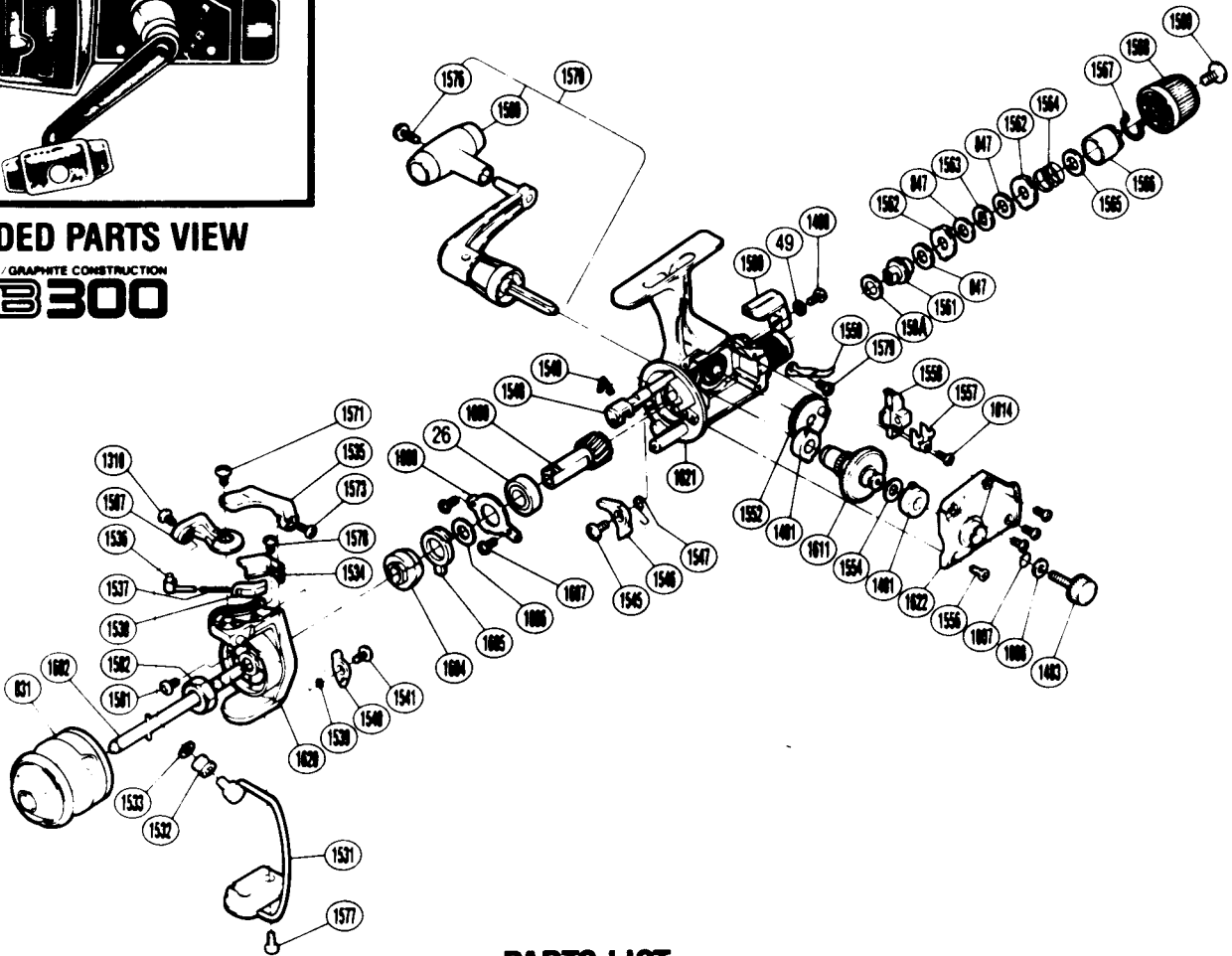

PARTS LIST

PART # DESCRIPTION

RD 0026	Ball Bearing
RD 0049	Lock Washer
RD 0150A	Drag Washer "C2" (White)
RD 0831	Spool Assembly (Universal)
RD 0847	Drag Washer "H1"
RD 1007	Lock Washer Retainer
RD 1008	Handle Lock Washer
RD 1014	Slider Retainer Screw
RD 1310	Line Roller Screw
RD 1481	Bushing A
RD 1483	Handle Screw Cap
RD 1490	Anti-Reverse Lever Screw
RD 1507	Bail Arm
RD 1531	Bail Assembly
RD 1532	Line Roller
RD 1533	Line Roller Washer
RD 1534	Bail Spring Cover
RD 1535	Quick-Fire II Trigger
RD 1536	Bail Spring Guide A
RD 1537	Bail Spring
RD 1538	Bail Spring Guide B
RD 1539	Lever Spring

PART # DESCRIPTION

RD 1540	Bail Trip Lever
RD 1541	Lever Screw
RD 1545	Anti-Reverse Pawl Screw
RD 1546	Anti-Reverse Pawl
RD 1547	Anti-Reverse Pawl Spring
RD 1548	Anti-Reverse Cam
RD 1549	Anti-Reverse Cam Spring
RD 1552	Oscillating Gear
RD 1554	Drive Gear Washer
RD 1556	Side Cover Screw
RD 1557	Oscillating Slider Retainer
RD 1558	Oscillating Slider
RD 1559	Drag Click
RD 1560	Anti-Reverse Lever
RD 1561	Drag Shaft
RD 1562	Eared Washer "B"
RD 1563	Key Washer "A"
RD 1564	Drag Coil Spring
RD 1565	Drag Spring Washer "A"
RD 1566	Pressure Screw
RD 1567	Hold Click Spring
RD 1568	Drag Knob

PART # DESCRIPTION

RD 1569	Handle Knob
RD 1570	Handle Assembly
RD 1571	Bail Trip Cam Screw
RD 1573	Trigger Screw
RD 1576	Handle Knob Screw
RD 1577	Bail Hold Cover Screw
RD 1578	Bail Spring Cover Screw
RD 1579	Drag Click Screw
RD 1580	Drag Knob Screw
RD 1581	Nut Lock Screw
RD 1582	Rotor Nut
RD 1602	Main Shaft
RD 1604	Anti-Reverse Ratchet
RD 1605	Anti-Reverse Lock Out
RD 1606	Bushing Washer
RD 1607	Bearing Retainer Screw
RD 1608	Bearing Retainer
RD 1609	Pinion Gear
RD 1611	Drive Gear
RD 1620	Rotor
RD 1621	Body
RD 1622	Side Cover