

# SHIMANO

## 1987 REPAIR MANUAL

Shimano American Corporation, One Shimano Dr.  
Irvine, CA 92718

### EXPLODED PARTS VIEW

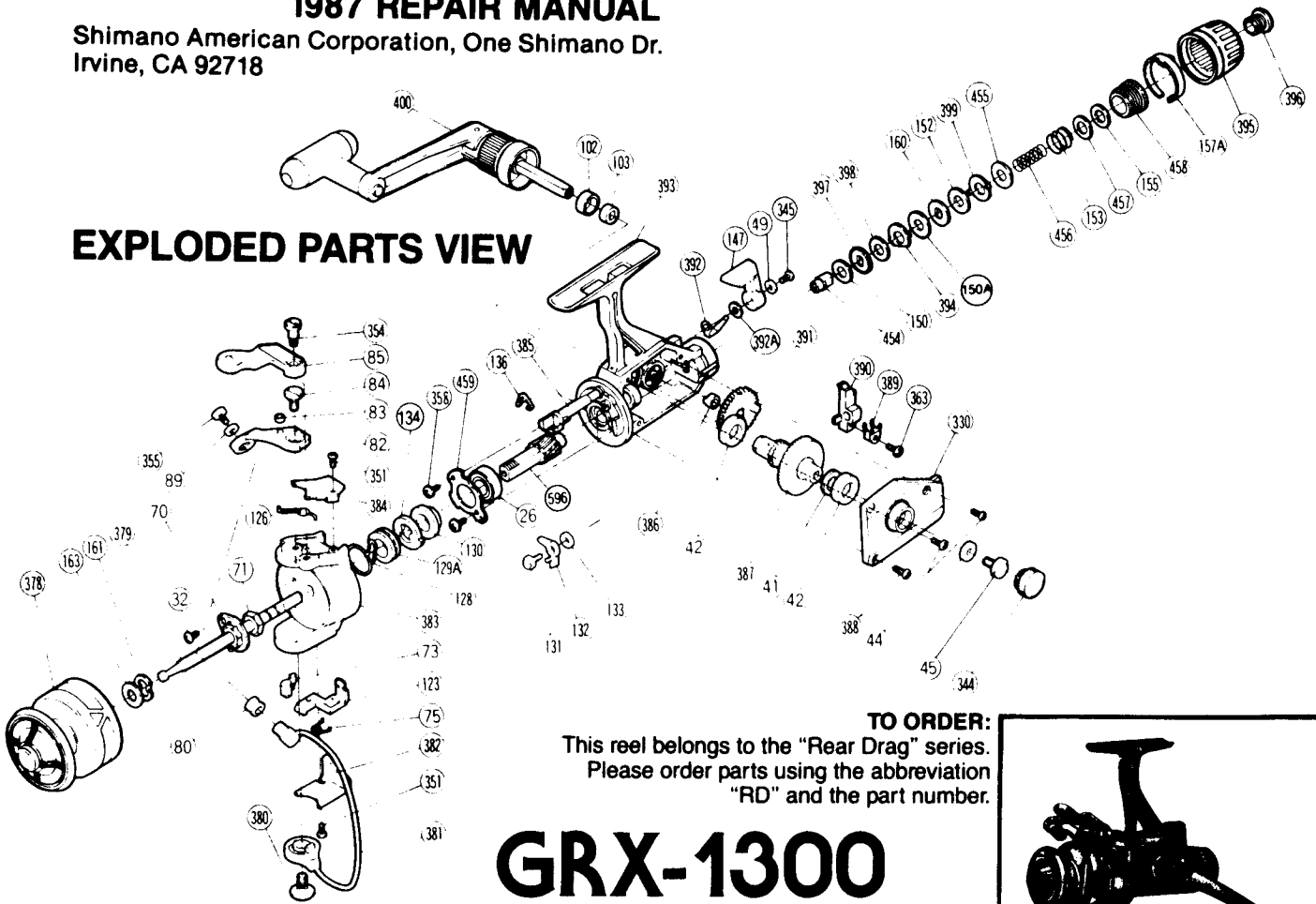

#### TO ORDER:

This reel belongs to the "Rear Drag" series.  
Please order parts using the abbreviation  
"RD" and the part number.

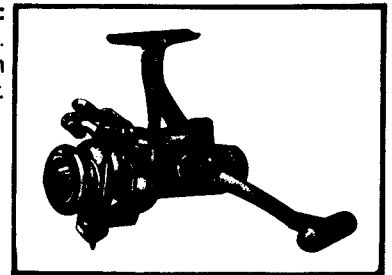

# GRX-1300

## PARTS LIST

### PART# DESCRIPTION

- 26. Ball Bearing
- 32. Multi Purpose Screw
- 41. Thrust Washer
- 42. Drive Gear Bushing
- 44. Handle Screw Lock Washer
- 45. Handle Screw
- 49. Lock Washer
- 70. Rotor Nut Lock Plate
- 71. Rotor Nut
- 73. Trip Plate Cam
- 75. Trip Plate Spring
- 80. Roller Line Guide
- 82. Bail Mount
- 83. Trigger Pin Roller
- 84. Bail Mount Screw
- 85. QuickFire Trigger
- 89. Guide Screw Lock Washer
- 102. Bushing Ring
- 103. Handle Shaft Bushing
- 123. Trip Plate
- 126. Bail Spring
- 128. Rotor Stop Spring
- 129A. Stop Spring Arbor
- 130. Ratchet Spacer
- 131. Anti Reverse Dog Screw
- 132. Anti Reverse Dog

### PART# DESCRIPTION

- 133. Anti Reverse Dog Spacer
- 134. Self Center Ratchet
- 136. Anti Reverse Shaft Spring
- 147. Anti Reverse Lever
- 150. Drag Washer A (Black)
- 150A. Drag Washer(White)
- 152. Drag Washer E
- 153. Drag Spring
- 155. Friction Washer
- 157A. Stop Ring
- 160. D Washer
- 161. Wave Washer
- 163. Spool Washer
- 330. Side Plate
- 344. Dust Cap
- 345. Anti Reverse Lever Screw
- 351. Cover Screw
- 354. Trigger Screw
- 355. Bail Wire Screw
- 358. Bearing Retainer Screw
- 363. Oscillation Guide Screw
- 378. Spool
- 379. Spool Shaft
- 380. Bail Screw
- 381. Bail Wire
- 382. Trip Plate Cover

### PART# DESCRIPTION

- 383. Rotor
- 384. Bail Spring Cover
- 385. Anti Reverse Shaft
- 386. Oscillation Gear Bushing
- 387. Drive Gear
- 388. Side Plate Screw
- 389. Oscillation Guide Lock
- 390. Oscillation Block
- 391. Oscillation Gear
- 392. Drag Knob Click Spring
- 392A. Guide Washer
- 393. Housing
- 394. Keyed Washer #2
- 395. Drag Adjusting Knob
- 396. Drag Screw
- 397. Ratchet Washer
- 398. Drag Washer C
- 399. Keyed Washer #1
- 400. Handle
- 454. Drag Shaft
- 455. Lock Washer
- 456. Lock Spring
- 457. Base Spring Washer
- 458. Spring Housing
- 459. Bearing Retainer
- 596. Pinion Gear(Originally135A)

Prices and specifications subject to change without notice

JUNE 1986