

# SHIMANO®

## 1987 REPAIR MANUAL

Shimano American Corporation, One Shimano Dr.  
Irvine, CA 92718

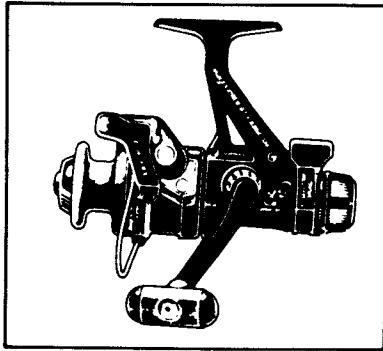

### TO ORDER:

This reel belongs to the "Rear Drag" series.  
Please order parts using the abbreviation  
"RD" and the part number.

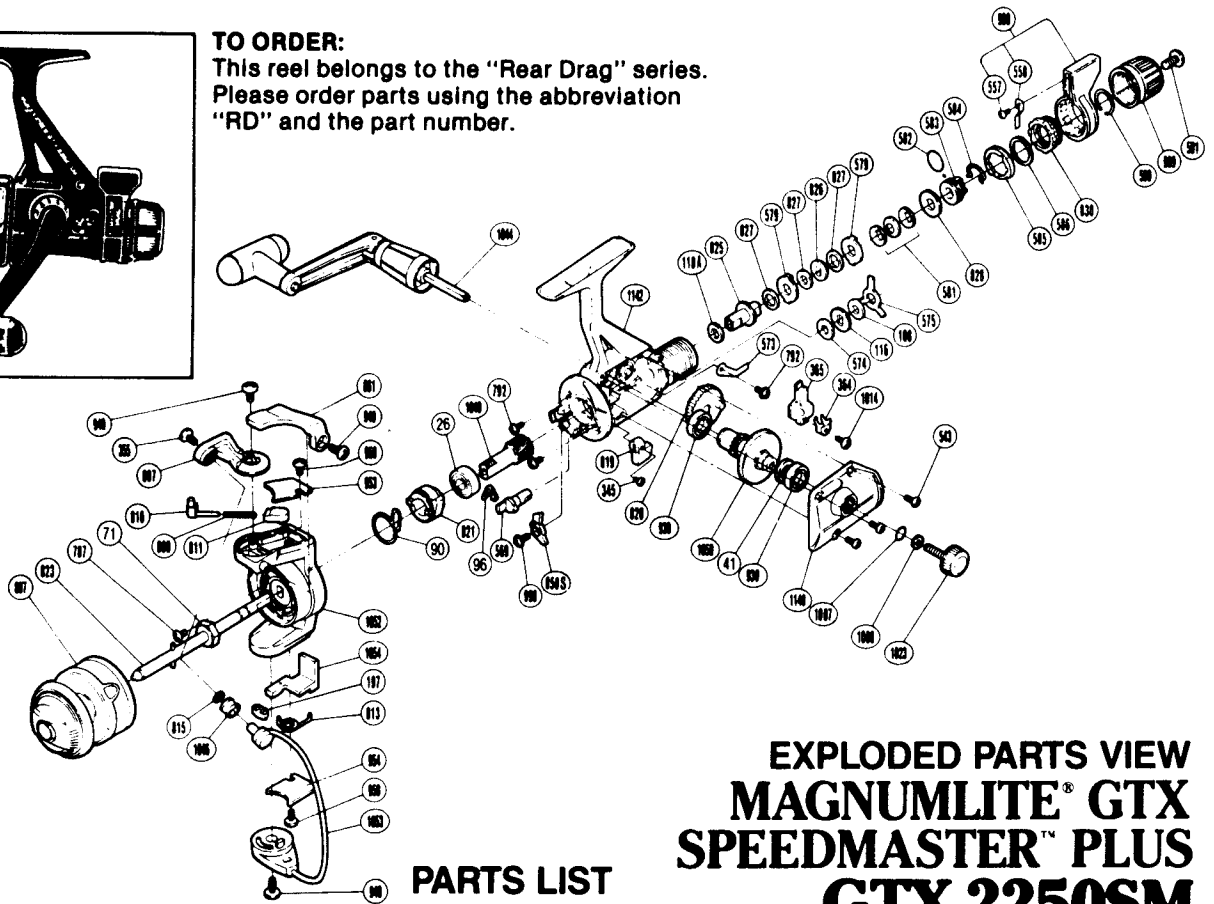

### PARTS LIST

## EXPLODED PARTS VIEW MAGNUMLITE® GTX SPEEDMASTER™ PLUS GTX 2250SM

#### PART # DESCRIPTION

- 26. Ball Bearing
- 41. Drive Gear Washer
- 71. Rotor Nut
- 90. Anti-Reverse Pawl Spring
- 96. Anti-Reverse Cam Spring
- 108. Drag Washer "C(1)"  
(Black)
- 110A. Drag Washer "D2" (White)
- 116. Click Gear
- 197. Bail Trip Slide Cam
- 345. Anti-Reverse Lever Screw
- 355. Line Roller Screw
- 364. Oscillating Slider  
Retainer
- 365. Oscillating Slider
- 543. Side Cover Screw (B)
- 557. Fightin' Lever Click Screw
- 558. Fightin' Lever Click
- 569. Anti-Reverse Cam
- 573. Drag Click
- 574. Drag Washer "C2" (White)
- 575. Eared Washer "BF"
- 579. Eared Washer "B"
- 581. Coned Disc Spring
- 582. "O" Ring

#### PART # DESCRIPTION

- 583. Pressure Screw
- 584. Hold Click Spring
- 585. Lever Click Gear
- 586. Fightin' Pressure Screw  
Washer
- 589. Lever Hold Spring
- 591. Drag Programmer Screw
- 787. Nut Lock Screw
- 792. Bearing Retainer Screw
- 807. Ball Arm
- 808. Ball Spring
- 810. Ball Spring Guide A
- 811. Ball Spring Guide B
- 813. Lever Spring
- 815. Line Roller Washer
- 819. Anti-Reverse Lever
- 820. Oscillating Gear
- 821. Anti-Reverse Ratchet
- 823. Main Shaft
- 825. Drag Shaft
- 826. Key Washer "A"
- 827. Drag Washer "H1"
- 828. Drag Spring Washer "A"
- 830. Fightin' Pressure Screw
- 850S. Anti-Reverse Pawl

#### PART # DESCRIPTION

- 861. Quick-Fire II Trigger
- 897. Spool Assembly  
(Universal)
- 930. Ball Bearing
- 940. Bail Trip Cam Screw
- 949. Trigger Screw
- 953. Bail Spring Cover
- 954. Bail Trip Cover
- 958. Bail Trip Cover Screw
- 989. Drag Programmer
- 990. Fightin' Drag Lever
- 998. Anti-Reverse Pawl Screw
- 1007. Lock Washer Retainer
- 1008. Handle Lock Washer
- 1014. Slider Retainer Screw
- 1023. Handle Screw Cap
- 1044. Handle Assembly
- 1046. Sic Ceramic Roller
- 1049. Pinion Gear
- 1050. Drive Gear
- 1052. Rotor
- 1053. Bail Assembly
- 1054. Bail Trip Lever
- 1140. Side Cover
- 1142. Body