

**EXPLODED PARTS VIEW**  
Magnumlite GT-X2200SQ  
FIGHTIN' DRAG II

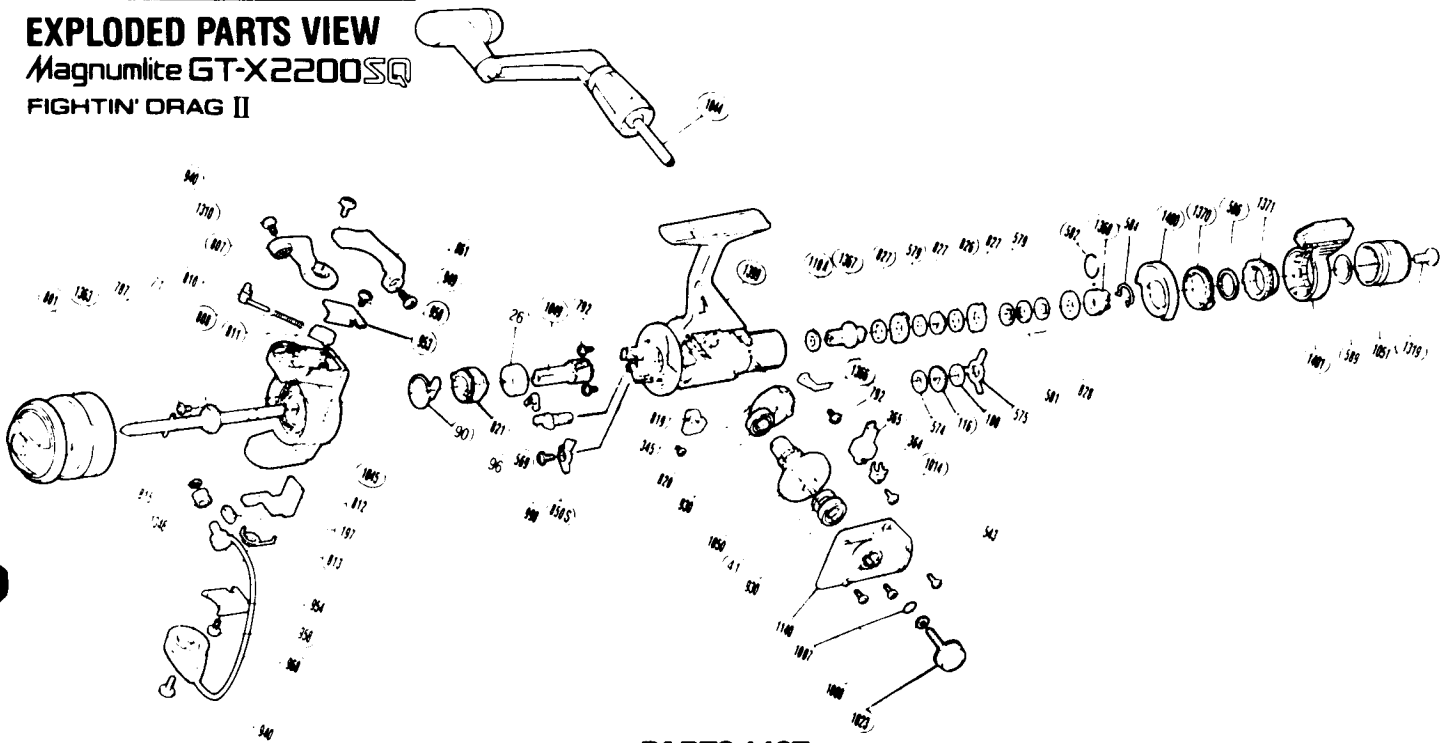

### PARTS LIST

#### PART # DESCRIPTION

RD 0026	Ball Bearing
RD 0041	Drive Gear Washer
RD 0071	Rotor Nut
RD 0090	Anti-Reverse Pawl Spring
RD 0096	Anti-Reverse Cam Spring
RD 0108	Drag Washer "C(1)" (Black)
RD 0110A	Drag Washer "D2" (White)
RD 0116	Click Gear
RD 0197	Bail Trip Slide Cam
RD 0345	Anti-Reverse Lever Screw
RD 0364	Oscillating Slider Retainer
RD 0365	Oscillating Slider
RD 0543	Side Cover Screw (B)
RD 0569	Anti-Reverse Cam
RD 0574	Drag Washer "C2" (White)
RD 0575	Eared Washer "BF"
RD 0579	Eared Washer "B"
RD 0581	Coned Disc Spring
RD 0582	"O" Ring
RD 0584	Hold Click Spring
RD 0586	Fightin' Pressure Screw Washer
RD 0589	Lever Hold Spring
RD 0787	Nut Lock Screw

#### PART # DESCRIPTION

RD 0792	Bearing Retainer Screw
RD 0801	Spool Assembly (Universal)
RD 0807	Bail Arm
RD 0808	Bail Spring
RD 0810	Bail Spring Guide A
RD 0811	Bail Spring Guide B
RD 0812	Bail Trip Lever
RD 0813	Lever Spring
RD 0815	Line Roller Washer
RD 0819	Anti-Reverse Lever (Black)
RD 0820	Oscillating Gear
RD 0821	Anti-Reverse Ratchet
RD 0826	Key Washer "A"
RD 0827	Drag Washer "H1"
RD 0828	Drag Spring Washer "A"
RD 0850S	Anti-Reverse Pawl
RD 0861	Quick-Fire II Trigger
RD 0930	Ball Bearing
RD 0940	Bail Trip Cam Screw
RD 0949	Trigger Screw
RD 0953	Bail Spring Cover
RD 0954	Bail Trip Cover
RD 0958	Bail Trip Cover Screw
RD 0968	Bail Assembly

#### PART # DESCRIPTION

RD 0998	Anti-Reverse Pawl Screw
RD 1007	Lock Washer Retainer
RD 1008	Handle Lock Washer
RD 1014	Slider Retainer Screw
RD 1023	Handle Screw Cap
RD 1044	Handle Assembly
RD 1045	Rotor
RD 1046	Sic Ceramic Roller
RD 1049	Pinion Gear
RD 1050	Drive Gear
RD 1051	Drag Knob
RD 1140	Side Cover
RD 1310	Line Roller Screw
RD 1319	Drag Knob Screw
RD 1363	Main Shaft
RD 1366	Drag Click
RD 1367	Drag Shaft
RD 1368	Pressure Screw
RD 1370	Lever Click Gear
RD 1371	Fightin' Pressure Screw
RD 1399	Body
RD 1400	Lever Quadrant
RD 1401	Fightin' Drag II Lever